

# 履 修 要 項

令和 3 年度

## Study Guideline

2021/2022

千葉大学大学院園芸学研究科

Graduate School of Horticulture  
Chiba University

## 2021年度(令和3年度)学年暦

## 2021/2022 Academic Calendar for the Graduate School of Horticulture

2021/2022 Academic Calendar for the Graduate School of Horticulture				
期		授 業 日 程 Class Schedule	行 事 予 定 Schedule of Events	備 考 Notes
前 期 ( 春 期 ( )	Spring Semester	<div>4月5日 (月) Apr. 5 (Mon.) 入学式・新入生ガイダンス Enrollment Ceremony in Spring Guidance for New Students</div> <div>4月8日 (木) Apr. 8 (Thu.) 第1ターム Term 1</div> <div>6月1日 (火) Jun. 1 (Tue.)</div> <div>6月2日 (水) Jun. 2 (Wed.) 第2ターム Term 2</div> <div>7月20日 (火) July. 20 (Tue.)</div> <div>9月28日 (火) 修了式 (9月修了) Sep. 28(Tue.) Graduation Ceremony (September Completion)</div>	<div>4月1日 (木) Apr. 1 (Thu.) 春季休業期間 Spring Vacation</div> <div>4月7日 (水) Apr. 7 (Wed.)</div> <div>4月1日 (木) Apr. 1 (Thu.) 履修登録・修正期間 (通年科目含む) Registration Period (Including Full Year Courses)</div> <div>4月21日 (水) Apr.21 (Wed.)</div> <div>5月26日 (水) May. 26 (Wed.) 履修登録期間・修正期間 Registration Period</div> <div>6月15日 (火) Jun. 15 (Tue.)</div> <div>7月26日 (月) Jul. 26 (Mon.) 第3ターム (夏季休業期間) Term 3 (Summer Vacation)</div> <div>9月30日 (木) Sep. 30 (Thu.)</div>	
	Fall Semester	<div>10月1日 (金) Oct. 1 (Fri.) 第4ターム Term 4</div> <div>11月22日 (月) Nov. 22 (Mon.)</div> <div>11月25日 (木) Nov. 25 (Thu.) 第5ターム Term 5</div> <div>1月24日 (月) Jan. 24 (Mon.)</div> <div>10月1日 (金) 入学式 Oct. 1 (Fri.) Enrollment Ceremony in Fall</div> <div>11月5日 (金) Nov. 5 (Fri.) 大学祭 University festival</div> <div>11月7日 (日) Nov. 7 (Sun.)</div> <div>3月25日 (金) 修了式 Mar. 25(Fri.) Graduation Ceremony</div>	<div>9月24日 (金) Sep. 24 (Fri.) 履修登録期間・修正期間 Registration Period</div> <div>10月14日 (木) Oct. 14 (Thu.)</div> <div>11月5日 (金) Nov. 5 (Fri.) 創立記念日 Foundation Day</div> <div>11月18日 (木) Nov. 18 (Thu.) 履修登録期間・修正期間 Registration Period</div> <div>12月8日 (水) Dec. 8 (Wed.)</div> <div>12月28日 (火) Dec. 28 (Tue.) 冬季休業期間 Winter Vacation</div> <div>1月4日 (火) Jan. 4 (Tue.)</div> <div>1月14日 (金) 臨時休業日 (大学入学共通テスト準備) Jan. 14 (Fri.) Special Holiday (Preparation for National Center Test for University Admissions)</div> <div>1月26日 (水) Jan. 26 (Wed.) 第6ターム (臨時休業期間) Term 6 (Extra Vacation)</div> <div>3月31日 (木) Mar. 31 (Thu.)</div>	

2021年度（令和3年度）授業カレンダー

2021/2022 Class Calendar for the Graduate School of Horticulture

前期 Spring Semester							
	日 Sun.	月 Mon.	火 Tue.	水 Wed.	木 Thu.	金 Fri.	土 Sat.
4 月 Apr.					1	2	3
	4	5	6	7	8	9	10
	11	12	13	14	15	16	17
	18	19	20	21	22	23	24
	25	26	27	28	29	30	
5 月 May.							1
	2	3	4	5	6	7(水)	8
	9	10	11	12	13	14	15
	16	17	18	19	20	21	22
	23	24	25	26	27	28	29
	30	31					
6 月 Jun.			1	2	3	4	5
	6	7	8	9	10	11	12
	13	14	15	16	17	18	19
	20	21	22	23	24	25	26
	27	28	29	30			
7 月 Jul.					1	2	3
	4	5	6	7	8	9	10
	11	12	13	14	15	16	17
	18	19	20	21	22	23	24
	25	26	27	28	29	30	31
8 月 Aug.	1	2	3	4	5	6	7
	8	9	10	11	12	13	14
	15	16	17	18	19	20	21
	22	23	24	25	26	27	28
	29	30	31				
9 月 Sep.				1	2	3	4
	5	6	7	8	9	10	11
	12	13	14	15	16	17	18
	19	20	21	22	23	24	25
	26	27	28	29	30		
T1		7	7	7	7	7	
T2		7	7	7	7	7	
T3	8～9月（集中講義、留学生受入れプログラム等） August , September (Intensive Course, International student program and so on)						

## 研究科長挨拶

## Message from the Dean



*Nobuhiro  
Matsuoka*

松岡延浩

本年度の履修要項（シラバス）を皆さんのお手元にお届け致します。本年度から備考欄に、実施方法（対面授業，オンデマンド型または同時双方向型のメディア授業等）と使用するシステム（Moodle, Google Classroom 等）が記入されました。これらはもちろん，COVID-19（新型コロナウイルス感染症）に対応した講義を行うためのものです。

昨年度は，カリキュラム決定後にCOVID-19の問題が発生したため，園芸学研究科も今までに経験したことのないカリキュラム運営の変更を迫られました。学生諸君も大きく戸惑ったことと思います。今年度は昨年度の反省を踏まえて，様々な講義方法の改善を試みています。不十分なところもあると思いますので，気づいたことがあれば遠慮なく教員あるいは学務係に伝えて下さい。学生・教職員一丸となってCOVID-19に立ち向かっていきたいと思っています。

昨年度，園芸学研究科は，園芸科学あるいはランドスケープ学全体を俯瞰する視点を持ち，国際社会で活躍できる専門職業人を育てることを目標として，「食」という視点から教育・研究を行う園芸科学コースと「緑」という視点から教育・研究を行うランドスケープ学コースの2コースに改組されました。しかし，自分の専門に特化するだけではなく，園芸学，食あるいは緑の科学を学修したというアイデンティティを身につけて欲しいという観点から，園芸学研究科共通の必修科目を作りました。

しかし，カリキュラムが変わっただけでは，上記の目標に近づくことはできません。さらに皆さんがより良い環境で学修できるように研究科教員も努力していきますが，皆さんも，積極性を持って講義等に参加し，カリキュラムをより有益なものとして下さい。

We will prepare you the course requirements (syllabus) for this year. From this year, the implementation method (face-to-face lessons, on-demand lessons or simultaneous interactive media lessons, etc.) and the system to be used (Moodle, Google Classroom, etc.) have been shown in the remarks column. Of course, these are for lectures towards COVID-19 (new coronavirus infection). Last year, a COVID-19 problem arose after the curriculum was decided, forcing the Graduate School of Horticulture to change its curriculum management, which had been never experienced before. I imagine the students were also very confused. This year, based on the reflection of last year, we are trying to improve various points in lecture methods. Please do not hesitate to tell the faculty member or the academic office staff if you notice something that may be insufficient. We would like to confront COVID-19 as a team of students and faculty members.

Last year, the Graduate School of Horticulture was reorganized of its education and research system from the perspective of horticultural science and landscape science with the goal of developing professionals who can play an active role in the international community with the both sciences. However, we created a compulsory subject in the Graduate School of Horticulture from the perspective of not only specializing in your own specialty but also acquiring the identity of having studied horticulture, food or green science.

However, getting close to that goal will not be possible by simply changing the curriculum. The graduate school teaching staff will also make efforts to enable you to study in a better environment, so please be active in your participation in lectures, etc., and make the curriculum even more beneficial.

# The Graduate School of Horticulture Policy for Conferment of Degrees

## **(Master's Program)**

In the master's program, building upon the foundations established as undergraduates, students are expected to acquire the knowledge and capabilities mentioned below.

### **<Course of Horticultural Science>**

#### **[Degree :Master of Agriculture]**

##### **“The spirit of freedom and independence”**

As highly skilled experts in Horticulture and Landscape Architecture, through flexible thinking skills and deep insights, individuals should be able to act autonomously regarding issues related to environmental horticulture in cooperation with stakeholders while firmly maintaining a sense of ethics in science.

##### **“Involvement in society from a global perspective”**

Individuals should acquire the ability to think and communicate flexibly from a global perspective to contribute to the sustainable development of both the global society and the local community.

##### **“Specialized knowledge, skills and abilities”**

Individuals should acquire deep, specific and wide knowledge in specialized fields on advanced genome information related to horticultural science and technological development on horticultural industry. Using both, they should be able to think flexibly and exercise deep insight in endeavoring to solve the issues in the horticultural industries.

##### **“Excellent problem-solving skills”**

Individuals should be able to solve problems related to horticultural science that require advanced knowledge and skills in experiments and research, by integrating and organizing related knowledge and abilities, as well as cooperating with others.

#### **[Degree : Master of Philosophy]**

##### **“The spirit of freedom and independence”**

As highly skilled experts related to "Horticulture and Landscape Architecture," based upon flexible thinking skills and deep insight, individuals should be able to act autonomously regarding issues related to environmental horticulture and cooperation with stakeholders while acquiring a sense of ethics in science.

##### **“Involvement in society from a global perspective”**

Individuals should acquire the ability to think and communicate flexibly from a global perspective to contribute to the sustainable development of both global society and the local community.

##### **“Specialized knowledge, skills and abilities”**

Individuals should acquire deep and specific, as well as broad, interdisciplinary knowledge in specialized fields on advanced genome information related to horticultural science and in technological developments in the horticulture industry. Using both, they should be able to think flexibly and exercise keen insights in endeavoring to solve issues in horticultural industries.

##### **“Excellent problem-solving skills”**

Individuals should be able to solve problems related to horticultural science that require advanced and interdisciplinary knowledge, by integrating and organizing related knowledge and abilities as well as cooperating with others.

## **<Course of Landscape>**

### **[Degree : Master of Landscape Architecture]**

#### **“The spirit of freedom and independence”**

As highly skilled experts in Horticulture and Landscape Architecture, through flexible thinking skills and deep insights, individuals should be able to act autonomously regarding issues related to environmental horticulture in cooperation with stakeholders while firmly maintaining a sense of ethics in science.

#### **“Involvement in society from a global perspective”**

Individuals should acquire the ability to think and communicate flexibly from a global perspective to contribute to the sustainable development of both global society and the local community.

#### **“Specialized knowledge, skills and abilities”**

Individuals should acquire interdisciplinary knowledge of the applications of environmental science, the humanities, and social science to landscape architecture, and apply these with an artistic sense. Using both aspects of creativity and knowledge, they should be able to solve environmental issues in regionally sensitive designs.

#### **“Excellent problem-solving skills”**

Individuals should be able to solve problems related to landscape architecture that require advanced knowledge and skills, by integrating and organizing related knowledge and abilities as well as cooperating with others.

### **[Degree : Master of Philosophy]**

#### **“The spirit of freedom and independence”**

As highly skilled experts related to “Horticulture and Landscape Architecture,” based upon flexible thinking skills and deep insight, individuals should be able to act autonomously regarding issues related to environmental horticulture and cooperation with stakeholders while acquiring a sense of ethics in science.

#### **“Involvement in society from a global perspective”**

Individuals should acquire the ability to think and communicate flexibly from a global perspective to contribute to the sustainable development of both the global society and the local community.

#### **“Specialized knowledge, skills and abilities”**

Individuals should acquire knowledge of environmental science and humanities and social science landscape architecture related to landscape architecture and have an artistic sense as well as interdisciplinary perspective. Using these, they should be able to design with a practical understanding in order to solve regional environmental issues.

#### **“Excellent problem-solving skills”**

Individuals should be able to solve problems related to landscape architecture that require advanced, interdisciplinary knowledge and skills, by integrating and organizing related knowledge and abilities as well as cooperating with others.

## **(Doctoral Program)**

In the doctoral program, building upon the intellectual foundations established up through the master's program, students are expected to acquire the knowledge and capabilities mentioned below.

### **<Course of Horticultural Science>**

#### **[Degree : Doctor of Philosophy(Agriculture)]**

##### **“The spirit of freedom and independence”**

Individuals should act autonomously in establishing their research theme and conducting independent research activities as researchers or university faculty members in horticultural science or leading as members of management in companies or administrative organizations involved with horticultural science, while simultaneously developing research science ethics with a sense of scientific responsibility towards society.

##### **“Involvement in society from a global perspective”**

Individuals should be able to establish their research theme, and conduct independent research and development through cooperation with people in societies inside and outside Japan, and to publish the results internationally and across disciplines. Moreover, individuals should acquire an understanding of the diverse cultures and histories which will provide a foundation for their future roles as higher educators and researchers, or as leaders of domestic and foreign institutions, to contribute to the sustainable development of both the global society and the local community.

##### **“Specialized knowledge, skills and abilities”**

Being erudite and richly creative in their research and development abilities related to horticulture science, individuals should be able to contribute to the field with new insights and values. Moreover, with their wide-ranging specialized knowledge and their ability to conduct research, they should be able to plan and manage advanced research and development projects.

##### **“Excellent problem-solving skills”**

Individuals, using their ability to discover issues in horticultural science, and their extensive learning and knowledge in specialized fields, should be able to cooperate and work together with others to develop new insights and values that support our knowledge-based society.

#### **[Degree : Doctor of Philosophy(Philosophy)]**

##### **“The spirit of freedom and independence”**

Individuals should act autonomously in the following. They should establish their research theme and conduct independent research activities as researchers or university faculty members in horticultural science or leading as members of management in companies or administrative organizations involved with horticultural science. They should simultaneously develop research science ethics, supervising and leading stakeholders with a sense of scientific responsibility towards society.

##### **“Involvement in society from a global perspective”**

Individuals should be able to establish their research theme, and conduct independent research and development through cooperation with people in societies inside and outside Japan, and to publish the results internationally and across disciplines. Moreover, individuals should acquire an understanding of the diverse cultures and histories which will provide a foundation for their future roles as higher educators and researchers, or as leaders of domestic and foreign institutions, to contribute to the sustainable development of both the global society and the local community.

##### **“Specialized knowledge, skills and abilities”**

Being erudite and richly creative in their interdisciplinary research and development abilities related to horticulture science, individuals should be able to contribute to the field with new insights and values. Moreover, with their wide-ranging specialized knowledge and their ability to conduct research, they should be able to plan and manage advanced research and development projects.

##### **“Excellent problem-solving skills”**

Individuals, using their ability to discover interdisciplinary issues in horticultural science, and their extensive learning and knowledge in specialized and related fields, should be able to cooperate and work together with others to develop new insights and values that support our knowledge-based society.

## **<Course of Landscape>**

### **[Degree : Doctor of Philosophy(Landscape Architecture)]**

#### **“The spirit of freedom and independence”**

Individuals should act autonomously in establishing their research theme and conducting independent research activities as researchers or university faculty members in landscape architecture or leading as members of management in companies or administrative organizations involved with horticultural science, while simultaneously developing research science ethics with a sense of scientific responsibility towards society.

#### **“Involvement in society from a global perspective”**

Individuals should be able to establish their research theme and development through cooperation with people in societies inside and outside Japan, and to publish the results internationally and across disciplines. Moreover, individuals should acquire an understanding of the diverse cultures and histories which will provide a foundation for their future roles as higher educators and researchers, or as leaders of domestic and foreign institutions, to contribute to the sustainable development of both the global society and the local community.

#### **“Specialized knowledge, skills and abilities”**

Being erudite and richly creative in their research and development abilities related to landscape architecture, individuals should be able to contribute to the field with new insights and values. Moreover, with their wide-ranging specialized knowledge and their ability to conduct research and design, they should be able to plan and manage advanced research and regional development projects.

#### **“Excellent problem-solving skills”**

Individuals, using their ability to discover issues in landscape architecture and their extensive learning and knowledge in specialized fields, should be able to cooperate and work together with others to develop new insights and values that support our knowledge-based society.

### **[Degree : Doctor of Philosophy(Philosophy)]**

#### **“The spirit of freedom and independence”**

Individuals should act autonomously in the following. They should establish their research theme and conduct independent research activities as researchers or university faculty members in landscape architecture or leading as members of management in companies or administrative organizations involved with horticultural science. They should simultaneously develop research science ethics, supervising and leading stakeholders with a sense of scientific responsibility towards society.

#### **“Involvement in society from a global perspective”**

Individuals should be able to establish their research theme and development through cooperation with people in societies inside and outside Japan, and to publish the results internationally and across disciplines. Moreover, individuals should acquire an understanding of the diverse cultures and histories which will provide a foundation for their future roles as higher educators and researchers, or as leaders of domestic and foreign institutions, to contribute to the sustainable development of both the global society and the local community.

#### **“Specialized knowledge, skills and abilities”**

Being erudite and richly creative in their interdisciplinary research and development abilities related to landscape architecture, individuals should be able to contribute to the field with new insights and values. Moreover, with their wide-ranging specialized knowledge and their ability to conduct research, they should be able to plan and manage advanced research and regional development projects.

#### **“Excellent problem-solving skills”**

Individuals, using their ability to discover interdisciplinary issues in landscape architecture and their extensive learning and knowledge in specialized and related fields, should be able to cooperate and work together with others to develop new insights and values that support our knowledge-based society.

## Degree Review Criteria for Graduate School of Horticulture (GSH) Master's Programs

Pertaining to a topic relating to environmental horticulture, a master's thesis must embody academic merit in terms of for example universality, strength of its arguments and ethical considerations, and must be composed logically in a manner expected for an academic paper.

A student who applies for a review of his/her thesis must in addition have fulfilled the following criteria by the completion of the review:

- 1 )The student can expect to earn the requisite number of GSH coursework credits needed to complete his/her master's program;
- 2 )The student must have absorbed the ability to independently develop an understanding of the background to and the significance of the research topic, and to conduct a systematic analysis that moves towards a resolution of the issues, as stipulated in the GSH's policy on the conferment of degrees.

In addition to the holding of an open meeting for the presentation of the thesis, the Department Meeting and the GSH Faculty Council will each need to judge if the thesis is worthy of a master's degree.

## Degree Review Criteria for Graduate School of Horticulture (GSH) Doctoral Programs (For a degree earned by completing a doctoral program)

Pertaining to a topic relating to environmental horticulture, a doctoral dissertation must embody academic merit in terms of a high level of for example originality, novelty, universality, the strength of its arguments and ethical considerations, and possess a high degree of completeness for having been composed logically in a manner expected for an academic paper.

A student who applies for a review of his/her dissertation must in addition have fulfilled the following criteria by the completion of the review:

- 1 )The student can expect to earn the requisite number of GSH coursework credits needed to complete his/her doctoral program; and
- 2 )The student can produce objective literature (in the form of publications), as stipulated in the GSH's policy on the conferment of degrees, that demonstrates the student's ability to conduct research activity independently as well as his/her learning that forms the basis for that ability.

The objective literature (publications) in 2) must fulfill the following requirements:

- ① A publication included in the dissertation has appeared, or has received definite approval to appear, as a general rule in at least two peer-reviewed academic journals;
- ② The student must be the primary author of the publication appearing in one of those two journals. Although this requirement does not apply to the publication(s) appearing in the other journal(s), the student will be required to have made a very considerable contribution to the paper(s) in question;
- ③ These publications must be published as a general rule while the student is enrolled in his/her doctoral program.

This number of publications is an essential requirement for a dissertation review. For that reason, for the purpose of a dissertation review an overall evaluation will be made of all relevant factors including the nature and content of the publications and the details of their authorship, and their connection to the dissertation. In addition the dissertation itself will be required to demonstrate a high level of completeness, as well as academic merit. In addition to the holding of an open meeting for the presentation of the dissertation, the Degree Review Committee, Department Meeting, and the GSH Faculty Council will each need to judge if the dissertation is worthy of the degree of doctor of philosophy.

## 目 次 Contents

2021 年度（令和 3 年度）学年暦

2021/2022 Academic Calendar for the Graduate School of Horticulture

2021 年度（令和 3 年度）授業カレンダー

2021/2022 Class Calendar for the Graduate School of Horticulture

研究科長挨拶

Message from the Dean

園芸学研究科学位授与の方針

The Graduate School of Horticulture Policy for Conferment of Degrees

園芸学研究科 コース・領域・教員の編成

Academic Staff

### 1. 園芸学研究科の教育研究の目標

Education and Research Objectives

園芸学研究科の教育理念 ..... 1

Guiding Education Principles

園芸学研究科の教育目標 ..... 1

Education Objectives

環境園芸学専攻の教育課程 ..... 1

Curriculum

コース内領域の教育研究目標 ..... 3

Education and Research Objectives for the Programs

教育研究指導体制 ..... 7

Academic Guidance and Counseling System

各授業科目のシラバスについて .....	7
Course Syllabuses	
2. 園芸学研究科履修要件等	
Completion Requirements, Etc.	
履修の心得 .....	9
Study Guide	
学位取得までの年次別手順 .....	25
Steps Toward Earning an Academic Degree	
博士前期課程の授業科目 .....	33
List of Courses (Master's program)	
博士後期課程の授業科目 .....	45
List of Courses (Doctoral program)	
指定推奨科目 .....	51
Recommended Courses	
大学院共通教育科目.....	53
Common Graduate Courses	
教育職員免許状及び免許教科に関する履修要件等 .....	57
Allowed Teaching Licenses and Study Requirements (for the Japanese)	
自然再生士補資格に関する履修要件.....	61
Requirements for the License of Nature Restoration Assistant Promoter	
3. 令和3年度授業時間割 .....	63
2021/2022 Class Timetable	

4. 園芸学研究科学位論文審査の手続き	
Procedures for Master's/Doctoral Defense	
学位（修士）論文及び研究成果の審査の手順と手続き .....	71
Steps and Procedures for Master's Defense	
学位（博士）論文審査の手順と手続き .....	81
Steps and Procedures for Doctoral Defense	
5. 各種手続き等について .....	101
Administrative Procedures	
6. 千葉大学大学院園芸学研究科規程 .....	107
Regulations for the Chiba University Graduate School of Horticulture	
千葉大学附属図書館松戸分館の案内 .....	119
Guide to the Matsudo Division of Chiba University Library	
所在地及び配置図 .....	125
Campus Map	

# 1 . Education and Research Objectives

## Guiding Education Principles

The Graduate School of Horticulture is the only specialized graduate school in Japan with a focus on horticulture and landscape, and conducts comprehensive education and research with one division in Environment and Horticulture. In addition, we will foster human resources with high problem-solving skills through a transdisciplinary approach that takes advantage of the comprehensiveness of Chiba University.

The traditional principle of the education and research in Graduate School of Horticulture is "Theory and Practice", which emphasizes theoretical considerations of problems and values practice based on the scientific approaches. Practice also refers to the verification of research results in the social and industrial realities, but the reflections obtained there will be the next scientific opportunity. Through such processes, we train professionals with advanced knowledge and creativity.

The other principle is the development of internationality. In modern society, information and transportation have no borders. Science is evolving day and night as people around the world compete. On the other hand, social problems occur in specific areas and sites, and it is important to scoop them up and work on solving them. Think globally, act locally! We develop human resources who can consider so deeply and act lightly.

## Education Objectives

At Chiba University, we have acquired the following four abilities: "The spirit of freedom and independence", "Involvement in society on a global perspective", "Specialized knowledge, technology and skills", and "Excellent problem-solving skills". Education is being conducted as a goal. The details are summarized in the policy for conferment of degrees for each program, so be sure to refer to them.

## Curriculum

The Division of Environment and Horticulture consists of two programs, Horticulture Science and Landscape Science, each of which has a curriculum consisting of basic courses, required compulsory courses, required elective courses, and optional elective courses.

Master's program is programed as follows.

Basic courses are required for subjects related to environment and horticulture, professional ethics, and researcher ethics that are related to "The spirit of freedom and independence". In addition, academic writing subjects and international relations courses related to "Involvement in society on a global perspective" will be selected as required courses, and students will acquire specialized and applied communication skills through seminars and research.

Specialized courses are provided to acquire "Specialized knowledge, technology and skills". Of these, the required compulsory courses are the common specialized courses of the program. Show a sketch of professionalism, understand the academic and social positioning of research and learning, and acquire their own research development, science and technology management abilities, and policy-making abilities.

Required compulsory courses are at the core of the specialized curriculum and provide lectures on advanced knowledge and the latest methodologies in each specialty. We will set the minimum number of required credits for each course to ensure a balanced learning.

Specialized electives are set from two perspectives. The first perspective is to provide advanced students from other universities and students who want to expand into new areas at graduate schools the expertise they need to base their elective courses. The second perspective is to broaden your area of specialization and to select a wide range of courses to gain the knowledge and abilities to discover and solve problems from a broad perspective.

Seminars and studios are set up as subjects for fostering "Excellent problem-solving skills", and students acquire inquiring skills through graduate research.

Doctoral program is programed as follows

Basic courses are environmental horticulture technology management and environmental horticulture

entrepreneur training courses related to “The spirit of freedom and independence”. In order to foster human resources who can conduct autonomous research and development and transmit their results internationally and interdisciplinarily, seminar-type courses related to international academic development or management are set as common courses.

Regarding specialized courses, you are able to voluntarily take a wide range of subjects required for research development.

In order to develop the problem-solving skills, we will secure sufficient research time, provide opportunities for joint research through industry-academia-government seminars and provide appropriate guidance individually through graduate seminars.

## **(1) Course of Horticultural Science**

Graduate studies of Horticultural Science offer four programs: i.e. Horticultural Plant Production and Breeding, Environmental Science for Bioproduction, Applied Biological Chemistry, and Food and Resource Economics, leading to Master’s and Doctoral degrees. The Master’s Program provides essential education and various research opportunities in the areas of biological production, bioresource management, and economics. On the basis of the Master’s program, the Doctoral Program offers interdisciplinary subjects, training to meet international standards, and education for scientific ethics. These programs build up expertise of a candidate not only in the research and development of bioresources, and food economy but also in the practical skills to achieve internationally with high ethical standards.

## **(2) Course of Landscape**

Aiming at the reconstruction of ecological space and sustainable society, the Course of Landscape provides the integrated academic program: both of design of the aesthetical environment and the sciences of ecological system. Students learn wide range knowledge through design to science, while they challenge their own research or creation in each academic division. The course produces the high-profession of design, management, healthcare in landscape field as well as the qualified researcher in the ecological science.

## **Education and Research Objectives for the Programs**

### **1. Course of Horticultural Science**

#### **(1) Horticultural Plant Production and Breeding Program**

This program offers advanced knowledge and skills for plant cultivation and management as well as breeding and genetic engineering techniques of not only horticultural crops but also medical and functional food plants. This program also offers education and research on breeding program and strategy that meet social needs as well as plant cultivation techniques with environmentally sustainable manners for the horticultural plant production. Development of highly skilled engineers and researchers with global view, wide perspective and creativity is also aimed in this program through acquiring practice-based skills and knowledge on areas that overlap the boundaries between related programs.

#### **(2) Environmental Science for Bioproduction Program**

This program offers education and research on systematic theory on physical, biological and chemical environmental factors affecting bioresource production such as climate, soils, cultivation facilities and fields for the production of plants; the behavior and cyclings of the bioproducts and substances used in those environments; physiology, ecology, pathology and utilization of cultivated plants; and the insects and microorganisms that inhabit those environments. Through these educational programs, we aim to foster engineers and researchers with enough background of physical, biological and chemical aspects of environmental science, who have the technical capabilities and applied skills to create and control suitable production environments.

### **(3) Applied Biological Chemistry Program**

For the purpose of achieving effective applications of bioresources using animals, plants and microorganisms, students analyze the functions, substances of cell constituents and metabolites of these living organisms using methods in biochemistry and molecular biology. Students also study basic scientific principles and theories of applied technology relating to subjects including related genes, functional proteins such as enzymes both inside and outside cells, functional carbohydrates, and functional lipids. This program fosters professionals who will be able to contribute to solutions for the problems currently facing humanity in areas such as food production, natural resources, and environmental issues.

### **(4) Food and Resource Economics Program**

Based on natural sciences, the course trains the students in analytical tools of social sciences. The targets of the training involve a broader view of the entire systems of food chains, interdisciplinary expertise, and leadership to promote policy makings. Managing a variety of resources in rural societies, conserving the environment, and sustainable developments under the globalized economy are essential, also. The course brings up human resources to solve the related problems proactively.

## **2. Course of Landscape**

### **(1) Landscape Planning Program**

Focusing on cities, rural communities and natural areas, students interpret the contradictions that occur between the daily lives of people in those areas and the spaces and natural environments that support those lives. Students also investigate both the direction of their development as well as the plans, systems and methods for realizing the comfortable and ecological living environment. The spaces principally examined range from urban spaces such as town precincts and pedestrian walkways to wilderness areas such as national parks, mountains and forests. Spaces also include residential places such as small towns and villages and rural spaces such as farming communities.

### **(2) Landscape Design Program**

Students undertake research on open spaces ranging from private gardens to urban-scale spaces from the perspectives of history, community and culture in order to deepen their examination of the design of open spaces as environmental facilities. Specifically, students analyze and interpret the structure of spaces, including historical gardens in Japan and overseas, gardens in private homes, public parks, and open spaces in residential areas. Students also research landscape systems and policy theories. Based on this research students investigate the planning, design methods and cultural context of those particular open spaces that modern communities regard as useful.

### **(3) Landscape Management Program**

This educational research program deals with fundamental theories, applied technologies, and policies for appropriately managing different kinds of green spaces: planting sites, historical gardens, community gardens, urban parks, natural green spaces, and the local environment in which they exist.

The program aims to develop a sustainable community and local environment to regenerate the environment and reduce environmental load, based on the multiple roles of green spaces.

By educating the students and through research activities, we aim to contribute to resolving various social issues such as rebuilding the relationship between people and nature, understanding and appropriating local culture and traditions, cultivating communities, creating lively towns, reducing and preventing disasters, and adapting to population decline.

#### **(4) Landscape System Science Program**

Based on analyses of landscape environments from earth science and ecological perspectives and by studying modeling of those systems, students forecast and evaluate changes to landscaped environments caused by environmental changes such as global warming and urbanization, regional development, and increases in specific biopopulations. Students also investigate and develop techniques for forming sustainable systems appropriate for regional human and ecological environments.

#### **(5) Landscape Resource Science Program**

Based on research from biological and ecological perspectives of the animals, plants, soils and water that constitute terrestrial and marine landscaped environments, students study the multiscale synchronic structures, diatonic changes and functional relationships within those environments and investigate and develop skills for using, preserving and recycling landscaped environment resources in specific contexts such as urban beautification and waste land beautification, natural environment assessments, nature remediation, and habitat management.

#### **(6) Environment and Human Health Sciences Program**

The issues taken up by this program relate to well-being and health-related issues such as creating better relationships between people and the environment, raising people's QOL (Quality of Life), mitigating their stress and enabling mental calm, for healthy people alike and not just for those requiring care for an illness or injury. This program's perspectives encompass open spaces and horticulture, medicine, pharmacology, well-being and education, and its education and research extend to: the therapeutic, physical and emotional welfare uses of plants in areas such as horticultural therapies and aromatherapy; the use of elements in nature to beautify medical and welfare facilities; plants as medicinal resources; plant- and environment-based culture; environmental education; and education on and the dissemination of agricultural and environment-related fields.

#### **Academic Guidance and Counseling System**

Academic guidance and counselling at the Graduate School of Horticulture is conducted by the student's main academic advisor and one or more co-academic advisors. Students will hold periodic discussions with their academic advisors on their study plans and the state of their progress, and the academic advisors will report the content of those discussions to the dean of the Graduate School.

#### **Course Syllabuses**

Course syllabuses are available online via the Syllabus link on Chiba University's website or via the Graduate School's website. Syllabuses can also be accessed through the Course Registration site. In addition to course dates, times, faculty members and outlines, syllabuses also contain course plans, content, goals and objectives; methods and criteria for student evaluation; and faculty contact details and appointment times.

## 2 . Completion Requirements, Etc.

### Study Guide

#### Introduction

This Study Guide explains procedures that students enrolled in a graduate program most follow in order to take courses and earn an academic degree.

The Graduate School is managed by a faculty council and various committees comprising faculty members; administrative procedures are handled by the Faculty of Horticulture Academic Affairs Group. Should you experience any changes in your personal status, or, should you have any questions or concerns regarding your studies, including career guidance, please do not hesitate to contact and discuss them with your academic advisors.

### 1 . Divisions and Courses

The Graduate School of Horticulture offers Master's and Doctoral Programs through the following division, which comprises two courses and ten programs (encompassing 23 fields)

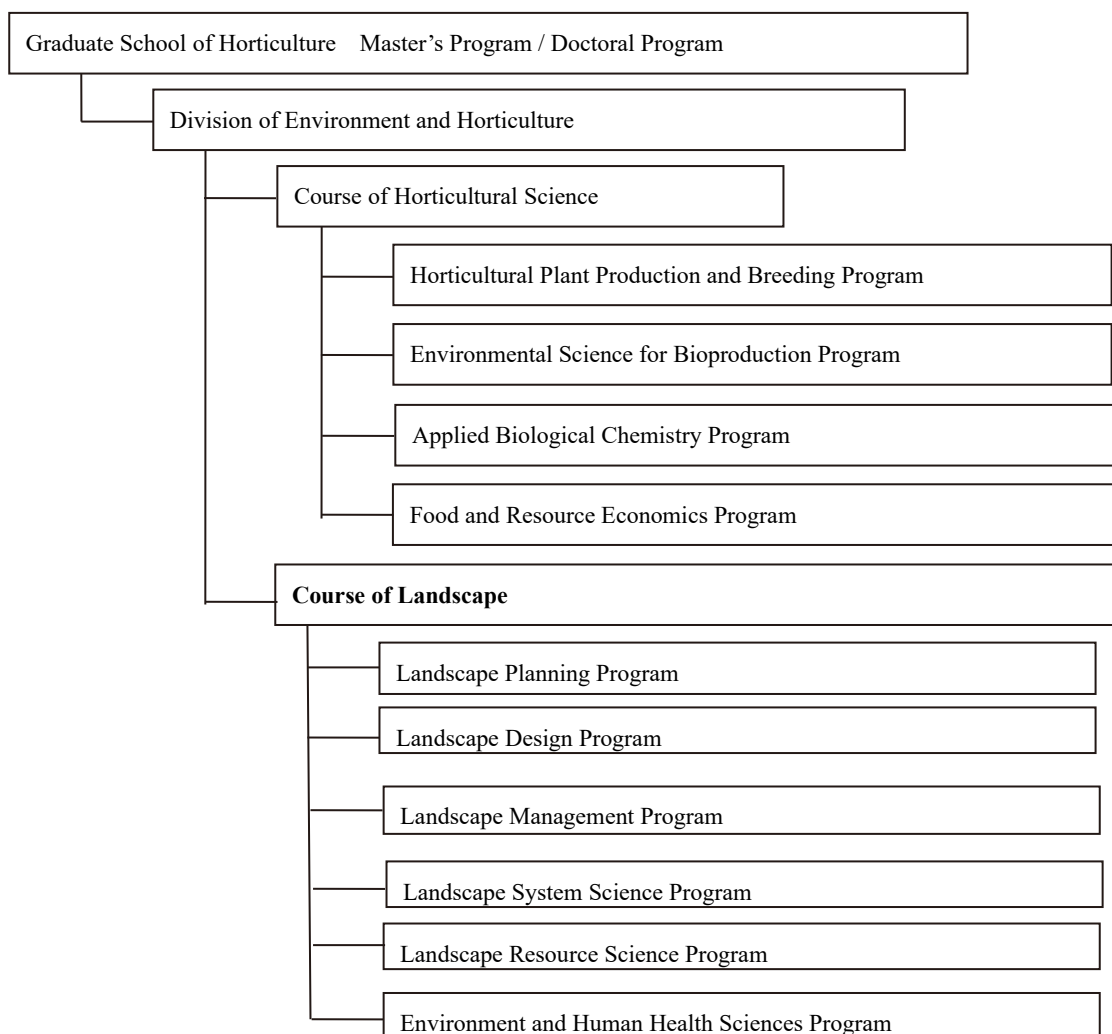

In addition to earning a master's or doctoral degree on a regular program by following the rules for taking courses described below and earning the prescribed credits, the Graduate School also offers master's and doctoral degrees through special programs: an International Horticulture & Business Program (Course of Horticultural Science in Master's Program); an International Program in Environment and Horticulture (Special Doctoral Program for International Students); Program: and a Plant Environment Designing Program.

The International Horticulture & Business Program, in addition to conferring a master's degree upon students completing their course of study, can also confer the qualification of "Horticulture Business Expert" upon students completing a Master's Program; students can choose which qualification(s) they wish to earn after enrolling on the program. Students wishing to enroll on this program should read 2. Rules for Taking Courses, sections 1) ~ 6) for the regular program as well as section 7) Rules for Taking Courses on the Business Program before consulting their academic advisors and the program organizer.

International students wishing to enroll on the International Program in Environment and Horticulture (English Program) should read 2. Rules for Taking Courses, sections 1) ~ 6) for the regular program as well as sections 8) before consulting their academic advisors and the faculty in charge of this program.

International students wishing to enroll on the Plant Environment Designing Program should read 2. Rules for taking Courses, sections 1) ~ 6) for the regular program as well as section 10) before consulting their academic advisors and the faculty in charge of this program.

## 2. Rules for Taking Courses

### 1) Outline of the Rules for Taking Courses

- To complete their studies at the Graduate School of Horticulture, all students must study abroad at least once during their enrollment and earn credits for their study abroad. In addition to giving a research presentation at an academic meeting or conference abroad, students will engage in a range of activities abroad that will contribute to their own research such as visiting laboratories of overseas universities and visiting foreign companies (in such cases, students are not required to earn credits). This part of the program comes under "Study Abroad." Therefore, please check with the Academic Affairs Office about the necessary application procedures.
- To complete a Master's Program, you need to earn a total of certain or more credits. In completion, you must submit and defend a master's thesis (depending on the course, this could involve producing something, etc.). If you want to get Master of "Philosophy" degree, please take 4 or more credits of other Graduate School's related fields or another course in Graduate School of Horticulture.

### Completion Requirements for a Master's Program

#### <Course of Horticulture Science>

No. of Credits Required for Completion	Course Categories		Course Name	No. of Credits
30	Basic Course	Compulsory (10)	Environment and Horticulture	2
			Scientific Approaches and Ethics for Researchers	2
			Graduate Research I	6
	Specialized Course	Compulsory (10)	Genetic resource utilization	2
			Horticulture Genomics	2
			Advanced Technology on Horticulture	2
			Graduate Seminar I	4
	Basic Course and Specialized Course	Compulsory elective (6~)	-----	(6~)
		Elective	※ 1	※ 1

※ 1 : Except for Elective Courses of Horticultural Science program, you may earn up to 4 Elective credits for

taking 【Compulsory elective courses of Landscape program,】 , 【Common Graduate Courses】 , 【Recommended Courses】 . (Landscape program's **Compulsory, Elective courses are not allowed.**)

You need to get 20 Compulsory credits (10 in Basic Course, 10 in Specialized Course), 6 or more Compulsory elective credits in Basic Course and Specialized Course, total 30 or more credits. Except for Elective Courses of Horticultural Science program, you may earn up to 4 Elective credits for taking 【Compulsory elective courses of Landscape program,】 , 【Common Graduate Courses】 , 【Recommended Courses】 .

#### <Course of Landscape>

No. of Credits Required for Completion	Course Categories		Course Name	No. of Credits
3 4	Basic Course	Compulsory ( 1 0 )	Environment and Horticulture	2
			Scientific Approaches and Ethics for Researchers	2
			Graduate Research I	6
	Specialized Course	Compulsory ( 1 2 )	Theory of Landscape Ecosystems	2
			Theory of Landscape Architecture	2
			Landscape Project Studio - A	4
			Landscape Project Studio - B	4
	Basic Course and Specialized Course	Compulsory elective ( 8 ~ )	-----	( 8 以上 )
		Elective	※ 2	※ 2

※ 2 : Except for elective courses of Landscape program, you may earn up to 4 Elective credits for taking 【Compulsory elective courses of Horticultural Science program,】 , 【Common Graduate Courses】 , 【Recommended Courses】 . (Horticultural Science program's **Compulsory, Elective courses are not allowed.**)

You need to get 22 Compulsory credits (10 in Basic Course, 12 in Specialized Course), 8 or more Compulsory elective credits in Basic Course and Specialized Course, total 34 or more credits. Except for Elective Courses of Landscape program, you may earn up to 4 Elective credits for taking 【Compulsory elective courses of Horticultural Science program,】 , 【Common Graduate Courses】 , 【Recommended Courses】 .

- To complete a Doctoral Program, you need to earn a total of 14 or more credits comprising compulsory courses for graduate seminar II (2 credits) and graduate research II (4 credits); and 8 or more credits for specialized courses, basic courses, Common Graduate Courses, Recommended Courses (※3) . In completion, you must submit and defend a dissertation. If you take the same class you took in Master's Program while you are in Doctoral Program, those class credits will not count as credits required for completion. If you would like to get Doctor of Philosophy (Philosophy) degree, you need to take 2 or more credits of other Graduate School's related fields or another course in Graduate School of Horticulture, and take 1 or more credits of Management • Economy course.  
(※ 3 : You may earn up to each 2 credits for taking 【Common Graduate Courses】 , 【Recommended Courses】 .)

### Completion Requirements for a Doctoral Program

No. of Credits Required for Completion	Course Categories	Course name	No. of Credits
1 4	Compulsory	Graduate Seminar II	2
		Graduate Research II	4
	Elective	※ 4	( 8 ~ ) ※ 4

※ 4 : Except for elective courses, you may earn up to each 2 credits for taking 【Common Graduate Courses】 , 【Recommended Courses】 .

Specialized courses refer to specialized courses designated by the Graduate School. These include specialized courses corresponding to students' course of study. Basic courses refer to courses designated by the Graduate School as being common to all courses.

The Graduate School offers courses on a term system. In other words, students take courses for each term. Term notation may not be consistent throughout the syllabus, outlines of course syllabuses and timetables due to the system, so please exercise due caution.

### 2) Recommended Courses

Of courses offered by the Graduate Schools of Science and Engineering, Nursing, Master's Program students may, with their academic advisor's approval, earn up to 4 credits for taking courses designated by each course; likewise, Doctoral Program students may earn up to 2 credits for such courses. These recommended courses can be counted as elective course corresponding to their course of study course. Please refer to P52~54 for the List of Recommended Courses.

### 3) Common Graduate Courses

Of courses offered by the other Graduate Schools, Master's Program students may earn up to 4 credits for taking courses designated as Elective courses; likewise, Doctoral Program students may earn up to 2 credits. Please refer to P54 for the List of Common Courses.

#### 【Remarks:Common Graduate Education】

In modern society, technology is advancing rapidly, and globalism is also developing remarkably. At the same time, several problems such as economic disparity or environmental problems that go beyond the country or region that one belongs in, are taking place all around the world. In order to become a researcher or sophisticated professional who can be adaptable and precisely grasp this kind of diversified and complex society, just deepening your expertise in your own field is not enough. By acquiring practical knowledge that combines expertise beyond one's field and new literacy, people can be able to ambitiously overcome issues, objectify the problem, and newly create values.

To aid in cultivating such abilities, our university has made full use of the features of a university that has 11 graduate schools and introduced an inter-graduate school education. Regardless of the graduate school that you belong to, various cross-graduate school type of courses that you can take up have been made available. For more information, refer to 『千葉大学大学院共通教育授業案内』, and take the courses that you're interested in.

※About 2) Recommended Courses 3) Common Graduate Courses, please check rules carefully before register these courses.

#### 4) Preparation of Study Plans and Course Registration

Upon enrollment, when determining which courses to study, Year 1 students should take the following procedures to formulate a plan that will enable them to earn the required number of credits (with regard to the course categories explained in section 1) within their period of enrollment (2 years for a Master's Program and 3 years for a Doctoral Program (regular program))

- (1) After attending Guidance, each student should consult their academic advisors and formulate a plan of which courses they are going to take and how many credits they will earn for each. For each academic year of study, prepare a "Study Plan", get their academic advisor's signature/seal of approval, and submit it to the Academic Affairs Group by April 30th (October 31st for October enrollment).
- (2) The first class for each course is held within a week of the starting date for classes each semester. Please refer to the Study Guideline and Syllabus for the location of the class. Please attend the first class before deciding whether you will take that course. Schedules, etc. for intensive courses are announced by posting notices.
- (3) Online Course Registration (available at the Japanese website)

Course registration is completed online from a computer. The procedure for online registration is largely in line with the following. Please ensure you register for courses within the designated period.

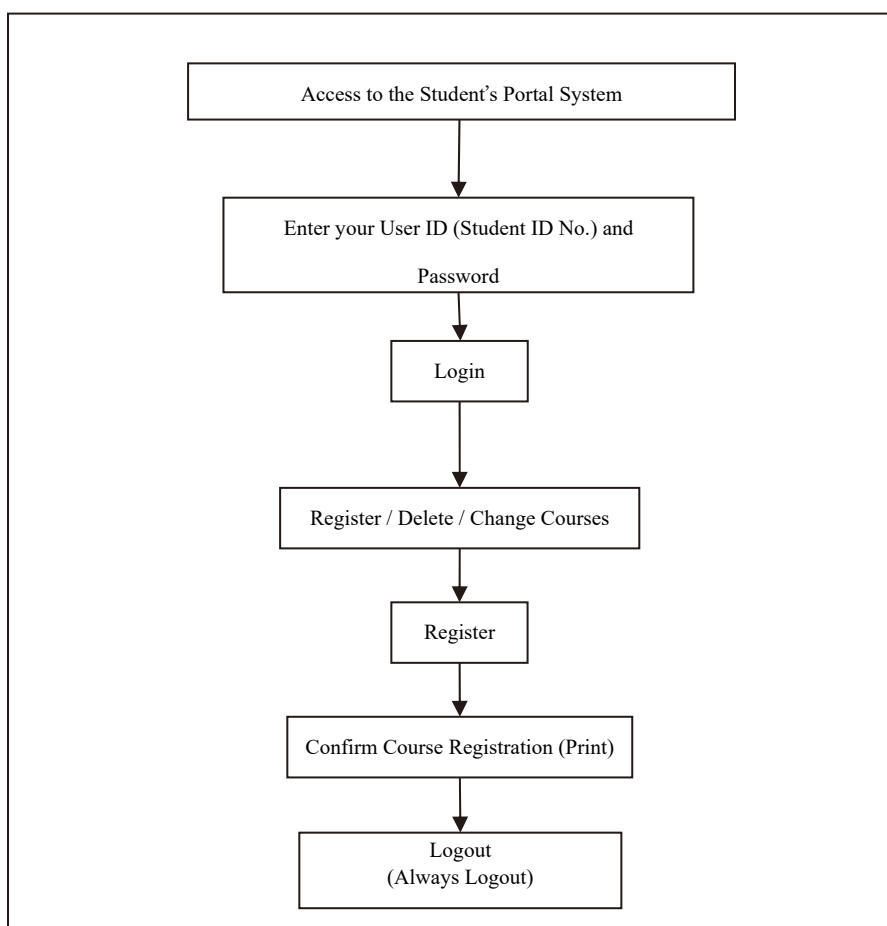

#### 5) Notification of Academic Grades, and Inquiries

Academic grades are processed for each semester, and please refer to the Student Portal at the end of September for the spring semester and at the end of March for the fall semester. Students with questions about their academic grades may request an investigation at the Faculty of Horticulture Student Affairs Unit within 15 days after the start of the new semester.

Should an error be confirmed as a result of investigation, procedures to correct the error can be taken. Moreover, students wishing to have their grades reconfirmed may ask the Academic Affairs Group to do so within 15 days after receiving a reply to their initial inquiry.

Students are evaluated based on a combination of their attendance, reports, term-end tests, and more. The specific method of evaluation for each course is described in the syllabus posted on the Chiba University website at <http://www.chiba-u.jp/campus-life/syllabus/index.html>

Student performance is evaluated according to a 5-level system: “S” (90-100 points), “A” (80-89 points), “B” (70-79 points), “C” (60-69 points), and “Fail” (59 points or less).

## 6) Completion

Depending on the course taken, master’s and doctoral degrees are conferred upon students completing their studies at the Graduate School. The standard period of enrollment for a Master’s Program is 2 years, and cannot exceed 4 years. The standard period of enrollment for a Doctoral Program is 3 years, and cannot exceed 6 years. Students wishing to use the programs for “Early Completion” or “Long-term Student” should consult with their academic advisors.

Students other than those wishing to study under special education programs, please go to p.26.

Special education programs offered by the Graduate School of Horticulture are explained in sections 7) ~ 10).

## 7) International Horticulture and Business Program (Course of Horticultural Science in Master's Program)

Centered on Practice on Horticultural Consulting where students engage in problem solving at work sites in the field, the International Horticulture and Business Program aims to train students as horticultural business experts with excellent problem-solving skills and expertise in responding at the front line of the industry by providing them with a sound balance of advanced horticultural techniques, a sense of strategic management, and an international perspective of the industry.

In addition to an academic degree, the Graduate School of Horticulture confers the qualification of Horticulture and Business Expert upon students who have completed a Master's Programs respectively and get all courses required by this program.

Students wishing to participate in this program should consult with the program organizer and submit the prescribed application to the Academic Affairs Group within one month of enrollment.

### < International Horticulture & Business Program (Course of Horticultural Science in Master's Program)>

- In order to qualify as an Horticulture and Business Expert, students must earn a total of 34 or more credits by selecting and successfully completing Specialized Course(Compulsory) and Basic Course(Compulsory) (20 credits), Practice on Horticultural Consulting (4 credits), Horticulture Industry (2 credits), Entrepreneurship for Horticulture (2 credits), Basic Course and Specialized Course (6 credits),.

### Requirements for Qualifying as "Horticulture and Business Expert"

#### <Course of Horticultural Science>

No. of Credits Required for Completion	Course Categories	No. of Credits
34	Specialized Course(Compulsory), Basic Course(Compulsory)	20
	Practice on Horticultural Consulting	4
	Horticulture Industry	2
	Entrepreneurship for Horticulture	2
	Basic Course and Specialized Course	6

### <Steps from Participation in the Program through Qualification (Master's Program)>

- Guidance (scheduled for Mid-April for April enrollment): An outline of the Business Program is explained to all newly enrolled students.
- Provisional Application: Students wishing to receive a more detailed explanation of the Business Program should e-mail a provisional application to the program organizer abovementioned Guidance.
- Explanatory Meeting: Please attend the explanatory meeting for the Business Program which is held within one month of enrollment to get a more detailed explanation.
- Individual Interviews: Individual interviews with the program organizer begin after the explanatory meeting and study plans are formulated.
- Course Registration: Course registration is completed online. Application Submission: Please submit an application for the Business Program to the program organizer.
- Progress Interviews: You can consult the program organizer as and when you need to discuss how your studies are going, etc. and receive advice as needed.
- Certification Review/Qualification: Once you have achieved a certain grade or above for all courses required for completion of the Business Program and your thesis review has been completed, you will be subjected to a certification review. If you pass this, you will qualify as Horticulture and Business expert.

## 8) International Program in Environment and Horticulture (English Program) (Master's and Doctoral Program)

The International Program was established to provide an educational environment for international students from overseas, and, at the same time to promote joint education with partner schools and institutions overseas. This program targets international students enrolling in Doctoral Programs in October and can be completed by attending lectures, etc. that are conducted in English.

Students wishing to enroll in this program should consult with academic advisors and write it on Study plan. The Completion Requirements in this program is the same as p.12~.

Master's course students enrolling in this program can take "Special Japanese for Horticultural Science A" and "Special Japanese for Horticultural Science B" as compulsory elective course in Basic Course, and replace as follows.

	Before the replacement	After the replacement
Basic courses	Environment and Horticulture	International Environmental Horticulture
	Scientific Approaches and Ethics for Researchers	Project Management
Course of Horticultural Science	Advanced Technology on Horticulture	Horticultural Crop Management
	Horticulture Genomics	Advanced Lectures on Applied Biological Science
	Genetic resource utilization	Genetic Science Communication

Doctoral course students enrolling in this program can take "Special Japanese for Horticultural Science C" and "Special Japanese for Horticultural Science D" as compulsory elective course in Basic Course.

Please direct any questions to Academic Affairs Group.

## 9) Double Degree Program

The Graduate School of Horticulture launched a Double Degree Program for students enrolling with Tsinghua University School of Architecture (China), Graduate School of Bogor Agricultural University (Indonesia), Shanghai Jiao Tong University School of Agriculture and Biology(China), University of Padjadjaran(Indonesia), Mahidol University Faculty of Science (Thailand), College of Horticulture of Nanjing Agricultural University(China), The School of Agro-Industry, Mae Fah Luang University(Thailand), and School of Landscape Architecture of Beijing Forestry University(China) for Master's Program, and Mahidol University Faculty of Science (Thailand), Shanghai Jiao Tong University School of Agriculture and Biology (China) for Doctoral Programs in the Horticultural Plant Production and Breeding Program.

This program, based on the agreement of partner universities overseas, enables students to earn degrees from both Chiba University and the partner university. Chiba University students participating in this program are required to spend a period of one or more years at the partner university, and to earn sufficient credits to fulfill completion requirements.

Since the application periods differ with the universities, students wishing to participate in this program should contact Academic Affairs Group promptly.

## 10) Plant Environment Designing Program

The Environmental Science and Landscape Course in the Graduate School of Horticulture, the Design Science Course in the Graduate School of Science and Engineering, the Center for Environment, Health and Field Sciences, collaborate to foster personnel who can manage projects on plant environment. In addition to the basic and specialized courses of a regular program, students can take special practical courses such as International Internship and Project Seminar/Practice.

Students wishing to enroll in this program should consult with Student affairs Unit. Students who complete this program and take 10 credits in addition to Completion Requirements, can receive a certificate of completion on this course. If you need it, please consult with Students Affairs Unit by the end of January or June when the year of graduation.

## Steps Toward Earning an Academic Degree

Reference page numbers and the names of all necessary forms included in this booklet have been noted. They can also be downloaded from the Graduate School of Horticulture website. (<http://www.h.chiba-u.jp>)

### (1) For April Enrollment on a Master's Program

Year	Semester	Details	Submission Deadline	Submitted To	Ref. Page
Year 1	Spring Semester	①Decision on Academic Advisors	At enrollment		
		②Submission of Personal Information	At Guidance		
		③Submission of Study Plan	End of Apr.	Academic Affairs Desk Academic Advisor	
		④Registration for Spring Semester/Full Year Courses	Designated day	Register online	
	Fall Semester	⑤Registration for Fall Semester Courses	Designated day	Register online	
		⑥Submission of Research Progress Report	End of Mar.	Academic Advisor →Student Affairs Unit	
Year 2	Spring Semester	⑦Registration for Spring Semester/Full Year Courses	Designated day	Register online	
	Fall Semester	⑧Registration for Fall Semester Courses	Designated day	Register online	
		⑨[Submission of Documents for Review of Thesis] • Application for Review of Thesis (Form 1)	Designated day in early Nov.	Student Affairs Unit	p.80
		⑩Thesis Review • Thesis (for Review)	Early Jan.~Early Feb.	Review Committee	
		⑪Master's Thesis Presentation Meeting	Mid-Feb.		
		⑫Submission of Thesis	Early Mar.	Academic Advisor	
		⑬Conferment Ceremony	End of Mar.		

## (2) For October Enrollment on a Master's Program

Year	Semester	Details	Submission Deadline	Submitted To	Ref. Page
Year 1	Fall Semester	①Decision on Academic Advisors	At enrollment		
		②Submission of Personal Information	At enrollment Procedure		
		③Submission of Study Plan	End of Oct.	Academic Affairs Desk Academic Advisor	
		④Registration for Fall Semester Courses	Designated day	Register online	
	Spring Semester	⑤Registration for Spring Semester/Full Year Courses	Designated day	Register online	
		⑥Submission of Research Progress Report	End of Sep.	Academic Advisor →Studeent Affairs Unit	
Year 2	Fall Semester	⑦Registration for Fall Semester Courses	Designated day	Register online	
	Spring Semester	⑧Registration for Spring Semester Courses	Designated day	Register online	
		⑨[Submission of Documents for Review of Thesis] • Application for Review of Thesis (Form 1)	Designated day in early May	Studeent Affairs Unit	p.80
		⑩Thesis Review • Thesis (for Review)	Late Jun. ~ Late Jul.	Review Committee	
		⑪Master's Thesis Presentation Meeting	Late Jul. ~ Early Aug.		
		⑫Submission of Thesis	Late Aug.	Academic Advisor	
		⑬Conferment Ceremony	End of Sep.		

## (3) For April Enrollment on a Doctoral Program

Year	Semester	Details	Submission Deadline	Submitted To	Ref. Page
Year 1	Spring Semester	①Decision on Academic Advisors	At enrollment		
		②Submission of Personal Information	At Guidance		
		③Submission of Study Plan	End of Apr.	Academic Affairs Desk Academic Advisor	
		④Registration for Spring Semester/Full Year Courses	Designated day	Register online	
	Fall Semester	⑤Registration for Fall Semester Courses	Designated day	Register online	
		⑥Submission of Research Progress Report	End of Mar.	Academic Advisor →Student Affairs Unit	
Year 2	Spring Semester	⑦Registration for Spring Semester/Full Year Courses	Designated day	Register online	
	Fall Semester	⑧Registration for Fall Semester Courses	Designated day	Register online	
		⑨Submission of Research Progress Report	End of Mar.	Academic Advisor →Student Affairs Unit	
Year 3	Spring Semester	⑩Registration for Spring Semester/Full Year Courses	Designated day	Register online	
	Fall Semester	⑪Registration for Fall Semester Courses	Designated day	Register online	
		⑫[Submission of Documents for Preliminary Thesis Review] • Application for a Thesis Review 1 Copy (Preliminary Form 1) • Thesis (for Preliminary Review) 1+4 Copies (Form 2) • List of Papers (for Preliminary Review) 1+4 Copies (Form 3) • Summary of Thesis Contents 1+4 Copies • Reference Papers and Publications 1+4 Copies	Designated day in Late Oct.	1 Copy to Student Affairs Unit (Others to Academic Advisor)	p.95~ p.98
		⑬[Documents for Submission for a Thesis Review] • Application for a Thesis Review 1 Copy (Form 1) • Thesis 1+4 Copies for Reviews • List of Papers 1+4 Copies (Form 2) • Summary of Thesis Contents 1+4 Copies (Form 3) • Curriculum Vitae 1+4 Copies (Form 4) • Reference Papers and Publications 1+4 Copies • Letters of Consent (Form 5)	Designated day in early Jan.	1 Copy to Student Affairs Unit (Others to Academic Advisor)	p.96~ p.100
		⑭Submission of Final Thesis (CD-R) (1 Copies) Confirmation of Internet Publication of Doctoral Dissertation (1 Copies)	Late Feb.	Student Affairs Unit	
		⑮Decision on Completion of Studies	Early Mar.		
		⑯Conferment Ceremony	End of Mar.		

## (4) For October Enrollment on a Doctoral Program

Year	Semester	Details	Submission Deadline	Submitted To	Ref. Page
Year 1	Fall Semester	①Decision on Academic Advisors	At enrollment		
		②Submission of Personal Information	At enrollment procedure	Student Affairs Unit	
		③Submission of Study Plan	End of Oct.	Student Affairs Unit Academic Advisor	
		④Registration for Fall Semester Courses	Designated day	Register online	
	Spring Semester	⑤Registration for Spring Semester/Full Year Courses	Designated day	Register online	
		⑥Submission of Research Progress Report	End of Sep.	Academic Advisor →Student Affairs Unit	
Year 2	Fall Semester	⑦Registration for Fall Semester Courses	Designated day	Register online	
	Spring Semester	⑧Registration for Spring Semester/Full Year Courses	Designated day	Register online	
		⑨Submission of Research Progress Report	End of Sep.	Academic Advisor →Student Affairs Unit	
Year 3	Fall Semester	⑩Registration for Fall Semester Courses	Designated day	Register online	
	Spring Semester	⑪Registration for Spring Semester Courses	Designated day	Register online	
		⑫[Submission of Documents for Preliminary Thesis Review] • Application for a Thesis Review 1 Copy (Preliminary Form 1) • Thesis (for Preliminary Review) 1 + 4 Copies (Form 2) • List of Papers (for Preliminary Review) 1 + 4 Copies (Form 3) • Summary of Thesis Contents 1 + 4 Copies • Reference Papers and Publications 1 + 4 Copies	Designated day in late Apr.	1 Copy to Student Affairs Unit (Others to Academic Advisor)	p.95~ p.98
		⑬[Documents for Submission for a Thesis Review] • Application for a Thesis Review 1 Copy (Form 1) • Thesis 1 + 4 Copies for Reviews • List of Papers 1 + 4 Copies (Form 2) • Summary of Thesis Contents 1 + 4 Copies (Form 3) • Curriculum Vitae 1 + 4 Copies (Form 4) • Reference Papers and Publications 1 + 4 Copies • Letters of Consent (Form 5)	Designated day in late Jun.	1 Copy to Student Affairs Unit (Others to Academic Advisor)	p.96~ p.100
		⑭Submission of Final Thesis (CD-R) (1 Copies) Confirmation of Internet Publication of Doctoral Dissertation (1 Copies)	Late Aug.	Student Affairs Unit	
		⑮Decision on Completion of Studies	Late Aug.		
		⑯Conferment Ceremony	End of Sep.		

## List of Courses (Master's program)

Course of study	Category	Course	Teacher's Specialized License	Year of program	Credits		Mode			Language ◎English ○English by request	Instructor	Term	Day	Period	Day 2	Period 2	Course code	Remarks
					Compulsory	Elective	Lecture	Seminar	Practice									
Horticultural Science	Compulsory	Genetic resource utilization	●	1	2	●				○	Igawa・Nakamura・Soma・Yoshida	T1-2	Fri	2			HA556	
		Horticulture Genomics	●	1	2	●				○	Kikuchi・Saito・Kokubun・Nakamura・Sassa・Nomura・Amachi・Usami・Sonoda・Soma・Hanaoka・Shimada・Hirai・Naito (Kikuchi)	T1-2	Fri	1			HA557	
		Advanced Technology on Horticulture	●	1	2	●				○	Goto・Matsuoka・Shiina・Ogawa・Hikosaka	T1-2	Mon	5			HA558	
		Graduate Seminar I		1~2	4		●			○	academic advisor	Full	Inetensive				HA601	register for the last year
Horticultural Science	Compulsory Elective	Practice on Horticultural Consulting	●	2	4	●					Ohkawa・Hisaeda (Ohkawa)	Full	Inetensive				HA532	
		Horticulture Industry	●	1	2	●					Sakurai・Watanabe・Tsukagoshi・Jokan・Ohkawa	T2	Mon	2	Thur	2	HA533	
		Advanced Lecture on Agricultural Meteorology and Environmental Studies	●	1	2	●				○	Matsuoka・Goto・Hikosaka	T4-5	Thur	4			HA534	
		Holistic Interactions in Biosphere	●	1・2	2	●				○	Sakamoto・Amachi・Usami・Choh・Nomura・Yashima・Hama	T5	Mon	3	Thur	3	HA535	
		Crop Risk Management	●	1・2	2	●				○	Ishikawa (Sakamoto)	T3	Inetensive				HA559	Biennial course in odd-numbered years
		Horticultural Plant Genome Breeding	●	1	2	●				○	Sassa・Kikuchi	T1-2	Tue	2			HA536	
		Food Science	●	1	2	●				○	Ogawa・Hirai・Shiina・Egashira	T2	Mon	2	Thur	2	HA537	
		Advanced Lectures on Applied Biological Chemistry A	●	1	2	●					Nishida・Amachi・Egashira・Hirai・Sonoda・Soma	T2	Mon	4	Fri	4	HA538	
		Advanced Lectures on Applied Biological Chemistry B	●	1	2	●					Hanaoka・Watanabe・Kagawa・Shimada	T3	Inetensive				HA539	Nishi-Chiba
		Advanced Lectures on Applied Biological Chemistry C	●	1	2	●					Kodama・Miyamoto(Kodama)・Dohi・Miyahara	T4	Inetensive				HA540	
		Uncultured Microbiology	●	1・2	1	●					Kamagata (Amachi)	T4	Inetensive				HA541	Biennial course in odd-numbered years
		Science for Phytochemical Technology	●	1・2	1	●					Kobori (Egashira)・Egashira	T4	Inetensive				HA542	Biennial course in even-numbered years
		Environmental Plant Physiology and Engineering	●	1・2	2	●					Kodama・Miyahara・Kinoshita(Kodama)・Kasahara(Kodama)	T4-T5	Inetensive				HA543	Biennial course in odd-numbered years
		Advanced Lecture on Biomolecule Observation	●	1	2	●					[Ura]・[Ito]・[Terasaki]	T1-2	Inetensive				HA544	
		Advanced Lecture on Molecular Biology	●	1	2	●					[Endo]・[Ogasawara]	Full	Inetensive				HA545	
		Advanced Lecture on Cell biology	●	1	2	●					[Matsuura]・[Ishikawa]・[Itakura]	T4-5	Inetensive				HA546	
		Issues on Agricultural and Development Policy	●	1	2	●				○	Kobayashi・Fujiie・Sugino (Kobayashi)	T1	Inetensive				HA547	
		Statistics for Economics	●	1	2	●				○	Kurihara・Maruyama	T3	Inetensive				HA548	
		Horticultural Crop Management		1	2	●				◎	Ogawa	T4-5	Tue	4			HA549	
		Advanced Lectures on Applied Biological Science		1	2	●				◎	Nishida・Watanabe・Kodama・Egashira・Amachi・Miyamoto(Kodama)・Dohi・Hanaoka・Hirai・Sonoda・Soma・Miyahara・Kagawa・Shimada	T5	Inetensive				HA550	
		Genetic Science Communication		1	2	●				◎	Yano・Sato(Yano)	T4-5	Inetensive				HA551	
		Protected Horticulture Seminar and Practice I		1	2	●	●	●		◎	Takagaki・Tsukagoshi	T4-5	Inetensive				HA552	
		Protected Horticulture Seminar and Practice II		1	2	●	●	●		◎	Takagaki・Tsukagoshi	T4-5	Inetensive				HA553	
		Protected Horticulture Seminar and Practice III		1	2	●	●	●		◎	Takagaki・Tsukagoshi	Full	Inetensive				HA554	
		Protected Horticulture Seminar and Practice IV		1	2	●	●	●		◎	Takagaki・Tsukagoshi	Full	Inetensive				HA555	

※Language used in the class ◎English ○English by request

Course of study	Category	Course	Teacher's Specialized License		Year of program	Credits		Mode		Language	Instructor	Term	Day	Period	Day 2	Period 2	Course code	Remarks
			Science	Agriculture		Compulsory	Elective	Lecture	Seminar	Practice								
Horticultural Science	Elective	Technology Management of Environmental Horticulture		●	1	2	●				Sakurai・Ishida・Fujii (Ishida)	Full	Inetensive				HA501	
		Entrepreneurship for Horticulture			1	2	●				Raku etc (Nomura)	T1-2	Wed	3			HA502	
		Seminar for Multidisciplinary Industrial Sciences			2	2	●				Miyauchi (Amachi)・Takagi (Amachi)	Full	Inetensive				HA503	
		Advanced Soil Microbiology			1・2	2	●				Sakamoto	T1	Tue	2	Fri	2	HA504	
		Advanced Lecture on Plant Molecular Biology			1	2	●				Nakamura	T4	Mon	1	Thur	1	HA505	
		Advanced Agri-Food Engineering			1	2	●				Shina・Ogawa	T2	Tue	1	Fri	1	HA506	
		Advanced Lecture on Flowering Control			1	2	●				Miyoshi	T1	Tue	2	Fri	2	HA507	
		Advanced Lecture on Environemntal Control for Plant			1	2	●			○	Goto・Hikosaka	T2	Tue	2	Fri	2	HA508	
		Advanced Plant Pathology			1	2	●				Shishido	T1	Mon	2	Thur	2	HA509	
		Advanced Lecture on Applied Entomology			1	2	●				Nomura	T5	Tue	2	Fri	2	HA510	
		Advanced Micrometeorology			1	2	●				Matsuoka	T4	Mon	2	Thur	2	HA511	
		Advanced Biochemical Plant Pathology			1	2	●				Usami	T4	Mon	1	Thur	1	HA512	
		Advanced Lecture on Deciduous Fruit Tree Cultivation			1	2	●				Ohara	T2	Tue	1	Fri	1	HA513	
		Advanced Lecture on Crop Sciences			1	2	●				Isoda	T2	Tue	2	Fri	2	HA514	
		Advanced Lecture on Fertilizer Science			1	1	●				Yashima	T4-6	Insentive				HA515	
		Advanced Lecture on Fruit Vegetable Cultivation			1	2	●				Jokan	T2	Mon	1	Thur	1	HA516	
		Fundamentals of Engineering			1	2	●				Ogawa	T5	Tue	1	Fri	1	HA517	
		Advanced Lecture on Cultivar Groups of Ornamental Crops			1	2	●			○	Kokubun	T5	Mon	1	Thur	1	HA518	
		Advanced Lecture on Evergreen Fruit Tree Cultivation			1	2	●				Ohara	T4	Mon	2	Thur	2	HA519	
		Advanced Lecture on Leaf and Roor Vegetable Cultivation			1	2	●				Jyokan	T5	Tue	1	Fri	1	HA520	
		Advanced Lecture on Soilless Culture			1	2	●				Tsukagoshi	T5	Tue	2	Fri	2	HA521	
		Advanced Nutritional Chemistry			1	2	●				Egashira・Hirai	T1	Mon	2	Thur	2	HA522	
		Advanced Biotechnology of Agroresources			1	2	●				Sonoda	T1	Tue	2	Fri	2	HA523	
		Advanced Biotechnology			1	2	●				Kodama・Shimada	T1	Tue	1	Fri	1	HA524	
		Advanced Bioorganic Chemistry			1	2	●			○	Nishida	T2	Mon	1	Thur	1	HA525	
		Advanced Environmental Microbiology			1	2	●				Amachi	T2	Mon	2	Thur	2	HA526	
		Advanced Econometrics			1	2	●				Kurihara	T2	Fri	4	Fri	5	HA527	
		Advanced Food Industrial Organization			1	2	●				Ishida	T5	Tue	3	Fri	3	HA528	
		Advanced Rural Development Economics			1	2	●				Eri Kato (Kurihara)	T3	Inetensive				HA529	
		Advanced Food Marketing			1	2	●				Sakurai	T5	Tue	4	Fri	4	HA530	
		Advanced Development Economics in Agriculture			1	2	●				JICA (Kobayashi)	T2	Mon	4	Mon	5	HA531	

※Language used in the class ◎English ○English by request

Course of study	Category	Course	Teacher's Specialized License		Year of program	Credits		Mode		Language	Instructor	Term	Day	Period	Day 2	Period 2	Course code	Remarks
			Science	Agriculture		Compulsory	Elective	Lecture	Seminar									
Landscape	Compulsory	Theory of Landscape Ecosystems	●		1	2		●		◎	Tang・Takahashi・Honjo・Umeki・Kobayashi・Momohara・Kato・Watanabe・Iwasaki・Mishima・Noda・Ohe(Kobayashi)	T1	Mon	1	Thur	1	HB530	
		Theory of Landscape Architecture		●	1	2		●		◎	Furuya・Ikebe・Saito・Shimoda・Takeda・Zhang・Kinoshita・Yanai・Akita・Omi・Takeuchi	T2	Wed	3	Thur	3	HB531	
		Landscape Project Studio - A			1	4			●	◎	Ikebe・Kinoshita・Yanai・Akita・Kobayashi・Takahashi・Kato・Iwasaki・Mishima・Suzuki (Ikebe)・Ichikawa (Takahashi)・Ishii (Iwasaki)	T1-2	Mon	4	Mon	5	HB532	
		Landscape Project Studio - B			1	4			●	◎	Shimoda・Yanai・Akita・Omi・Kobayashi・Takahashi・Kato・Umeki・Iwasaki・Mishima・TBA(Takeda)・Yatake(Momohara)・Hiramatsu (Yanai)・Ichikawa(Takahashi)	T4-5	Mon	4	Mon	5	HB533	
Landscape	Compulsory Elective	Urban Landscape and Green Space Design		●	1	2		●		○	Ikebe・Kinoshita	T2	Tue	5	Fri	5	HB514	
		Theory of Landscape Management		●	1	2		●		○	Yanai・Akita	T4	Tue	2	Fri	2	HB515	
		Theory of Town and Country Space Planning		●	1	2		●		○	Saito・Karasaki	T4	Mon	2	Fri	2	HB516	
		Theory of Natural and Cultural Landscape Planning		●	1	2		●		○	Furuya・Shimoda	T5	Wed	2	Fri	2	HB517	
		Landscape Ecology	●		1	2		●		○	Kobayashi・Umeki	T4	Mon	1	Thur	1	HB518	
		Garden and Landscape Design Theory		●	1	2		●		○	Takeda・Zhang	T5	Tue	2	Fri	2	HB519	
		Plant Biogeography	●		1	2		●		○	Momohara・Watanabe・Uehara	T5	Tue	2	Fri	2	HB520	
		Foundation Engineering of Landscape	●		1	2		●		○	Tang・Takahashi	T2	Mon	2	Thur	2	HB521	
		Remote Sensing for Spatial Analysis	●		1	2		●		○	Honjo・Kato・【Hongo】	T1	Tue	1	Tue	2	HB522	
		Environment and Health Science	●		1	2		●			Iwasaki・Mishima・Noda	T2	Mon	2	Thur	2	HB523	
		Environmental landscape planting		●	1	2		●		○	Takeuchi・Omi	T2	Wed	1	Wed	2	HB524	
		Aqua Environmental Ecology	●		1	2		●		○	Togashi・Kikuchi	T3	Inetensive				HB525	Marine Biosystems Research Center
		Ecodesign I		●	1	2		●		○	Kinoshita・【Ueda】	T1-2	Fri	2			HB526	Nishi-Chiba
		Theory of Care Design	●		1	2		●			Iwasaki・【Shimomura】	T4-5	Mon	3			HB527	
		Ecological Engineering			1	2		●			Tawa・Sagawa (Umeki)	T4	Inetensive				HB528	
		International Landscape Project Studio			1・2	2		●		◎	Shimoda・Takeda・Zhang	T3, T6	Inetensive				HB529	
Landscape	Elective	Technology Management of Environmental Horticulture		●	1	2		●			Sakurai・Ishida・Fujii(Ishida)	Full	Inetensive				HA501	
		Entrepreneurship for Horticulture			1	2		●			Raku etc (Isoda)	T1-2	Wed	3			HA502	
		Special Seminar			2	2		●			Momohara・Furuya・Ikebe・Yanai・Iwasaki・Honjo・Guest lecturer	T4-5	Tue	5			HB501	※Some classes : irregular
		Advanced Theory of Horticultural Therapy			1	2		●			Iwasaki	T5	Tue	3	Tue	4	HB502	
		Advanced Theory of Landscape Planning			2	2		●			Furuya・Shimoda	T1	Mon	2	Thur	2	HB503	
		Advanced Theory of Maintenance of Landscape Planting			2	2		●			Omi・Takeuchi	T1	Tue	2	Fri	2	HB504	
		Advanced Theory of Town and Country Regeneration Planning			2	2		●			Saito・Akita	T1	Mon	3	Tue	3	HB505	
		Advanced Theory of Ecohydrology for Engineering			1	2		●			Tang	T2	Wed	1	Wed	2	HB506	
		Advanced Lecture for Horticulture and Health			2	2		●			Noda	T1	Fri	1	Fri	2	HB507	Kashiwanoha Campus
		Advanced Theory of Restoration Ecology			1	2		●			Kobayashi	T2	Tue	1	Fri	1	HB508	
		Advanced Theory of Green Space Functions and Management			1	2		●			Yanai	T2	Tue	2	Fri	2	HB509	
		Advanced Lecture on Forest Management			1	2		●			Umeki	T1-2	Fri	5			HB510	
		Advanced Theory of Urban Green Space Planning and Design			1	2		●			Ikebe	T4	Tue	1	Tue	2	HB511	
		Advanced Environmental Education			1	2		●			Mishima	T5	Mon	1	Thur	1	HB512	
		Advanced Theory of Landscape Design			1	2		●			Takeda・Zhang・Hagino	T4-5	Thur	2			HB513	

※Language used in the class ◎English ○English by request

Course of study	Category	Course	Teacher's Specialized License		Year of program	Credits		Mode		Language ◎English ○English by request	Instructor	Term	Day	Period	Day 2	Period 2	Course code	Remarks
			Science	Agriculture		Compulsory	Elective	Lecture	Seminar									
Basic Course	Compulsory	Environment and Horticulture		●	1	2	●				Kobayashi・Sakurai・Kondo・Shishido・Nishida・Ikebe・Momohara・Maruyama・Takagaki	T2	Tue	3	Fri	3	HX506	
		Scientific Approaches and Ethics for Researchers			1	2	●				Shishido・Matsuoka・Umeki・Mishima・Tobase (Matsuoka)	T4	Tue	3	Fri	3	HX505	
		Graduate Research I			1~2	6			●	○	academic advisor	Full	Inetensive				HX601	register for the last year
	Compulsory Elective	Academic Writing			1	2	●				Miyoshi・Kikuchi・Yashima・Hanaoka・Akita・Yano	T3	Inetensive				HX514	
		Global Seminar on Horticulture			1・2	2	●			○	Hanaoka・Kikuchi・Kato	Full	Inetensive				HX515	
		Internship			1	2			●		Ohkawa・Mishima	Full	Inetensive				HX501	
		Internatnional Internship A			1	2			●	○	Takagaki・Shimoda	Full	Inetensive				HX502	
		Internatnional Internship B			1	3			●	○	Takagaki・Shimoda	Full	Inetensive				HX503	
		Internatniona] Internship C			1	4			●	○	Takagaki・Shimoda	Full	Inetensive				HX504	
		International Environmental Horticulture			1	2	●			◎	Takagaki・Jokan・Kokubun・Goto・Kobayashi・Honjo・Sakurai・Yashima・Tsukagoshi・Kasai	T4-5	Wed	5			HX511	
		Project Management			1	2	●			◎	Fujie (Yashima)	T5	Inetensive				HX510	
		Special Japanese for Horticultural Science A (※for English Program student)			1	2	●			◎	Yashima・Takagaki	T4-5	Inetensive				HX512	※for English Program student
		Special Japanese for Horticultural Science B (※for English Program student)			1	2	●			◎	Yashima・Takagaki	T1-2	Inetensive				HX513	※for English Program student

※Language used in the class ◎English ○English by request

# List of Courses [English Program]Master's Program

Course of study	Category	Course	Year of program	Credits		Mode			Instructor	Term	Day	Period	Day 2	Period 2	Course code	Remarks
				Compulsory	Elective	Lecture	Seminar	Practice								
Horticultural Science	Compulsory (English Program only)	Horticultural Crop Management ([Advanced Technology on Horticulture] Corresponding)	1	2		●			Ogawa	T4-5	Tue	4			HA549	[Advanced Technology on Horticulture] Corresponding
		Advanced Lectures on Applied Biological Science ([Horticulture Genomics]Corresponding)	1	2		●			Nishida・Watanabe・Kodama・Egashia・Amachi・Miyamoto(Kodama)・Dohi・Hanaoka・Hirai・Sonoda・Soma・Miyahara・Kagawa・Shimada	T5	Intensive			HA550	[Horticulture Genomics] Corresponding	
		Genetic Science Communication ([Genetic resource utilization]Corresponding)	1	2		●			Yano・Sato(Yano)	T4-5	Intensive				HA551	[Genetic resource utilization] Corresponding
	Compulsory	Graduate Seminar I	1~2	4			●		academic advisor	Full	Intensive				HA601	register for the last year
	Compulsory Elective	Protected Horticulture Seminarand Practice I	1	2	●	●	●		Takagaki・Tsukagoshi	T4-5	Intensive				HA552	
		Protected Horticulture Seminarand Practice II	1	2	●	●	●		Takagaki・Tsukagoshi	T4-5	Intensive				HA553	
		Protected Horticulture Seminarand Practice III	1	2	●	●	●		Takagaki・Tsukagoshi	Full	Intensive				HA554	
		Protected Horticulture Seminarand Practice IV	1	2	●	●	●		Takagaki・Tsukagoshi	Full	Intensive				HA555	
Landscape	Compulsory	Theory of Landscape Ecosystems	1	2	●				Tang・Takahashi・Honjo・Umeki・Kobayashi・Momohara・Kato・Watanabe・Iwasaki・Mishima・Noda・Ohe(Kobayashi)	T1	Mon	1	Thur	1	HB530	
		Theory of Landscape Architecture	1	2	●				Furuya・Ikebe・Saito・Shimoda・Takeda・Zhang・Kinoshita・Yanai・Akita・Omi	T2	Wed	3	Thur	3	HB531	
		Landscape Project Studio - A	1	4		●			Ikebe・Kinoshita・Yanai・Akita・Kobayashi・Takahashi・Kato・Iwasaki・Mishima・Suzuki (Ikebe)・Ichikawa(Takahashi)・Ishii(Iwasaki)	T1-2	Mon	4	Mon	5	HB532	
		Landscape Project Studio - B	1	4		●			Shimoda・Yanai・Akita・Omi・Kobayashi・Takahashi・Kato・Umeki・Iwasaki・Mishima・TBA(Takeda)・Yatake(Momohara)・Hiramatsu (Yanai)・Ichikawa(Takahashi)	T4-5	Mon	4	Mon	5	HB533	
	Compulsory Elective	International Landscape Project Studio	1・2	2		●			Shimoda・Takeda・Zhang	T3, T6	Intensive				HB529	
Basic Course	Compulsory	International Environmental Horticulture ([Environment and Horticulture] Corresponding)	1	2		●			Takagaki・Jokan・Kokubun・Goto・Kobayashi・Honjo・Sakurai・Yashima・Tsukagoshi・Kasai	T4-5	Wed	5			HX511	[Environmental Horticulture] Corresponding
		Project Management ([Scientific Approaches and Ethics for Researchers] Corresponding)	1	2		●			Fujie(Yashima)	T5	Intensive				HX510	[Scientific Approaches and Ethics for Researchers] Corresponding
		Graduate Research I	1~2	6			●		academic advisor	Full	Intensive				HX601	register for the last year
	Compulsory Elective	Special Japanese for Horticultural Science A (※for English Program student)	1	2		●			Yashima・Takagaki	T4-5	Intensive				HX512	※for English Program student
		Special Japanese for Horticultural Science B (※for English Program student)	1	2		●			Yashima・Takagaki	T1-2	Intensive				HX513	※for English Program student

※Even though you aren't English program student, you may register this program course(except for Special Japanese for Horticultural Science A and B).

(Japanese and English course)

Course of study		Course	Year of program	Credits		Mode			Instructor	Term	Day	Period	Day	Period	Course code	Remarks
				Compulsory	Elective	Lecture	Seminar	Practice								
Horticultural Science	Compulsory Elective	Advanced Lecture on Agricultural Meteorology and Environmental Studies	1		2	●			Matsuoka・Goto・Hikosaka	T4-5	Thur	4			HA534	
		Holistic Interactions in Biosphere	1・2		2	●			Sakamoto・Amachi・Usami・Choh・Nomura・Yashima・Hama	T5	Mon	3	Thur	3	HA535	
		Crop Risk Management	1・2		2	●			Ishikawa (Sakamoto)	T3	Inetensive				HA559	Biennial course in odd-numbered years
		Horticultural Plant Genome Breeding	1		2	●			Sassa・Kikuchi	T1-2	Tue	2			HA536	
		Food Science	1		2	●			Ogawa・Hirai・Shiina・Egashira	T2	Mon	2	Thur	2	HA537	
		Issues on Agricultural and Development Policy	1		2	●			Kobayashi・Fujie・Sugino (Kobayashi)	T1	Inetensive				HA547	
		Statistics for Economics	1		2	●			Kurihara・Maruyama	T3	Inetensive				HA548	
	Elective	Advanced Lecture on Environemntal Control for Plant	1		2	●			Goto・Hikosaka	T2	Tue	2	Fri	2	HA508	
		Advanced Lecture on Cultivar Groups of Ornamental Crops	1		2	●			Kokubun	T5	Mon	1	Thur	1	HA518	
		Advanced Bioorganic Chemistry	1		2	●			Nishida	T2	Mon	1	Thur	1	HA525	
Landscape	Compulsory Elective	Urban Landscape and Green Space Design	1		2	●			Ikebe・Kinoshita	T2	Tue	5	Fri	5	HB514	
		Theory of Landscape Management	1		2	●			Yanai・Akita	T4	Tue	2	Fri	2	HB515	
		Theory of Town and Country Space Planning	1		2	●			Saito・Karasaki(Saito)	T4	Mon	2	Fri	2	HB516	
		Theory of Natural and Cultural Landscape Planning	1		2	●			Furuya・Shimoda	T5	Wed	2	Fri	2	HB517	
		Landscape Ecology	1		2	●			Kobayashi・Umeki	T4	Mon	1	Thur	1	HB518	
		Garden and Landscape Design Theory	1		2	●			Takeda・Zhang	T5	Tue	2	Fri	2	HB519	
		Plant Biogeography	1		2	●			Momohara・Watanabe・Uehara	T5	Tue	2	Fri	2	HB520	
		Foundation Engineering of Landscape	1		2	●			Tang・Takahashi	T2	Mon	2	Thur	2	HB521	
		Remote Sensing for Spatial Analysis	1		2	●			Honjo・Kato・【Hongo】	T1	Tue	1	Tue	2	HB522	
		Environmental landscape planting	1		2	●			Takeuchi・Oni	T2	Wed	1	Wed	2	HB524	
		Aqua Environmental Ecology	1		2	●			Togashi・Kikuchi	T3	Inetensive				HB525	Marine Biosystems Research Center
		Ecodesign I	1		2	●			Kinoshita・【Ueda】	T1-2	Fri	2			HB526	Nishi-Chiba
		Basic Course	Compulsory Elective	Global Seminar on Horticulture	1・2		2	●			Hanaoka・Kikuchi・Kato	Full	Inetensive			
International Internship A	1				2		●	Takagaki・Shimoda	Full	Inetensive					HX502	
International Internship B	1				3		●	Takagaki・Shimoda	Full	Inetensive					HX503	
International Internship C	1				4		●	Takagaki・Shimoda	Full	Inetensive					HX504	

## List of Courses (Doctoral program)

Course of study	Course	Year of program	Credits				Mode	Language	Instructor	Term	Day	Period	Day 2	Period 2	Course code	Remarks
			Compulsory	Elective	Lecture	Seminar	Practice									
Horticultural Science	Seminar for Multidisciplinary Industrial Sciences	2	2	●			●		Miyauchi (Amachi)・Takagi (Amachi)	Full	Intensive				HA701	
	Environmental Analytical Chemistry	1・2・3	2	●					Witai Watanabe (Yashima)	Full	Intensive				HA702	Biennial course in even-numbered years
	Physiological Ecology of Fungi	1・2・3	2	●				○	Yamato (Sakamoto)	Full	Intensive				HA722	Biennial course in odd-numbered years
	International Horticulture Seminar and Practice I	1	2		●	●		◎	Takagaki・Tsukagoshi	Full	Intensive				HA801	
	International Horticulture Seminar and Practice II	1	2		●	●		◎	Takagaki・Tsukagoshi	Full	Intensive				HA802	
	International Horticulture Seminar and Practice III	1	2		●	●		◎	Takagaki・Tsukagoshi	Full	Intensive				HA803	
	Practice on Horticultural Consulting	2	4		●				Ohkawa・Hisaeda (Ohkawa)	Full	Intensive				HA804	
	Horticulture Industry	1	2	●					Sakurai・Watanabe・Tsukagoshi・Jokan・Ohkawa・Kuronuma	T2	Mon	2	Thur	2	HA703	
	Advanced lecture on Agricultural Meteorology and Environmental Studies	1	2	●				○	Matsuoka・Goto・Hikosaka	T4-5	Thur	4			HA704	
	Holistic Interactions in Biosphere	1・2・3	2	●				○	Sakamoto・Amachi・Usami・Choh・Nomura・Yashima・Hama	T5	Mon	3	Thur	3	HA705	
	Crop Risk Management	1・2・3	2	●				○	Ishikawa (Sakamoto)	T3	Intensive				HA723	Biennial course in odd-numbered years
	Horticultural Plant Genome Breeding	1	2	●				○	Sassa・Kikuchi	T1-2	Tue	2			HA706	
	Food Science	1	2	●				○	Ogawa・Hirai・Shiina・Egashira	T2	Mon	2	Thur	2	HA707	
	Advanced Lectures on Applied Biological Chemistry A	1	2	●					Nishida・Amachi・Egashira・Hirai・Sonoda・Soma	T2	Mon	4	Fri	4	HA708	
	Advanced Lectures on Applied Biological Chemistry B	1	2	●					Hanaka・Watanabe・Kagawa・Shimada	T3	Intensive				HA709	Nishi-Chiba
	Advanced Lectures on Applied Biological Chemistry C	1	2	●					Kodama・Miyamoto (Kodama)・Dohi・Miyahara	T4	Intensive				HA710	
	Uncultured Microbiology	1・2	1	●					Emagata (Amachi)	T4	Intensive				HA711	Biennial course in odd-numbered years
	Science for Phytochemical Technology	1・2	1	●					Kobori (Egashira)・Egashira	T4	Intensive				HA712	Biennial course in even-numbered years
	Environmental Plant Physiology and Engineering	1・2	2	●					Kodama・Miyahara・Kinoshita (Kodama)・Kasahara (Kodama)	T4-5	Intensive				HA713	Biennial course in odd-numbered years
	Advanced Lecture on Biomolecule Observation	1	2	●					[Iura]・[Ito]・[Terasaki]	T1-2	Intensive				HA714	
	Advanced Lecture on Molecular Biology	1	2	●					[Endo]・[Ogasawara]	Full	Intensive				HA715	
	Advanced Lecture on Cell biology	1	2	●					[Matsuura]・[Ishikawa]・[Itakura]	T4-5	Intensive				HA716	
	Issues on Agricultural and Development Policy	1	2	●		●		○	Kobayashi・Fujie・Sugino (Kobayashi)	T1	Intensive				HA717	
	Statistics for Economics	1	2	●		●		○	Kurihara・Maruyama	T3	Intensive				HA718	
Landscape	Horticultural Crop Management	1	2	●				◎	Ogawa	T4-5	Tue	4			HA719	
	Advanced Lectures on Applied Biological Science	1	2	●				◎	Nishida・Watanabe・Kodama・Egashira・Amachi・Miyamoto (Kodama)・Dohi・Hanaka・Hirai・Sonoda・Soma・Miyahara・Kagawa・Shimada	T5	Intensive				HA720	
	Genetic Science Communication	1	2	●				◎	Yano・Sato (Yano)	T4-5	Intensive				HA721	
	Special Seminar	2	2	●					Momohara・Furuya・Ikebe・Yanai・Iwasaki・Honjo・Guest lecturer	T4-5	Tue	5			HB701	※Some classes : irregular
	Ecodesign II	1	2	●				○	Kinoshita・[Ueda]	T1-2	Fri	2			HB702	Nishi-Chiba
	Urban Landscape and Green Space Design	1	2	●				○	Ikebe・Kinoshita	T2	Tue	5	Fri	5	HB703	
	Theory of Landscape Management	1	2	●				○	Yanai・Akita	T4	Tue	2	Fri	2	HB704	
	Theory of Town and Country Space Planning	1	2	●				○	Saito・Karasaki (Saito)	T4	Mon	2	Fri	2	HB705	
	Theory of Natural and Cultural Landscape Planning	1	2	●				○	Furuya・Shimoda	T5	Wed	2	Fri	2	HB706	
	Landscape Ecology	1	2	●				○	Kobayashi・Ueki	T4	Mon	1	Thur	1	HB707	
	Garden and Landscape Design Theory	1	2	●				○	Takeda・Zhang	T5	Tue	2	Fri	2	HB708	
	Plant Biogeography	1	2	●				○	Momohara・Watanabe・Uehara	T5	Tue	2	Fri	2	HB709	
	Foundation Engineering of Landscape	1	2	●				○	Tang・Takahashi	T2	Mon	2	Thur	2	HB710	
	Remote Sensing for Spatial Analysis	1	2	●				○	Honjo・Kato・[Hongo]	T1	Tue	1	Tue	2	HB711	
	Environment and Health Science	1	2	●					Iwasaki・Mishima・Noda	T2	Mon	2	Thur	2	HB712	
	Environmental Landscape Planning	1	2	●				○	Takeuchi・Om	T2	Wed	1	Wed	2	HB713	
	Theory of Care Design	1	2	●					Iwasaki・[Shinomura]	T4-5	Mon	3			HB714	

※Language used in the class ◎English○English by request.

※If you take the same class you took in Master's Program while you are in Doctoral Program, those class credits will not count as credits required for completion.

Course of study	Course	Year of program	Credits				Language	Instructor	Term	Day	Period	Day 2	Period 2	Course code	Remarks
			Compulsory	Elective	Lecture	Seminar	Practice								
Basic Course(Elective)	Academic Writing	1	2	●				Miyoshi・Kikuchi・Yashima・Hanaoka・Akita・Yano	T3	Intensive				HX708	
	Technology Management of Environmental Horticulture	1	2	●		●		Sakurai・Ishida・Fujii (Ishida)	Full	Intensive				HX709	
	Entrepreneurship for Horticulture	1	2	●		●		Kaku etc (Nomura)	T1-2	Wed	3			HX702	
	Global Seminar on Horticulture	1・2	2	●			○	Hanaoka・Kikuchi・Kato	Full	Intensive				HX707	
	International Internship A	1	2		●		○	Takagaki・Shimoda	Full	Intensive				HX800	
	International Internship B	1	3		●		○	Takagaki・Shimoda	Full	Intensive				HX801	
	International Internship C	1	4		●		○	Takagaki・Shimoda	Full	Intensive				HX802	
	International Environmental Horticulture	1	2	●			◎	Takagaki・Jokan・Kokubun・Goto・Kobayashi・Honjo・Sakurai・Yashima・Toukagoshi・Kasai	T4-5	Wed	5			HX703	
	Project Management	1	2	●			◎	Fujiie (Yashima)	T5	Intensive				HX706	
	Special Japanese for Horticultural Science C	1	2	●			◎	Yashima・Takagaki	T4-5	Intensive				HX704	※for English Program student
	Special Japanese for Horticultural Science D	1	2	●			◎	Yashima・Takagaki	T1-2	Intensive				HX705	※for English Program student
Basic Course (Compulsory)	Graduate Seminar II	1~3	2		●		○	academic advisor	Full	Intensive				HX901	register for the last year
	Graduate Research II	1~3	4		●		○	academic advisor	Full	Intensive				HX902	register for the last year

※Language used in the class ◎English○English by request.

※If you take the same class you took in Master's Program while you are in Doctoral Program, those class credits will not count as credits required for completion.

## List of Courses 【English Program】 Doctoral Program

Course of study	Course	Year of program	Credits		Mode					Instructor	Term	Day	Period	Day 2	Period 2	Course code	Remarks
			Compulsory	Elective	Lecture	Seminar	Practice	Management	Economy								
Horticultural Science	International Horticulture Seminar and Practice I	1	2		●	●				Takagaki・Tsukagoshi	Full	Intensive				HA801	
	International Horticulture Seminar and Practice II	1	2		●	●				Takagaki・Tsukagoshi	Full	Intensive				HA802	
	International Horticulture Seminar and Practice III	1	2		●	●				Takagaki・Tsukagoshi	Full	Intensive				HA803	
	Horticultural Crop Management	1	2	●						Ogawa	T4-5	Tue	4			HA719	
	Advanced Lectures on Applied Biological Science	1	2	●						Nishida・Watanabe・Kodama・Egashira・Amachi・Miyamoto(Kodama)・Dohi・Hanaoka・Hirai・Sonoda・Soma・Miyahara・Kagawa・Shimada	T5	Intensive				HA720	
	Genetic Science Communication	1	2	●						Yano・Sato(Yano)	T4-5	Intensive				HA721	
Basic Course (Compulsory)	Graduate Seminar II	1~3	2		●					academic advisor	Full	Intensive				HX901	register for the last year
	Graduate Research II	1~3	4				●			academic advisor	Full	Intensive				HX902	register for the last year
Basic Course (Elective)	International Environmental Horticulture	1	2	●						Takagaki・Jokan・Inubushi・Kokubun・Goto・Kobayashi・Honjo・Sakurai・Yashima・Tsukagoshi・Kasai	T4-5	Wed	5			HX703	
	Project Management	1	2	●						Fujie (Yashima)	T5	Intensive				HX704	
	Special Japanese for Horticultural Science C (※for English Program student)	1	2	●						Yashima・Takagaki	T4-5	Intensive				HX704	※for English Program student
	Special Japanese for Horticultural Science D (※for English Program student)	1	2	●						Yashima・Takagaki	T1-2	Intensive				HX705	※for English Program student

※Even though you aren't English program student, you may register this program course(except for Special Japanese for Horticultural Science C and D).

※If you take the same class you took in Master's Program while you are in Doctoral Program, those class credits will not count as credits required for completion.

## (Japanese and English course)

Course of study	Course	Year of program	Credits		Mode					Instructor	Term	Day	Period	Day 2	Period 2	Course code	Remarks
			Compulsory	Elective	Lecture	Seminar	Practice	Management	Economy								
Horticultural Science	Physiological Ecology of Fungi	1・2・3	2	●						Yamato (Sakamoto)	Full	Intensive				HA722	Biennial course in odd-numbered years
	Advanced lecture on Agricultural Meteorology and Environment	1	2	●						Matsuoka・Goto・Hikosaka	T4-5	Thur	4			HA704	
	Holistic Interactions in Biosphere	1・2・3	2	●						Sakamoto・Amachi・Usami・Choh・Nomura・Yashima・Hama	T5	Mon	3	Thur	3	HA705	
	Crop Risk Management	1・2・3	2	●						Ishikawa (Sakamoto)	T3	Intensive				HA723	Biennial course in odd-numbered years
	Horticultural Plant Genome Breeding	1	2	●						Sassa・Kikuchi	T1-2	Tue	2			HA706	
	Food Science	1	2	●						Ogawa・Hirai・Shiina・Egashira	T2	Mon	2	Thur	2	HA707	
	Issues on Agricultural and Development Policy	1	2	●				●		Kobayashi・Fujie・Sugino(Kobayashi)	T1	Intensive				HA717	
	Statistics for Economics	1	2	●				●		Kurihara・Maruyama	T3	Intensive				HA718	
Landscape	Ecodesign II	1	2	●						Kinoshita・【Ueda】	T1-2	Fri	2			HB702	Nishi-Chiba
	Urban Landscape and Green Space Design	1	2	●						Ikebe・Kinoshita	T2	Tue	5	Fri	5	HB703	
	Theory of Landscape Management	1	2	●						Yanai・Akita	T4	Tue	2	Fri	2	HB704	
	Theory of Town and Country Space Planning	1	2	●						Saito・Karasaki(Saito)	T4	Mon	2	Fri	2	HB705	
	Theory of Natural and Cultural Landscape Planning	1	2	●						Furuya・Shimoda	T5	Wed	2	Fri	2	HB706	
	Landscape Ecology	1	2	●						Kobayashi・Umeki	T4	Mon	1	Thur	1	HB707	
	Garden and Landscape Design Theory	1	2	●						Takeda・Zhang	T5	Tue	2	Fri	2	HB708	
	Plant Biogeography	1	2	●						Momohara・Watanabe・Uehara	T5	Tue	2	Fri	2	HB709	
	Foundation Engineering of Landscape	1	2	●						Tang・Takahashi	T2	Mon	2	Thur	2	HB710	
	Remote Sensing for Spatial Analysis	1	2	●						Honjo・Kato・【Hongo】	T1	Tue	1	Tue	2	HB711	
	Environmental Landscape Planting	1	2	●						Takeuchi・Omi	T2	Wed	1	Wed	2	HB713	
Basic Course (Elective)	Global Seminar on Horticulture	1・2	2	●						Hanaoka・Kikuchi・Kato	Full	Intensive				HX707	
	International Internship A	1	2				●			Takagaki・Shimoda	Full	Intensive				HX800	
	International Internship B	1	3				●			Takagaki・Shimoda	Full	Intensive				HX801	
	International Internship C	1	4				●			Takagaki・Shimoda	Full	Intensive				HX802	

※If you take the same class you took in Master's Program while you are in Doctoral Program, those class credits will not count as credits required for completion.

## Recommended Courses

Master's Program, Course of Horticultural Science	School	Division	Course
	Graduate School of Science and Engineering	Division of Earth and Environmental Sciences	Basic Earth Surface Dynamics—1
			Basic Earth Surface Dynamics—2
		Division of Advanced Science and Engineering	Advanced Lecture on Phylogenetics
			Biomaterial Chemistry
			Material Science in Bioinformation
			Advanced Lecture on Development
			Regulation of Molecular Functions
			Morphogenesis of Functional Status
			Special Lecture on Molecular 4
			Special Lecture on Molecular 5
			Special Lecture on Molecular 6
		Common Courses	Venture Business
			Venture Business Management

Master's Program, Course of Landscape	School	Division	Course
	Graduate School of Science and Engineering	Division of Earth and Environmental Sciences	Basic Earth Surface Dynamics—1
			Basic Earth Surface Dynamics—2
			Observation of Earth Surface Environment
			Advanced Lecture on Ecology 2
			Atmospheric Remote Sensing
			Remote Sensing of Regional Environment
			Theory of Community Design
			Urban Planning of Human Place
			Housing Planning and Design
		Division of Advanced Science and Engineering	Advanced Lecture on Phylogenetics
			Biomaterial Chemistry
			Material Science in Bioinformatics
			Advanced Lecture on Developmental Biology
			Molecular Functional Control
			Morphogenesis of Functional Control
			Special Lecture on Molecular Biology 4
			Professional Collaboration and Practise Theory
			Special Lecture on Molecular Biology 6
		Division of Creative Engineering	Urban and Regional Planning
			Human-Living Environment System
			Theory of Living Environmental Design
			Design Psychology
		Division of Fundamental Engineering	Visual Science
			Biomechanics
		Common Courses	Motor Control of Human Movement
			Diagnostic Measurement Systems
	Graduate School of Nursing	Disaster Nursing Global Leader Degree Program	Venture Business
			Venture Business Management
	Graduate School of Nursing	Disaster Nursing Global Leader Degree Program	Disaster Professional Collaboration Exercise(Disaster IP Exercise)

Doctoral Program, Course of Horticultural Science	School	Division	Course
	Graduate School of Science and Engineering	Common Courses	Venture Business
			Venture Business Management

Doctoral Program, Course of Landscape	School	Division	Course
			Basic Earth Surface Dynamics— 1
			Basic Earth Surface Dynamics— 2
			Observation of Earth Surface Environment
			Advanced Lecture on Ecology 2
			Advanced Topics in Urban/Space Produce
			Theory of Community Design
		Division of Advanced Science and Engineering	Advanced Lecture on Phylogenetics
		Division of Creative Engineering	Urban and Regional Planning
			Special Studies in Urban Design
			Nature Friendly and Barrier Free Design of Architecture
			Theory of Care Design II
			Topics in Environmental Ergonomics
			Design Psychology for Human Life
			Behavioral Environment Design
			Human-Living Environment System
			Visual Science
		Division of Fundamental Engineering	Motor Control of Human Movement
			Diagnostic Measurement Systems
		Common Courses	Venture Business
			Venture Business Management

## Common Graduate Courses

Master's Program	School	Course
		Ethics for Engineers and Intellectual Property
		Advanced Seminar in Intellectual Property Rights(Chemistry)
		Advanced Seminar in Intellectual Property Rights(Physics)
	Graduate School of Science and Engineering	Ability to Manage Technology
	Graduate School of Medical and Pharmaceutical Sciences	Introduction of drug discovery and life sciences I
		Introduction of drug discovery and life sciences II
		Public health
	Graduate School of Nursing	Professional Collaboration and Practice Theory
		End of Life Care
		Professional Collaboration and Education Theory
		Disaster Professional Collaboration Exercise
	Graduate School of Humanities and Studies on Public Affairs	Higher Education System
	ALL	Service Innovation Studio Work
		Academic Listening
		Academic Writing
		Academic Presentation
		research methodologies
		Introduction to study abroad
		data science
		Programming for Data Science
		Practical Machine Learning
		Introduction of Digital Humanities
		Design Thinking Studio Work
		Introduction to Inclusive business
		Basic Design Thinking
		Basic Global Service Design
		Basic Landscape Service Design
		Career design
		Preparing Future Faculty Course(1)
		Preparing Future Faculty Course(2)
		Collage-Link plus
		Regional Tourism Development
		Enhanced Global Study Program
		Enhanced Multi Carrier Program

Doctoral Program	School	Course
	Graduate School of Science and Engineering	Ethics for Engineers and Intellectual Property
		Advanced Seminar in Intellectual Property Rights(Chemistry)
		Advanced Seminar in Intellectual Property Rights(Physics)
		Ability to Manage Technology
	Graduate School of Nursing	Professional Collaboration and Practice Theory
		End of Life Care
	Graduate School of Humanities and Studies on Public Affairs	Higher Education System
	ALL	Service Innovation Studio Work
		Academic Listening
		Academic Writing
		Academic Presentation
		research methodologies
		data science
		Programming for Data Science
		Practical Machine Learning
		Design Thinking Studio Work
		Landscape Service Design
		Career design
		Preparing Future Faculty Course(1)
		Preparing Future Faculty Course(2)
		Collage-Link plus
		Regional Tourism Development
		Enhanced Global Study Program-Advanced Level
		Enhanced Multi Carrier Program-Advanced Level

## Allowed Teaching Licenses and Study Requirements (for the Japanese)

Students earning the necessary credits stipulated in the School Teacher's License Act and the Ordinance for Enforcement of the School Teacher's License Act in a Master's Program at the Graduate School of Horticulture can attain the following types of teaching licenses for the following licensed subjects.

Division	Type of License	Licensed Subject
Environment and Horticulture	Middle School Teacher's Specialized License	Science
	High School Teacher's Specialized License	Science; Agriculture

The following conditions must be satisfied to attain the abovementioned specialist licenses.

- Prior attainment in an undergraduate faculty, etc. of the necessary qualifications for a Middle School First Class Teaching License (Science) or a Senior High First Class Teaching License (Science; Agriculture).
- Attainment of 24 or more credits from the courses stipulated below.

Details on how to apply, etc. are explained in Guidance, but please ask at the Student Affairs Unit if anything remains unclear.

Department	Department of Environment and Horticulture		
Licenses	Middle School Teacher's Specialized License/High School Teacher's Specialized License		
	Science		
Courses	Genetic resource utilization	Theory of Landscape Ecosystems	
	Horticulture Genomics	Landscape Ecology	
	Holistic Interactions in Biosphere	Plant Biogeography	
	Horticultural Plant Genome Breeding	Foundation Engineering of Landscape	
	Food Science	Remote Sensing for Spatial Analysis	
	Advanced Lectures on Applied Biological Chemistry A	Environment and Health Science	
	Advanced Lectures on Applied Biological Chemistry B	Aqua Environmental Ecology	
	Advanced Lectures on Applied Biological Chemistry C	Theory of Care Design	
	Uncultured Microbiology		
	Science for Phytochemical Technology		
	Environmental Plant Physiology and Engineering		
	Advanced Lecture on Biomolecule Observation		
	Advanced Lecture on Molecular Biology		
	Advanced Lecture on Cell biology		

Department	Department of Environment and Horticulture		
Licenses	High School Teacher's Specialized License		
	Agriculture		
Courses	Advanced Technology on Horticulture	Theory of Landscape Architecture	Technology Management of Environmental Horticulture
	Practice on Horticultural Consulting	Urban Landscape and Green Space Design	Environment and Horticulture
	Horticulture Industry	Theory of Landscape Management	
	Advanced Lecture on Agricultural Meteorology and Environmental Studies	Theory of Town and Country Space Planning	
	Issues on Agricultural and Development Policy	Theory of Natural and Cultural Landscape Planning	
	Statistics for Economics	Garden and Landscape Design Theory	
		Environmental landscape planting	
		Ecodesign I	

## Requirements for the License of Nature Restoration Assistant Promoter

Graduates of Landscape Course earning the following necessary credits can attain the license of Nature Restoration Assistant Promoter. Nature Restoration Assistant Promoter can get the right to apply the examination for the license of Nature Restoration Promoter after the experience of practice more than 1 year. For details, see the homepage of Japan Greenery Research and Development Center (<http://www.jpgreen.or.jp/>).

The following conditions must be satisfied to attain the license.

- Attainment of 8 credits of special courses stipulated below.
- Attainment of 2 credits of elective courses stipulated below.

Fields	Courses
Special courses	Project of Landscape Science A & B
Elective courses	Urban Landscape and Green Space Design, Theory of Landscape Management, Theory of Town and Country Space Planning, Theory of Natural and Cultural Landscape Ecology, Garden and Landscape Design Theory, Plant Biogeography, Foundation Engineering of Landscape, Remote Sensing for Spatial Analysis, Environment and Health Science, Environmental Landscape Planting, Aqua Environmental Ecology, Ecological Engineering

## 3. 2021/2022 Class Timetable

## Division of Environment and Horticulture (Master's program)

## Term 1

	I 8:50~10:20	II 10:30~12:00	III 12:50~14:20	IV 14:30~16:00	V 16:10~17:40
Mon.	Theory of Landscape Ecosystems Tang・Takahashi・Honjo・Umeki ㉒, ㉓	Advanced Plant Pathology Shishido, ㉒, ㉓ E102 Advanced Nutritional Chemistry Egashira・Hirai, ㉒, ㉓ Advanced Theory of Landscape Planning Furuya・Shimoda, ㉒, ㉓, ㉔ E103	Advanced Theory of Town and Country Regeneration Planning. Saito・Akita, ㉓, D112	Landscape Project Studio - A Ikebe・Kinoshita・Yanai・Akita, ㉓, ㉔	Advanced Technology on Horticulture Goto・Matsuoka・Shiina, ㉓, ㉔, D112 Landscape Project Studio - A Ikebe・Kinoshita・Yanai・Akita, ㉓, ㉔
Tue.	Advanced Biotechnology Kodama・Shimada, ㉒, ㉓ E310 Remote Sensing for Spatial Analysis Honjo・Kato・[Hongo] ㉒, ㉓	Advanced Soil Microbiology Sakamoto, ㉒ Advanced Lecture on Flowering Control Miyoshi, ㉓ E307 Advanced Biotechnology of Agroresources Sonoda, ㉒, ㉓, E310 Remote Sensing for Spatial Analysis Honjo・Kato・[Hongo], ㉒, ㉓ Horticultural Plant Genome Breeding Sassa・Kikuchi, ㉒, ㉓ Advanced Theory of Maintenance of Landscape Planting, Omi・Takeuchi ㉓, E205	Advanced Theory of Town and Country Regeneration Planning. Saito・Akita, ㉓, D112		
Wed.			Entrepreneurship for Horticulture Nomura, ㉒, ㉓, ㉔ E103		
Thur.	Theory of Landscape Ecosystems Tang・Takahashi・Honjo・Umeki ㉒, ㉓	Advanced Plant Pathology Shishido, ㉒, ㉓ E102 Advanced Nutritional Chemistry Egashira・Hirai, ㉒, ㉓ Advanced Theory of Landscape Planning Furuya・Shimoda, ㉒, ㉓, ㉔ E103			
Fri.	Advanced Biotechnology Kodama・Shimada, ㉒, ㉓ E310 Horticulture Genomics Kikuchi・Kokubun・Nakamura, ㉒ Advanced Lecture for Horticulture and Health Noda, Kashiwanoha Campus	Genetic resource utilization Igawa・Nakamura・Soma・Yoshida, ㉒ Advanced Lecture on Flowering Control Miyoshi, ㉓ E307 Advanced Soil Microbiology Sakamoto, ㉒ Advanced Biotechnology of Agroresources Sonoda, ㉒, ㉓, E310 Ecodesign I Kinoshita・[Ueda] ㉒, ㉓, ㉔ Nishi-Chiba Advanced Lecture for Horticulture and Health Noda, Kashiwanoha Campus Advanced Theory of Maintenance of Landscape Planting, Omi・Takeuchi ㉓, E205			Advanced Lecture on Forest Umeki, ㉓, E205

## Division of Environment and Horticulture (Master's program)

## Term 2

	I 8:50~10:20	II 10:30~12:00	III 12:50~14:20	IV 14:30~16:00	V 16:10~17:40
Mon.	Advanced Bioorganic Chemistry Nishida, ㉓ E103 Advanced Lecture on Fruit Vegetable Cultivation, Jokan, ㉒	Advanced Environmental Microbiology Amachi, ㉓, E103 Food Science Ogawa・Hirai・Shiina・Egashira, ㉒ Horticulture Industry Sakurai・Watanabe・Tsukagoshi, ㉒ Foundation Engineering of Landscape Tang・Takahashi, ㉓, ㉔ Environment and Health Science Iwasaki・Mishima・Noda, ㉒		Advanced Development Economics in Agriculture, JICA (Kobayashi), ㉒ Advanced Lectures on Applied Biological Chemistry A, Nishida・Amachi・Egashira・Hirai, ㉓, ㉔ Landscape Project Studio - A Ikebe・Kinoshita・Yanai・Akita, ㉓, ㉔	Advanced Development Economics in Agriculture, JICA (Kobayashi), ㉒ Advanced Technology on Horticulture Goto・Matsuoka・Shiina, ㉓, ㉔, D112 Landscape Project Studio - A Ikebe・Kinoshita・Yanai・Akita, ㉓, ㉔
Tue.	Advanced Agri-Food Engineering Shiina・Ogawa, ㉓ E103 Advanced Lecture on Deciduous Fruit Tree Cultivation, Ohara, ㉒, ㉓ E206 Advanced Theory of Restoration Ecology Kobayashi, ㉓ D112	Horticultural Plant Genome Breeding Sassa・Kikuchi, ㉒, ㉓ Advanced Lecture on Crop Sciences Isoda, ㉒ Advanced Theory of Green Space Functions and Management, Yanai, ㉒, ㉓, E103 Advanced Lecture on Environmental Control for Plant, Goto・Hikosaka, ㉒, ㉓, E206	Environment and Horticulture Kobayashi・Sakurai・Kondo・Shishido, ㉒		Urban Landscape and Green Space Design Ikebe・Kinoshita, ㉒, ㉓
Wed.	Advanced Theory of Ecohydrology for Engineering, Tang, ㉒, ㉓ E206 Environmental landscape planting Takeuchi・Omi, ㉒, ㉓	Advanced Theory of Ecohydrology for Engineering, Tang, ㉒, ㉓ E206 Environmental landscape planting Takeuchi・Omi, ㉒, ㉓	Theory of Landscape Architecture Furuya・Ikebe・Saito・Shimoda, ㉒, ㉓ Entrepreneurship for Horticulture Isoda Nomura, ㉒, ㉓, ㉔ E103		
Thur.	Advanced Bioorganic Chemistry Nishida, ㉓ E103 Advanced Lecture on Fruit Vegetable Cultivation, Jokan, ㉒	Advanced Environmental Microbiology Amachi, ㉓, E103 Food Science Ogawa・Hirai・Shiina・Egashira, ㉒ Horticulture Industry Sakurai・Watanabe・Tsukagoshi, ㉒ Foundation Engineering of Landscape Tang・Takahashi, ㉓, ㉔ Environment and Health Science Iwasaki・Mishima・Noda, ㉒	Theory of Landscape Architecture Furuya・Ikebe・Saito・Shimoda, ㉒, ㉓		
Fri.	Advanced Agri-Food Engineering Shiina・Ogawa, ㉓ E103 Advanced Lecture on Deciduous Fruit Tree Cultivation, Ohara, ㉒, ㉓ E206 Horticulture Genomics Kikuchi・Kokubun・Nakamura, ㉒ Advanced Theory of Restoration Ecology Kobayashi, ㉓ D112	Genetic resource utilization Igawa・Nakamura・Soma・Yoshida, ㉒ Advanced Lecture on Crop Sciences Isoda, ㉒ Ecodesign I Kinoshita・[Ueda] ㉒, ㉓, ㉔ Nishi-Chiba Foundation Engineering of Landscape Tang・Takahashi, ㉓, ㉔ Environment and Health Science Iwasaki・Mishima・Noda, ㉒	Environment and Horticulture Kobayashi・Sakurai・Kondo・Shishido, ㉒	Advanced Lectures on Applied Biological Chemistry A, Nishida・Amachi・Egashira・Hirai, ㉓, ㉔ Advanced Econometrics Kurihara, ㉓ D201	Advanced Lecture on Forest Umeki, ㉓, E205 Advanced Econometrics Kurihara, ㉓ D201 Urban Landscape and Green Space Design Ikebe・Kinoshita, ㉒, ㉓
T1-T3 Intern- sive	Advanced Lecture on Biomolecule Observation [Ura]・[Ito]・[Terasaki] Acqua Environmental Ecology Togashi・Kikuchi	Issues on Agricultural and Development Policy Kobayashi・Fujie・Sugino (Kobayashi), ㉒ Academic Writing Miyoshi・Kikuchi・Yashima, ㉓	Advanced Rural Development Economics Eri Kato・Kurihara, ㉒, ㉓ Special Japanese for Horticultural Science B Yashima・Takagaki	Statistics for Economics Kurihara・Maruyama, ㉓, D201 Crop Risk Management Ishikawa・Sakamoto, ㉓	Advanced Lectures on Applied Biological Chemistry B Hanaoka・Watanabe・Kagawa・Shimada, ㉓, ㉔ Nishi-Chiba, Gakusu・Kenkyu Build.214

㉒: Both Synchronous Learning, ㉓: Face-To-Tace Learning, ㉔: Video on Demand Learning

# Division of Environment and Horticulture (Master's program)

## Term 4

	I 8:50~10:20	II 10:30~12:00	III 12:50~14:20	IV 14:30~16:00	V 16:10~17:40
Mon.	Advanced Lecture on Plant Molecular Biology Nakamura, ㊦, E307 Advanced Biochemical Plant Pathology Usami, ㊦, ㊵, E102 Landscape Ecology Kobayashi・Umeki, ㊦, ㊵,	Advanced Micrometeorology Matsuoka, ㊦, D112 Advanced Lecture on Evergreen Fruit Tree Cultivation, ㊵, Ohara Theory of Town and Country Space Planning Saito・Karasaki, ㊦	Theory of Care Design Iwasaki, ㊦, ㊵, ㊵, E307	Landscape Project Studio - B Shimoda・Yanai・Akita・Omi	Landscape Project Studio - B Shimoda・Yanai・Akita・Omi
Tue.	Advanced Theory of Urban Green Space Planning and Design, Ikebe, E206	Advanced Theory of Urban Green Space Planning and Design, Ikebe, E206 Theory of Landscape Management Yanai・Akita, ㊵, ㊦, ㊵, E205	Scientific Approaches and Ethics for Researchers, Shishido・Matsuoka・Umeki, ㊵	Horticultural Crop Management Ogawa, ㊵	Special Seminar Momohara・Furuya・Ikebe, ㊦, ㊵, ㊵ ※Some classes: irregular
Wed.					International Environmental Horticulture Takagaki・Jokan, ㊵
Thur.	Advanced Lecture on Plant Molecular Biology Nakamura, ㊦, E307 Advanced Biochemical Plant Pathology Usami, ㊦, ㊵, E102 Landscape Ecology Kobayashi・Umeki, ㊦, ㊵,	Advanced Micrometeorology Matsuoka, ㊦, D112 Advanced Lecture on Evergreen Fruit Tree Cultivation, ㊵, Ohara Advanced Theory of Landscape Design Takeda・Zhang・Hagino, E102		Advanced Lecture on Agricultural Meteorology and Environmental Studies, Matsuoka・Goto・Hikosaka, ㊦, ㊵	
Fri.		Theory of Landscape Management Yanai・Akita, ㊵, ㊦, ㊵, E205 Theory of Town and Country Space Planning Saito・Karasaki, ㊦	Scientific Approaches and Ethics for Researchers, Shishido・Matsuoka・Umeki, ㊵		

# Division of Environment and Horticulture (Master's program)

## Term 5

	I 8:50~10:20	II 10:30~12:00	III 12:50~14:20	IV 14:30~16:00	V 16:10~17:40
Mon.	Advanced Lecture on Cultivar Groups of Ornamental Crops ,Kokubun, ㊦, E102 Advanced Environmental Education Mishima, ㊦, ㊵, D112		Theory of Care Design Iwasaki, ㊦, ㊵, ㊵, E307 Holistic Interactions in Biosphere Sakamoto・Amachi, ㊵	Landscape Project Studio - B Shimoda・Yanai・Akita・Omi	Landscape Project Studio - B Shimoda・Yanai・Akita・Omi
Tue.	Advanced Lecture on Leaf and Root Vegetable Cultivation, Jyokan ㊵ Fundamentals of Engineering Ogawa, ㊵	Plant Biogeography Momohara・Watanabe・Uehara, ㊦ Advanced Lecture on Applied Entomology Nomura, ㊦, ㊵ Advanced Lecture on Soilless Culture Tsukagoshi, ㊵ Garden and Landscape Design Theory Takeda・Zhang, ㊦	Advanced Food Industrial Organization Ishida, ㊦, E-2F Godo Hall Advanced Theory of Horticultural Therapy Iwasaki, ㊦, ㊵, E103	Horticultural Crop Management Ogawa, ㊵ Advanced Food Marketing Sakurai, ㊦, E309 Advanced Theory of Horticultural Therapy Iwasaki, ㊦, ㊵, E103	Special Seminar Momohara・Furuya・Ikebe, ㊦, ㊵, ㊵ ※Some classes: irregular
Wed.		Theory of Natural and Cultural Landscape Planning, Furuya・Shimoda, ㊵, ㊵			International Environmental Horticulture Takagaki・Jokan, ㊵
Thur.	Advanced Lecture on Cultivar Groups of Ornamental Crops ,Kokubun, ㊦, E102 Advanced Environmental Education Mishima, ㊦, ㊵, D112	Advanced Theory of Landscape Design Takeda・Zhang・Hagino, ㊵, ㊦, E102	Holistic Interactions in Biosphere Sakamoto・Amachi, ㊵	Advanced Lecture on Agricultural Meteorology and Environmental Studies, Matsuoka・Goto・Hikosaka, ㊦, ㊵	
Fri.	Advanced Lecture on Leaf and Root Vegetable Cultivation, Jyokan ㊵ Fundamentals of Engineering Ogawa, ㊵	Plant Biogeography Momohara・Watanabe・Uehara, ㊦ Advanced Lecture on Applied Entomology Nomura, ㊦, ㊵ Advanced Lecture on Soilless Culture Tsukagoshi, ㊵ Theory of Natural and Cultural Landscape Planning, Furuya・Shimoda, ㊵, ㊵ Garden and Landscape Design Theory Takeda・Zhang, ㊦	Advanced Food Industrial Organization Ishida, ㊦, E-2F Godo Hall	Advanced Food Marketing Sakurai, ㊦, E309	

T4-T6 Intensive	Advanced Lectures on Applied Biological Chemistry C Kodama・Miyamoto・Dohi・Miyahara, ㊵ Protected Horticulture Seminar and Practice I, Takagaki・Tsukagoshi Environmental Plant Physiology and Engineering Kodama・Miyahara・Kinoshita・Kasahara, ㊦	Uncultured Microbiology Kamagata (Amachi), ㊦ Protected Horticulture Seminar and Practice II, Takagaki・Tsukagoshi Advanced Lecture on Fertilizer Science Yashima, ㊵	Advanced Lecture on Cell biology [Matsuura]・[Ishikawa]・[Itakura], ㊵ Ecological Engineering Tawa・Sagawa (Umeki), ㊦, ㊵, ㊵	Advanced Lectures on Applied Biological Science, Nishida・Watanabe・Kodama・Egashira, ㊦, ㊵ Project Management Fujie (Yashima)	Genetic Science Communication Yano・Sato (Yano), ㊦, ㊵ Special Japanese for Horticultural Science A Yashima・Takagaki, ㊵
--------------------	---	---	--	--	--

# Division of Environment and Horticulture (Master's program)

## Full

Intensive	Technology Management of Environmental Horticulture, Sakurai・Ishida・Fujishida Internship Ohkawa・Mishima Practice on Horticultural Consulting Ohkawa・Hisaeda (Ohkawa), ㊦	Advanced Lecture on Molecular Biology [Endo]・[Ogasawara], ㊵ International Internship A Takagaki・Shimoda Seminar for Multidisciplinary Industrial Sciences, Miyauchi (Amachi)・Takagi (Amachi), ㊦, ㊵	Protected Horticulture Seminar and Practice III, Takagaki・Tsukagoshi International Internship B Takagaki・Shimoda	Protected Horticulture Seminar and Practice IV, Takagaki・Tsukagoshi International Internship C Takagaki・Shimoda	Global Seminar on Horticulture Hanaoka・Kikuchi・Kato, ㊦, ㊵ International Landscape Project Studio Shimoda・Takeda・Zhang
-----------	--	--	---	--	--

No Class in 2021	Science for Phytochemical Technology Kobori (Egashira)				
---------------------	---	--	--	--	--

㊦: Both Synchronous Learning, ㊦: Face-To-Face Learning, ㊵: Video on Demand Learning

## Division of Environment and Horticulture (Doctoral program)

## Term 1

	I	II	III	IV	V
	8:50~10:20	10:30~12:00	12:50~14:20	14:30~16:00	16:10~17:40
Mon.					
Tue.	Remote Sensing for Spatial Analysis Honjo・Kato・【Hongo】 ㊦, ㊧	Horticultural Plant Genome Breeding Sassa・Kikuchi. ㊦, ㊧			
		Remote Sensing for Spatial Analysis Honjo・Kato・【Hongo】 ㊦, ㊧			
Wed.			Entrepreneurship for Horticulture Nomura, ㊦, ㊧, ㊨, ㊩, E103		
Thur.					
Fri.		Ecodesign II Kinoshita・【Ueda】 ㊦, ㊧, ㊨ Nishi-Chiba			

## Division of Environment and Horticulture (Doctoral program)

## Term 2

	I	II	III	IV	V
	8:50~10:20	10:30~12:00	12:50~14:20	14:30~16:00	16:10~17:40
Mon.		Horticulture Industry Sakurai・Watanabe・Tsukagoshi, ㊦		Advanced Lectures on Applied Biological Chemistry A Nishida・Amachi・Egashira, ㊦, ㊧	
		Food Science Ogawa・Hirai・Shiina・Egashira, ㊦			
		Foundation Engineering of Landscape Tang・Takahashi, ㊦, ㊧			
		Environment and Health Science Iwasaki・Mishima・Noda, ㊦			
Tue.		Horticultural Plant Genome Breeding Sassa・Kikuchi, ㊦, ㊧			Urban Landscape and Green Space Design Ikebe・Kinoshita, ㊦, ㊧
Wed.	Environmental landscape planting Takeuchi・Omi ㊦, ㊧	Environmental landscape planting Takeuchi・Omi ㊦, ㊧	Entrepreneurship for Horticulture Nomura, ㊦, ㊧, ㊨, ㊩, E103		
Thur.		Horticulture Industry Sakurai・Watanabe・Tsukagoshi, ㊦			
		Food Science Ogawa・Hirai・Shiina・Egashira, ㊦			
		Foundation Engineering of Landscape Tang・Takahashi, ㊦, ㊧			
		Environment and Health Science Iwasaki・Mishima・Noda, ㊦			
Fri.		Ecodesign II Kinoshita・【Ueda】 ㊦, ㊧, ㊨ Nishi-Chiba		Advanced Lectures on Applied Biological Chemistry A Nishida・Amachi・Egashira, ㊦, ㊧	Urban Landscape and Green Space Design Ikebe・Kinoshita, ㊦, ㊧

T1-T3 Intensive	Advanced Lectures on Applied Biological Chemistry B	Statistics for Economics	Academic Writing	Advanced Lecture on Biomolecule Observation	Special Japanese for Horticultural Science D
	Hanaka・Watanabe・Kagawa・Shimada, ㊦, ㊧ Nishi-Chiba, Gakusai-Kenkyu build.214	Kurihara・Maruyama, ㊦, D201	Miyoshi・Kikuchi・Yashima, ㊦	【Ura】・【Ito】・【Terasaki】	Yashima・Takagaki, ㊦
	Issues on Agricultural and Development Policy Kobayashi・Fujiie・Sugino (Kobayashi), ㊦	Crop Risk Management Ishikawa・Sakamoto, ㊦			

㊦: Both Synchronous Learning, ㊧: Face-To-Tace Learning, ㊨: Video on Demand Learning

## Division of Environment and Horticulture (Doctoral program)

## Term 4

	I	II	III	IV	V
	8:50~10:20	10:30~12:00	12:50~14:20	14:30~16:00	16:10~17:40
Mon.	Landscape Ecology Kobayashi・Umeki, ㊦, ㊧	Theory of Town and Country Space Planning Saito・Karasaki, ㊦	Theory of Care Design Iwasaki, ㊦, ㊧, ㊨ E307		
Tue.		Theory of Landscape Management Yanai・Akita, ㊨, ㊦, ㊧, ㊨ E205		Horticultural Crop Management Ogawa, ㊨	Special Seminar Momohara・Furuya・Ikebe, ㊦, ㊧, ㊨ ※Some classes: irregular
Wed.					International Environmental Horticulture Takagaki・Jokan, ㊧
Thur.	Landscape Ecology Kobayashi・Umeki, ㊦, ㊧			Advanced lecture on Agriculture Meteorology and Environmental Studies Matsuoka・Goto・Hikosaka, ㊦, ㊧	
Fri.		Theory of Landscape Management Yanai・Akita, ㊨, ㊦, ㊧, ㊨ E205			
		Theory of Town and Country Space Planning Saito・Karasaki, ㊦			

## Division of Environment and Horticulture (Doctoral program)

## Term 5

	I	II	III	IV	V
	8:50~10:20	10:30~12:00	12:50~14:20	14:30~16:00	16:10~17:40
Mon.			Theory of Care Design Iwasaki, ㊦, ㊧, ㊨ E307		
			Holistic Interactions in Biosphere Sakamoto・Amachi, ㊧		
Tue.		Garden and Landscape Design Theory Takeda・Zhang, ㊦		Horticultural Crop Management Ogawa, ㊨	Special Seminar Momohara・Furuya・Ikebe, ㊦, ㊧, ㊨ ※Some classes: irregular
		Plant Biogeography Momohara・Watanabe・Uehara, ㊦			
Wed.		Theory of Natural and Cultural Landscape Planning, Furuya・Shimoda, ㊧, ㊨			International Environmental Horticulture Takagaki・Jokan, ㊧
Thur.			Holistic Interactions in Biosphere Sakamoto・Amachi, ㊧	Advanced lecture on Agriculture Meteorology and Environmental Studies Matsuoka・Goto・Hikosaka, ㊦, ㊧	
Fri.		Plant Biogeography Momohara・Watanabe・Uehara, ㊦			
		Theory of Natural and Cultural Landscape Planning, Furuya・Shimoda, ㊧, ㊨			
		Garden and Landscape Design Theory Takeda・Zhang, ㊦			

T4-T8 Intensive	Advanced Lectures on Applied Biological Chemistry C Kodama・Miyamoto(Kodama)・Dohi・Miyahara, ㊧	Uncultured Microbiology Kamagata (Amachi), ㊦	Advanced Lecture on Cell biology [Matsuura]・[Ishikawa]・[Itakura] ㊧	Advanced Lectures on Applied Biological Science Nishida・Watanabe・Kodama・Egashira, ㊦, ㊧	Genetic Science Communication Yano・Sato(Yano), ㊦, ㊧
	Project Management Fujie (Yashima)	Special Japanese for Horticultural Science C Yashima・Takagaki	Environmental Plant Physiology and Engineering Kodama・Miyahara・Kinoshita・Kasahara, ㊦		

## Division of Environment and Horticulture (Doctoral program)

## Full

Intensive	Technology Management of Environmental Horticulture Sakurai・Ishida・Fujii (Ishida), ㊦	Global Seminar on Horticulture Hanaoka・Kikuchi・Kato, ㊦, ㊨	International Internship A Takagaki・Shimoda	International Internship B Takagaki・Shimoda	International Internship C Takagaki・Shimoda
	Seminar for Multidisciplinary Industrial Sciences Miyauchi・Takagi (Amachi), ㊦, ㊧	Practice on Horticultural Consulting Ohkawa・Hisaeda (Ohkawa) ㊦	Advanced Lecture on Molecular Biology [Endo]・[Ogasawara] ㊧	International Horticulture Seminar and Practice I Takagaki・Tsukagoshi	International Horticulture Seminar and Practice II Takagaki・Tsukagoshi
	International Horticulture Seminar and Practice III Takagaki・Tsukagoshi	Physiological Ecology of Fungi Yamato (Sakamoto) ㊦			
No Class in 2021	Science for Phytochemical Technology Kobori (Egashira), E103	Environmental Analytical Chemistry Mirai Watanabe (Yashima)			

㊦: Both Synchronous Learning, ㊦: Face-To-Face Learning, ㊧: Video on Demand Learning

## 4 . Procedures for Master's/Doctoral Defense

### Steps and Procedures for Master's Defense

Reviews of Master's theses and research outcomes (hereinafter referred to as "Thesis.") are conducted in accordance with the following procedures based on the Graduate School of Horticulture's Policy for the Conferment Degrees and the Degree Review Criteria for Master's program. Schedules may vary from year to year, so please refer to the schedule for the academic year in question. The schedule is posted on the Graduate School of Horticulture Website.

#### 1) Discussion with your Main Academic Advisor

Please discuss your application for a review of your Master's Thesis. with your main academic advisor and get his/her approval.

The academic degrees conferred are, Master of Agriculture or Master of Philosophy in Horticultural Science Course, and Master of Landscape Architecture or Master of Philosophy in Landscape Course.

#### 2) Provision of Applications for a Review

Applications for a Review of a Master's Thesis can be downloaded from our website.

#### 3) Applications for a Review of a Thesis. (November for completion in March; May for completion in September)

Please submit your Application for Review of a Master's Thesis, etc. to the Academic Affairs Group.

Please refer to [1. Documents for Submission] for information on documents required for an application.

#### 4) Preparation of Theses and Reviews

- ① A review committee is established each time a Thesis is submitted; these are reviewed by three or more committee members.
- ② The review committee holds an open meeting for presentation of the Thesis in mid-February (late July through early August for completion in September), and conducts a Thesis review and a final examination.
- ③ The review committee reviews the Thesis to determine whether or not it is worthy of an academic degree. It also determines the nomenclature of the academic degree.
- ④ Please prepare your Thesis in accordance with the Guidelines on the Preparation of Documents. Reviews of Thesis are conducted between early January and early February (late June through late July for completion in September). Thesis (for review) must be submitted to the review committee by early January (late June for completion in September). Follow your main academic advisor's guidance regarding the timing, etc. of submissions to the review committee. Also, depending on the program or course, interim presentations may be held.
- ⑤ Applicants shall amend their Thesis in accordance with the review committee's instruction.
- ⑥ As a rule, Theses that are not submitted by the designated date shall be regarded as having failed, and no academic degree shall be conferred.

- 5) The decision on whether an applicant has passed or failed shall be determined within the course subsequent to review of the Thesis.
- 6) The faculty council shall determine completion of a course of study on the basis of the decision made within the course.
- 7) As a rule, students completing courses of study will be awarded academic degrees in March and September.
- 8) After obtaining the consent of the student who wrote the Thesis, it may be read, printed and quoted etc. by others.

## 1. Documents for Submission

1. 1 Applications for (Master's) reviews (to be submitted to (1)the Academic Affairs Group, (2) committee members)

Documents for Submission	No. of Copies	Preparation Guidelines	Notes
(1)Application for Review of a Thesis	1	2. 1	
(2)Thesis (for Review)	3	2. 2	Can be submitted in a file

1. 2 Submission of Thesis

Submission	No. of Copies	Preparation Guidelines	Notes
Thesis	—	2. 3	To main academic advisor by electronic data

## 2. Guidelines on the Preparation of Documents

Please use a typewriter or document preparation software on a computer to prepare documents, etc. If they are to be written by hand, please write neatly using standard style characters for Japanese text and block letters for alphanumeric text.

2. 1 Application for Review of a Thesis (Attached Form 1)

Use the designated form (This can be downloaded from our website.)

This form requires your main academic advisor's (registered faculty) seal of approval.

2. 2 Thesis

- ① As a rule, Theses must be prepared in either Japanese or English. In cases where this proves difficult due to extraordinary circumstances, please get the dean's approval beforehand via your main academic advisor, the program director and the course director.
- ② As a rule, Theses for submission shall be printed in black ink on A4 (210 x 297mm) portrait paper with horizontal writing.
- ③ Please write the title of the Thesis, your name and the month and year of submission on the cover of the Thesis. Also, please write the title of the Thesis, your name and the academic year of completion on the

spine of the Thesis (please refer to the illustrated sample).

- ④ The front cover should be followed by the table of contents; please use pagination.
- ⑤ It is desirable for the Thesis to be printed on superior quality white paper using document preparation software, or a typewriter. If they are to be handwritten, please write neatly on manuscript paper using standard style characters for Japanese text and block letters for alphanumeric text. Copies of manuscripts prepared in this way are also acceptable.
- ⑥ With regard to composition and format of the Thesis, the first page should be the same as the cover (depending on the course, you may be required to include names of your academic advisors between the date of submission and the name of your course). This should be followed by 1-2 pages with the thesis summary (or abstract), the table of contents and the body of the text. The thesis should be 30 or more pages in total. Single-sided printing is acceptable.
- ⑦ As an example for thesis content, it is normal to include the following sections: an introduction or preface; materials and methods (experiments; analysis); results (experiments; mathematical analysis; trial models; analysis); discussion; conclusions and final comments; future issues for research; references; and reference materials (acknowledgements, supplementary materials or appendices).
- ⑧ Theses should be bound on the left with a front and back cover. This may be submitted in a file.

\*Please don't include any personal information (family register, date of birth, student ID number, etc.) in your paper. (Please don't include personal information about family members or friends, especially in the acknowledgments.)

#### ○ Sample of a cover and spine

<div data-bbox="220 1173 245 1458">Master's Thesis Title</div> <div data-bbox="220 1693 245 1890">Name (20xx)</div>	<div data-bbox="308 1234 724 1267">Graduate School of Horticulture Chiba University</div> <div data-bbox="414 1279 617 1312">Master's Thesis</div> <div data-bbox="477 1397 555 1435">Title</div> <div data-bbox="422 1471 608 1505">February 20xx</div> <div data-bbox="312 1762 718 1796">Division of Environment and Horticulture</div> <div data-bbox="477 1809 555 1843">Course</div> <div data-bbox="481 1856 550 1890">Name</div>
---	--

## 2. 3 About the Format of the Electronic File

- 1) The dissertation will be published in PDF format, so please submit it in PDF (PDF/A (ISO-19005)).
- 2) Please submit the text in the form of a single electronic file that includes a cover page, table of contents, diagrams, etc.
- 3) About the settings for the PDF file

To ensure long-term readability, storability and accessibility, please make sure of the following.

- The font format is not dependent on a particular computer model.  
(Please do not use the original font which is made by the maker and is not based official standard.)
- The file does not refer to an external information source (external font, etc.).
- No encryption, password, or printing restrictions, etc. have been set.

### 4) About the File Name

Please create the file name as follows.

- HA + \_ (underbar) + student ID number  
(Examples of file names : HA\_20HM0000)

(別紙様式 1)  
(Attached Form 1)

Date: 年 月 日

## 学位（修士）論文等審査申請書 Application for Review of Master's Thesis

千葉大学大学院園芸学研究科長 殿  
To: The Dean of Chiba University Graduate School of Horticulture

千葉大学大学院園芸学研究科の博士前期課程学位（修士）に関する細則に基づき、下記学位論文等の審査及び最終試験を受けたいので申請します。

In accordance with Chiba University Graduate School of Horticulture Regulations for Master's Degrees, I hereby request a review and final examination of the thesis described below.

1. 申請者 環境園芸学専攻 \_\_\_\_\_ コース  
Applicant Division of Environment and Horticulture Course: \_\_\_\_\_

(ふりがな)

\_\_\_\_ 年度入学 学生証番号 \_\_\_\_\_ 氏名 \_\_\_\_\_ 印  
Year of Enrollment Student ID No. Name Seal

2. 題名（外国語の場合は、その和訳を併記）  
Title of Thesis (foreign language titles must be accompanied by a Japanese translation)

3. 概要（600字程度）  
Abstract (Approx. 300 words)

4. 学位の専攻分野の名称 修士（ ）  
Degree name Master of

主任研究指導教員氏名 \_\_\_\_\_ 印  
Name of Main Academic Advisor Seal

## Steps and Procedures for Doctoral Defense

Reviews of doctoral theses are conducted in accordance with the following procedures based on the Graduate School of Horticulture's Policy for the Conferment Degrees and the Degree Review Criteria for Doctoral programs (For a degree earned by completing a doctoral program).

Schedules may differ from year to year, so please refer to the schedule for the academic year in question.

The schedule and necessary forms are posted on the Graduate School of Horticulture website.

### 1) Discussion with your Main Academic Advisor

Please discuss your application for a preliminary review of your thesis with your main academic advisor, and get his/her approval. The academic degree conferred are, Doctor of Philosophy(Agriculture) or Doctor of Philosophy(Philosophy) in Horticultural Science Course, and Doctor of Philosophy(Landscape Architecture) or Doctor of Philosophy(Philosophy) in Landscape Course.

### 2) Applications for Preliminary Thesis Review

Please submit application documents, etc. for preliminary reviews to the Academic Affairs Desk.  
Refer to [1. Documents for Submission] for information on documents required for an application.

### 3) Preliminary Thesis Reviews

Theses are reviewed beforehand to determine whether or not they are worthy of a degree review.  
Theses are reviewed by four or more faculty members, including your main academic advisor.  
Meetings are held for, the presentation of the Thesis contents.  
You will proceed to a thesis review once your thesis has been judged worthy of a degree review.

### 4) Applications for Thesis Review (January for March completion; July for September completion)

Please submit application documents, etc. for a thesis review to the Academic Affairs Desk after receiving approval from your main academic advisor.  
Refer to [1. Documents for Submission] for information on documents required for an application.

### 5) Thesis Reviews

Theses are reviewed to determine whether or not they are worthy of a degree. The degree to be conferred is decided. A review committee is established each time a thesis is submitted, and theses are reviewed by four or more committee members. The review committee conducts the thesis review and holds an open meeting for the thesis presentation.

### 6) Whether or not a student passes is determined within their course based on the review committee's recommendation.

### 7) Submission of final thesis

Following conferment of your degree, publication will be carried out using CURATOR (Chiba University Repository for Access to Outcomes from Research). Please therefore submit the data for the entire text of your thesis to the Academic Affairs Desk. For further details please refer to "4. Guidelines on the Preparation of Documents (for Submission of Final Thesis)."

8) Decisions on completion are made by the Faculty Council.

9) Conferment of Degrees on Students Successfully Completing their Studies.

As a rule, degrees are conferred in March and September.

## 1. Documents for Submission

1. 1 Applications for a preliminary review (submit 1 to the Academic Affairs Group, others to your main academic advisor)

Documents for Submission	No. of Copies (where there are four reviewers)	Preparation Guidelines #
Application for a Preliminary Thesis Review	1	2. 1
Thesis (for preliminary review)	1 + 4	2. 2
List of Papers (for preliminary review)	1 + 4	2. 3
Summary of Thesis Contents	1 + 4	2. 4
Publications and Reference Papers	1 + 4	2. 5

1. 2 Application for a thesis review (submit 1 to the Academic Affairs Group, others to your main academic advisor)

Documents for Submission	No. of Copies (where there are four reviewers)	Preparation Guidelines #
Application for a Thesis Review	1	3. 1
Thesis	1 + 4	3. 2
List of Papers	1 + 4	3. 3
Summary of Thesis Contents	1 + 4	3. 4
Curriculum Vitae	1 + 4	3. 5
Publications and Reference Papers	1 + 4	3. 6
Letter of Consent	1 copy of each	3. 7

1. 3 Submission of final thesis (submission of data to the Academic Affairs Desk)

To be submitted	Quantity	Preparation Guidelines #
The data for the entire text of the doctoral thesis (If it is not possible to publish the entire text of the thesis, submit the data for an abstract)	One CD-ROM	4
Confirmation of Internet Publication of Doctoral Dissertation	1	4

1. 4 Cautions regarding applications

Once submitted, documents, etc. cannot be changed. Moreover, as a rule, submitted documents are not returned. However, specimens, etc. may be returned provided a request is submitted beforehand.

## 2. Guidelines on the Preparation of Documents (applications for preliminary review)

Please use a typewriter document preparation software on a computer to prepare documents. If they are to be written by hand, please write neatly using standard style characters for Japanese text and block letters for alphanumeric text.

## 2. 1 Application for Thesis Reviews (Preliminary Form 1)

Use the designated form (this can be downloaded from our website).

## 2. 2 Thesis (for preliminary review)

- 1) As a rule, theses for submission (for preliminary review) must be written in Japanese or English. In cases where this proves difficult due to extraordinary circumstances, please receive the dean's approval via your main academic advisor, the program director and the course director.
- 2) As a rule, theses for submission should be printed in black ink on A4 (210 x 297mm) portrait paper with horizontal writing.
- 3) Theses should be bound on the left with a front and back cover. However, a file may be used for theses for preliminary review.
- 4) Please print the thesis title, your name, etc. on the front cover (please refer to the illustrated example).
- 5) The front cover should be followed by the table of contents; include pagination.
- 6) It is desirable for theses to be printed on superior quality white paper using document preparation software, a typewriter may also be used. If they are to be handwritten, please write neatly on manuscript paper using standard style characters for Japanese text and block letters for alphanumeric text. Copies of manuscripts prepared in this way are also acceptable.
- 7) Bind reprints, manuscripts for submission or manuscripts for copyediting (or copies), and write your name and the fact that they are publications on the front cover and submit them. For papers that have not been published but have been accepted for publication by an academic society, etc., please affix the relevant notification or certifying document (or copy) to the first page of a copy of the manuscript for submission or the manuscripts for copyediting.

### <Samples of the Front Cover, Spine and Title Page for a Doctoral Thesis>

- Always write “(Dissertation for Review by Chiba University)” on the top line on the title page (see below).
- The month of submission for students completing their studies in the Spring Semester is July and for those completing in the Fall Semester is January.

\*Please don't include any personal information (family register, date of birth, student ID number, etc.) in your paper. (Please don't include personal information about family members or friends, especially in the acknowledgments.)

(Thesis Cover)	Title Page (First Page of the Thesis)
<div> <p>T I T L E</p> <p>January 20xx</p> <p>※ ↑ Month/Year of Submission</p>   <p>N A M E</p>   <p>Graduate School of Horticulture</p> <p>CHIBA UNIVERSITY</p> </div>	<div> <p>(千葉大学審査学位論文) ※←Japanese</p> <p>T I T L E</p> <p>January 20xx</p> <p>※ ↑ Month/Year of Submission</p>   <p>N A M E</p>   <p>Graduate School of Horticulture</p> <p>CHIBA UNIVERSITY</p> </div>

Use the designated form (this can be downloaded from our website).

Do not write anything in the space provided for “Report No.”.

#### 1) Thesis Title

Ensure this is the same as the title of the thesis for submission (for preliminary review).

Write the subtitle, if there is one. Foreign language titles should be accompanied by a Japanese translation.

#### 2) Publications

List publications relevant to the theme of the thesis (papers published in refereed journals). Papers that have been submitted and accepted for publication subsequent to review are recognized as equivalent to publications, but papers that have simply been accepted as a submission are not eligible. Please submit reprints for papers listed.

#### 3) Method and Date of Publication for Unpublished Work

It is assumed that theses will be published in their entirety. If undisclosed content remains after the content of previous publications is accounted for, please indicate the method and date of its publication. The undisclosed content can be published in the future together with previously published content.

#### 4) Other Reference Papers

Papers other than the thesis (including publications) should be listed as such at the discretion of the applicant submitting them. Please submit reprints for listed papers.

When submitting supporting papers for your thesis, please write the title of the paper and ensure it is clearly marked “Supporting Paper”.

When submitting specimens, etc., in addition to filling in this space, please indicate whether you wish to have them returned or not.

### 2. 4 Summary of Thesis Contents (for Preliminary Review) (Attached Form 3)

Use the designated form (this can be downloaded from our website).

Please summarize your thesis in approximately 300 words.

### 2. 5 Other Reference Papers, Etc.

1) Assemble reprints, manuscripts for submission or manuscripts for copyediting of reference papers and submit them in a manner that indicates they are reference papers (copies are acceptable). When the content is divided between two or more papers, please fasten them together for submission.

2) Papers pertaining to a different line of research than the thesis may be submitted as a reference for the review. Such papers are referred to as supporting papers. Supporting papers should be prepared in the same way as theses (for preliminary review) and bound separately, published material are acceptable. Supporting papers should have a front cover with the paper’s title, and the applicant’s name and affiliation written on it. The front cover for papers that have been published should also include the name, volume, number, page and date of publication of the journal in which it was published and the name of the author (including co-authors).

3) There are no rules on the number of specimens, etc. to be submitted, but please consult the Academic Affairs

Desk about what you will submit beforehand and get their approval. Please attach a very detailed list of what you are submitting.

### 3. Guidelines on the Preparation of Documents (for applications for thesis review)

General cautions regarding the preparation of documents are the same as for 2. Guidelines on the Preparation of Documents (for applications for preliminary review)

#### 3. 1 Application for a Thesis Review (Attached Form 1)

Use the designated form (this can be downloaded from our website).

This form requires your main academic advisor's (registered faculty) seal of approval.

#### 3. 2 Thesis

- 1) As a rule, theses must be prepared in either Japanese or English. Applicants wishing to prepare their thesis in another language due to extraordinary circumstances may only do so if they have received the dean's approval prior to applying for preliminary review.
- 2) As a rule, theses for submission shall be printed in black ink on A4 (210 x 297mm) portrait paper with horizontal writing.
- 3) Theses should be bound on the left together with a soft cover.
- 4) The front cover should be followed by the title page and the table of contents; including pagination.
- 5) It is desirable for theses to be printed typed on superior quality white paper. If they are to be handwritten, please write neatly on manuscript paper using standard style characters for Japanese text and block letters for alphanumeric text. Manuscripts prepared in this way may be copied onto superior quality white paper (suitable for long term storage).
- 6) Submission of publications is the same as for preliminary review.

#### 3. 3 List of Papers (Attached Form 2)

The same guidelines as those for the list of papers for preliminary review (2.3) apply.

If anything was changed after applying for preliminary review, please specify.

#### 3. 4 Summary of the Thesis Contents (Attached Form 3)

The same guidelines as those for preliminary review (2.4) apply.

#### 3. 5 Curriculum Vitae (Attached Form 4)

- 1) Used the designated form (this can be downloaded from our website).
- 2) Write your name as it appears on your family register, write the furigana reading for it, and either sign or set your seal on it.
- 3) Foreign citizens should write their country name in full in the space provided for domicile.
- 4) For the date of birth, Japanese citizens should use the era name and foreign citizens should use the western calendar.
- 5) Write your current address in full (e.g. include your apartment name and number).
- 6) Divide your personal history into two sections: academic history and work history, and list chronologically.

- 7) When writing your academic history, please list your academic history starting with high school. Specify enrollment date, graduation date, including faculty department and graduate school.
- 8) For work history, please write your employer, where you worked, your job title, etc., and write “(to date)” at the end of the line for your current job.
- 9) If all of your information cannot fit on the designated form, please write the remaining information on a separate piece of paper and fasten them together.
- 10) One original (with your seal) and four duplicates of your curriculum vitae are required. The duplicate can be a copy of the original made on superior quality white paper of the same size.

### 3. 6 Other Reference Papers

Preparation of reference papers and supporting papers shall be the same as for preliminary reviews.

There are no rules on the number of specimens, etc. to be submitted, but please consult the Academic Affairs Desk about what you will submit beforehand and get their approval.

Please attach a very detailed list of what you are submitting.

### 3. 7 Letter of Consent (Attached Form 5)

Use the designated form (this can be downloaded from our website).

When a publication forming the basis of the thesis (including papers that have been accepted for publication) has multiple authors, you need the consent of the authors if it is to be used in (partial) fulfillment of your Doctoral Thesis. In such cases, please submit a Letter of Consent with the names and seals of all co-authors.

A Letter of Consent is needed for each paper (when a number of reports have the same title, a Letter of Consent is needed for each report).

## 4. Guidelines on the Preparation of Documents (for Submission of Final Thesis)

The Academic Degree Regulations (Ministry of Education Ordinance No. 9 of April 1, 1953) allow for individuals who have received a doctoral degree to obtain the cooperation of a university (or the National Institution for Academic Degrees and University Evaluation) and publish the entire text of the dissertation related to the degree by using the Internet.

At this university, publication is carried out using CURATOR (Chiba University Repository for Access to Outcomes from Research). Therefore, please fill in the necessary information on **Confirmation of Internet Publication of Doctoral Dissertation (Form 1)** and then submit this form, together with the data for the entire text of the doctoral dissertation, to the student affairs desk of the relevant graduate school.

Moreover, if there is a reason that makes it impossible to publish the entire text of the dissertation within one year from the day the degree was granted, the individual may, upon receiving approval from the graduate school to which he or she belongs, publish an abstract of the dissertation rather than the entire text. Information about such reasons is available on the Chiba University website.

If you designate the start date for publication as “Undetermined” and publish an abstract, then, when the reason that made publishing the entire text impossible ceases to exist, please promptly submit **Report Related to Internet Publication of Doctoral Dissertation (Form 2)** to the graduate school in which the dissertation was reviewed.

Moreover, applicants for a degree will be responsible for checking on rights and taking the other steps necessary at the

time of Internet publication.

#### 4. 1 About the Format of the Electronic File

- 1) The dissertation will be published in PDF format, so please submit it in PDF (PDF/A (ISO-19005)).
- 2) Please submit the text in the form of a single electronic file that includes a cover page, table of contents, diagrams, etc.
- 3) About the settings for the PDF file

To ensure long-term readability, storability and accessibility, please make sure of the following.

- The font format is not dependent on a particular computer model.  
(Please do not use the original font which is made by the maker and is not based official standard.)
- The file does not refer to an external information source (external font, etc.).
- No encryption, password, or printing restrictions, etc. have been set.

#### 4) About the File Name

Please create the file name as follows.

- HA + \_ (underbar) + student ID number  
(Examples of file names : HA\_20HD1234)

\* If you wish to publish an abstract, at the end of the file name enter \_ (underbar) + Y.

(Examples of file names : HA\_20HD1234\_Y)

#### 4. 2 Miscellaneous

FAQs and other information useful when registering your dissertation in CURATOR are provided on the Chiba University website. ([http://www.chiba-u.ac.jp/education\\_research/index.html](http://www.chiba-u.ac.jp/education_research/index.html))

#### 4.. 3 Example of entries on a CD-R

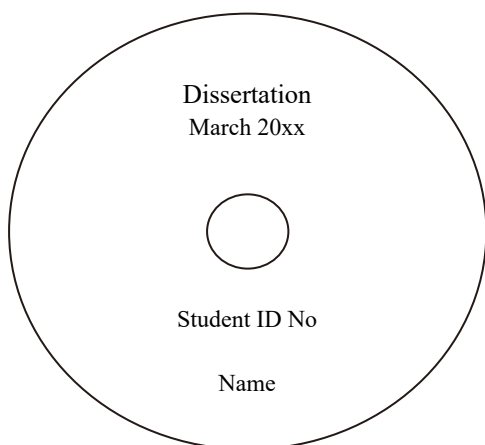

※Please do not describe personal information (family register, birthday, student ID number) in your thesis.  
(In particular, please do not describe your family and friends personal information in acknowledgments. )

(別紙様式一予1)  
(Preliminary Form 1)

年 月 日  
Date : \_\_\_\_\_

大学院園芸学研究科  
To: The Main Academic Advisor,  
主任研究指導教員 殿  
The Graduate School of Horticulture,

大学院園芸学研究科  
The Graduate School of Horticulture  
環境園芸学専攻 コース  
Division of Environment and Horticulture  
Course: \_\_\_\_\_  
氏名 印  
Name

学位論文予備審査願  
Application for Preliminary Review of a Thesis

学位申請論文の予備審査のため、下記の論文及び関係書類を添えて提出しますので、予備審査をお願いします。

I hereby submit the following thesis, together with related documents, and request a preliminary review.

記

学位論文予備審査願	1 部
Application for Preliminary Review of a Thesis	1 Copy
学位論文（予備審査用）	4 部
Thesis (for preliminary review)	4 Copies
論文目録（予備審査用）	4 部
List of Papers (for preliminary review)	4 Copies
論文内容の要旨	4 部
Summary of Thesis	4 Copies
その他参考論文等	4 部
Other Reference Papers	4 Copies

(別紙様式－１)  
(Attached Form 1)

年 月 日  
Date: \_\_\_\_\_

大学院園芸学研究科長 殿  
To: The Dean of the Graduate School of Horticulture

大学院園芸学研究科  
The Graduate School of Horticulture  
環境園芸学専攻 コース  
Division of Environment and Horticulture  
Course: \_\_\_\_\_  
氏名 印  
Name

学 位 論 文 審 査 願  
Application for a Thesis Review

千葉大学大学院園芸学研究科の博士後期課程学位（博士）に関する細則第２条の規定に基づき、下記の論文及び関係書類を添えて提出しますので、博士（ ）の審査をお願いします。  
In accordance with Article 2 of the Chiba University Graduate School of Horticulture Regulations for Doctor's Degrees, I hereby submit the following thesis, together with related documents, and request a review for the degree of Doctor of ( ).

記

学位論文	5 部
Thesis	5 Copies
論文目録	5 部
List of Papers	5 Copies
論文内容の要旨	5 部
Summary of Thesis	5 Copies
履歴書	5 部
Curriculum Vitae	5 Copies
その他参考論文等	各 5 部
Other Reference Papers, Etc.	5 Copies of Each
承諾書	1 報につき 1 部
Letter of Consent	1 Copy of Each

主任研究指導教員承諾印  
Main Academic Advisor's Seal of Consent  
氏名 印  
Name Seal

(別紙様式－ 2 )

(Attached Form 2)

# 論文目録

## List of Papers

No. 1

報告番号 Report No.	千大院園博甲第 Chiba University Graduate School Doctoral Thesis No.	氏 名 Name	
<p>1. 学位論文 Thesis</p> <p>1) 題名 Title</p> <p>2) 既公表論文（著者名：論文名，発表誌，巻，号，頁，発表年月） Publications (Author(s): Title, Journal, Volume, Number, Page, Month/Year of Publication)</p> <p>3) 未公表部分の公開方法及び時期 Method and date of future publications of unpublished parts. 方法 Method 時期 Date</p> <p>2. 参考論文（著者名：論文名，発表誌，巻，号，頁，発表年月） Reference Papers (Author(s): Title, Journal, Volume, Number, Page, Month/Year of Publication)</p>			

(別紙様式－３)  
(Attached Form 3)

年 月 日  
Date: \_\_\_\_\_

## 学位（博士）論文内容の要旨 Summary of Thesis

1. 論文申請者 環境園芸学専攻 \_\_\_\_\_ コース  
Thesis Applicant Division of Environment and Horticulture Course : \_\_\_\_\_  
(ふりがな)  
\_\_\_\_\_ 年度入学 学生証番号 \_\_\_\_\_ 氏 名 \_\_\_\_\_  
Year of Enrollment Student ID No. Name
2. 論文題名（外国語の場合は、その和訳を併記）  
Title of Thesis (foreign language titles must be accompanied by a Japanese translation)
3. 論文概要（６００字程度）  
Abstract (Approx. 300 words)

4. 学位に付記する専攻分野の名称 博士（ ）  
Degree Name Doctor of

主任研究指導教員氏名 \_\_\_\_\_  
Name of Main Academic Advisor

(別紙様式－４)  
(Attached Form 4)

履 歴 書  
Curriculum Vitae

ふりがな 氏 名 Name		印 Seal	男 Male ・ 女 Female	本 籍 (都道府県名のみ記入) (外国籍の場合は国籍)	
Date of Birth: 年 月 日生 (満 歳) (Age: )				Domicile (Nationality for foreign citizens)	
現住所 Current Address	〒 Tel E-Mail @				
	年 Year	月 Month	事項 (学歴と職歴を区分して記入) Divide your personal history into two sections: academic history and work history		

(別紙様式－５)  
(Attached Form 5)

承 諾 書  
Letter of Consent

論文題名  
Title of Thesis

発表の方法及び時期  
Date & Method of Publication

発表年月日 年 月 日  
Date of Publication (Month / Day / Year)

発表誌名  
Journal Name

巻、号 第 巻 第 号  
Volume and Number Volume: Number:

頁 頁～ 頁掲載  
Pages From Page ~ Page

著者名  
Author's Name(s)

上記の論文を\_\_\_\_\_の学位申請の主論文として提出することに異議は  
ありません。

I have no objection to submission of the abovementioned paper as the main thesis for the  
degree application to be submitted by \_\_\_\_\_.

年 月 日  
Date

氏名  
Name

印  
Seal/Signature

印

印

印

印

## 5 . Administrative Procedures

The “Faculty of Horticulture Academic Affairs Group” handles administrative procedures for the Graduate School of Horticulture.

Administrative procedures comprise those provided for in regulations, etc. and those that are specified by posting a notice as the need occurs.

The main academic procedures are as follows:

### 1 ) Payment of Tuition

University tuition is paid via a “Bank Transfer (proxy payment) System” (automatic bank account debit).

### 2 ) Issuance of various certificates (Academic Affairs Group)

The following certificates can be issued. Applications must be submitted either at the desk for the Academic Affairs Group or by mail. For applications by mail, please look at the Chiba University Graduate School of Horticulture and Faculty of Horticulture website (<http://www.h.chiba-u.jp/>) → [Graduates] → [Issuance of Certificates]. Japanese certificates take approximately three days and English certificates take approximately two weeks to be issued.

Academic Transcript

Certificate of Expected Completion

Certificate of Completion

Certificate of Enrollment



Final year students can have these issued by automatic issuing machines. (only in Japanese)

### 3 ) Notifications and Requests

Report on Student Information

Study Plan

Application for Recognition of Credits Earned Prior to Enrollment



Promptly and by April 30th (October 31st for October enrollment)

Request for Research Guidance at another Graduate School

Request for a Leave of Absence

Request for Extension of Leave of Absence

Request for Permission to Resume Studies

Request to Withdraw from the Graduate School



Academic Affairs Group (Accepted at all times)

Notification of Changes in a Student’s Current Address/

Guarantor’s Current Address/Domicile/Family Name/Guarantor

Request for a Reissue of a Student ID Card



Student Affairs (Accepted at all times)

Student Discount Travel Card

Automatic Issuing Machine

### **Leave of Absence**

Students who are unable to engage in study for a period of two or more months due to illness or some other reason may submit a request to the University President and receive permission for a leave of absence (please attach a medical certificate when illness is the reason).

The total period of leaves of absence may not exceed two years for a Master's Course or three years for a Doctoral Course.

The period of leaves of absence is not included in the maximum period of enrollment.

Students wishing to resume their studies upon completion of a leave of absence, or during a leave of absence when the reason for it no longer applies, may do so upon receiving permission from the University President (when the reason was illness, a medical certificate from a doctor is necessary).

When considering a leave of absence, please consult the Academic Affairs Group and your academic advisors as soon as possible.

### **Withdrawal from the Graduate School**

Students wishing to withdraw from the Graduate School must submit a request to the University President and receive permission to do so. Should circumstances requiring you to withdraw from the Graduate School arise, please consult your academic advisors and notify the Academic Affairs Group as soon as possible. Please note that tuition for the term in which you request to withdraw from the Graduate School must be paid, so please consult the Academic Affairs Group as soon as possible to ensure you can request withdrawal before the next term begins.

### **4) Early Completion System**

Students who achieve outstanding grades and meet all specified requirements may complete their studies on a Master's Program or a Doctoral Program in the Graduate School early after a period of enrollment of one or more years. Students wishing to complete their studies early should consult their academic advisors.

### **5) Long-term Student System**

Students with jobs or other circumstances that lead them to believe they cannot complete the necessary courses within the standard two-year limit on the period of study for a Master's Program or the standard three-year limit on the period of study for a Doctoral Program in the Graduate School may apply for the long-term student system and submit to screening. Students wishing to benefit from the long-term student system should consult their academic advisors.

### **6) Day and Evening Course System**

The Graduate School, in cases deemed especially necessary for the purpose of education, may offer classes and research guidance in the evening or at other specified times, and recognize the attainment of credits. Students wishing to make use of the day and evening course system should consult with their academic advisors and the faculty responsible for the course, and apply to the Academic Affairs Group.

### **7) Credit Transfers in Horticultural Fields**

Students enrolled in the Graduate School who earn credits at another university's graduate school with which Chiba University has a Credit Transfer Agreement may apply to have such credits transferred.

## **8) About the Credit Transfer Agreement between Graduate Schools of 6 Universities**

Graduate schools of the six universities mentioned below have concluded a credit transfer agreement for purposes of expanding their curricula by respecting the characteristics of each other's education and research and promoting mutual exchanges and cooperation. Based on this agreement, when a student wishes to take a course at another graduate school and obtain credit, the dean of that graduate school may accept the student. For details, please contact the Academic Affairs Group.

Chiba University Graduate School of Horticulture, Chiba University Graduate School of Science and Engineering, Chiba University Graduate School of Science, Chiba University Graduate School of Engineering, Niigata University Graduate School of Science and Technology, Kanazawa University Graduate School of Natural Science & Technology, Okayama University Graduate School of Natural Science and Technology, Okayama University Graduate School of Environmental & Life Science, Nagasaki University Graduate School of Science and Technology, Nagasaki University Graduate School of Engineering, Nagasaki University Graduate School of Fisheries Science and Environmental Studies, Kumamoto University Graduate School of Science and Technology

## **9) Specially Registered Non-degree Student System**

Examination, enrollment and tuition fees shall not be collected from students in the Graduate School enrolling in the Faculty of Horticulture as Specially Registered Non-degree Students.

## 6 . Regulations for the Chiba University Graduate School of Horticulture

### Regulations for the Chiba University Graduate School of Horticulture

#### Article 1 (Purpose)

These regulations, based on the provisions of Article 55 of the Rules for Chiba University Graduate Schools (hereinafter referred to as the “Rules”), stipulate necessary matters pertaining to Chiba University Graduate School of Horticulture (hereinafter referred to as the “Graduate School”).

#### Article 2 (Programs)

1. The Graduate School’s program shall be a 5-year graduate program.
2. The graduate program shall be divided into a first stage 2-year program (hereinafter referred to as the “Master’s Course”) and a second stage 3-year program (hereinafter referred to as the “Doctoral Course”). The Master’s Course shall be handled as an independent program.

#### Article 3 (Purpose of the Graduate School)

1. The Graduate School aims to foster students with a deep, wide-ranging knowledge, the ability to put things into practice and a sense of ethics who are capable of engaging in independent research pertaining to horticulture and addressing diverse social issues.
2. Master’s Courses aim to deepen knowledge in specialized fields, and nurture a high level of technical skill and the research capabilities associated with the ability to apply wide-ranging knowledge in a broad range of fields, an essential skill for jobs requiring high levels of expertise.
3. Doctoral Programs aim to impart even more specialized knowledge, to cultivate interdisciplinary and integrated perspectives, and to foster students with the advanced capabilities and ethics required to engage in institutional management or independent research activities as a researcher or administrative coordinator.

#### Article 4 (Divisions, Enrollment Capacities, Etc.)

The Graduate School’s divisions and enrollment capacities are as shown in the following table.

Division	Course of study	Master’s Program		Doctoral Program	
		1st-year enrollment capacity	Total enrollment capacity	1st-year enrollment capacity	Total enrollment capacity
Environment and Horticulture	Horticultural Science	1 0 5	2 1 0	1 8	5 4
	Landscape				

#### Article 5 (Changing Graduate School)

1. Students enrolled at Chiba University Graduate School who wish to transfer to this Graduate School may be permitted to do so following screening.
2. Students enrolled at this Graduate School who wish to transfer to another graduate school (including other academic institutions) at Chiba University Graduate School must submit an application to the dean of the Graduate School specifying reasons for the change and receive permission.

#### Article 6 (Educational Programs and Rules for Taking Courses)

1. Education at the Graduate School shall be conducted by providing course instruction as well as guidance in thesis preparation, etc. (hereinafter referred to as “Research Guidance”).
2. The courses, the number of credits for each course, the rules for taking courses, etc., shall be in accordance with the provisions set forth in the Chiba University Graduate School of Horticulture Syllabus.
3. The Chiba University Graduate School of Horticulture Syllabus mentioned in the previous paragraph shall be prepared new each academic year and shall apply to the students enrolling that year.
4. To guide the study and research of students, the faculty council shall assign multiple academic advisors to each student.
5. Before taking elective courses, students must obtain guidance from their academic advisors.
6. In addition to the provisions set forth in the preceding paragraphs, other provisions necessary for students’ study and research shall be established elsewhere.

#### Article 7 (Long-Term Educational Program)

1. When, based on the provisions of Article 28 of the Rules, students at the Graduate School provide notice that because they are employed or due to other circumstances they would like to complete a planned educational program that extends over a longer period than usual, they may be permitted to conduct such planned study.
2. Students who wish to undertake the planned study mentioned in the previous paragraph shall apply to the dean of the Graduate School, specifying the reason, and granted permission.

#### Article 8 (Standards for Calculating Credits)

Credits for Graduate School courses shall be calculated according to the following standards.

- (1) For lectures and seminars, students shall earn 1 credit for each 15 hours of instruction.
- (2) For laboratory work and practical training, students shall earn 1 credit for each 30 hours of instruction.
- (3) When classes are held using both of the previous two standards, students shall earn 1 credit for a number of hours of instruction corresponding to that ratio, and that number of hours shall be determined elsewhere based on a decision by the faculty council.

#### Article 9 (Special Systems for Teaching)

1. The Graduate School, when deemed necessary for the purpose of education, shall provide special systems for education, such as providing instruction or research guidance in the evening or at some other special time or period.
2. Provisions required for special systems for education shall be established elsewhere.

#### Article 10 (Testing and Awarding of Credits)

1. Students who take courses at the Graduate School shall be tested, and those who pass the tests shall be awarded credits.
2. Testing shall be conducted by means of examinations, research reports, etc.
3. Students who are unable to take a regular examination due to illness or some other reason may request a makeup examination.

#### Article 11 (Taking Courses at Other Graduate Schools, Etc.)

1. When students at the Graduate School, based on the provisions of Article 29 of the Rules, wish to take courses at another university's graduate school or another Chiba University graduate school (hereinafter collectively referred to as "Other Graduate Schools"), they shall apply to the dean of the Graduate School via their academic advisors and be granted permission.
2. Students in the Master's Course may obtain up to 15 credits from courses taken based on the provisions of the previous paragraph, while students in the Doctoral Course may obtain up to 4 credits.

#### Article 12 (Research Guidance at other Graduate Schools)

1. When students at the Graduate School, based on the provisions of Article 30 of the Rules, wish to receive research guidance at Other Graduate Schools or other research institutes, etc., they shall apply to the dean of the Graduate School via their academic advisors and be granted permission. However, the period in which Master's Course students receive such research guidance may not exceed 1 year.
2. Research guidance received based on the provisions of the previous paragraph shall be considered equivalent to research guidance received at the Graduate School.

#### Article 13 (Studying Abroad)

1. When students at the Graduate School, based on the provisions of Article 17 of the Rules, attend a foreign graduate school, the provisions of the previous two articles shall apply.
2. The period for studying abroad shall be limited to 1 year for Master's Course students and 2 years for Doctoral Course students, and shall be counted as part of the maximum number of years of enrollment stipulated in Article 6 of the Rules, and as part of the period for completing requirements stipulated in Article 15 of the Rules.

#### Article 14 (Acceptance of Credits Obtained Prior to Matriculation)

1. When students at the Graduate School, based on the provisions of Article 31 of the Rules, wish to have credits obtained prior to enrollment at the Graduate School, they shall, based on provisions established elsewhere, apply to the dean of the Graduate School via their academic advisors.
2. Except for students transferring into the Graduate School from another graduate school, the number of credits accepted based on the provisions of the previous paragraph shall not exceed 15 for Master's Course students and 4 for Doctoral Course students. However, for students in the Master's program, the total number of credits may not exceed 20 credits, including the number of credits deemed to have been acquired in the Graduate School pursuant to the provisions of Article 29, Paragraph 1 of the Graduate School Regulations.

#### Article 15 (Requirements for Program Completion)

1. The requirements for completing the Master's Program are to be enrolled in the program for at least 2 years; to obtain at least 30 credits in Course of Horticultural Science or 34 Credits in Course of Landscape ; to receive the required research guidance; and to pass the review and final examination of the master's thesis or the outcome of research on a specific theme (hereinafter referred to as "Research Results"). However, students with superior grades may complete the program after being enrolled for no less than 1 year.
2. The requirements for completing the Doctoral Program are to be enrolled in the program for at least 5 years (including, for students who were enrolled in the Master's Program for at least 2 years and completed that program); to obtain at least 30 credits in Course of Horticultural Science or 34 Credits in Course of Landscape in the Master's Program and at least 14 credits in the Doctoral Program; to receive the required research guidance; and to pass the review and final examination of the doctoral thesis. However, students with superior grades may complete the Program after being enrolled in the Graduate School for at least 3

years (including, for students who were enrolled in the Master's Program for at least 2 years and completed that program).

3. For students who complete the Master's Program in accordance with the provision for early completion at the end of Paragraph 1, the following changes should be made in the requirements for program completion in Paragraph 2: the phrase "5 years (including, for students who were enrolled in the Master's Program for at least 2 years and completed that program)" should be changed to "a period comprising the enrollment period in the Master's Program plus 3 years"; and the phrase "3 years (including, for students who were enrolled in the Master's Program for at least 2 years and completed that program)" should be changed to "3 years (including the enrollment period in the Master's Program)." The other provisions of Paragraph 2 shall apply as is.
4. Regardless of the provisions of Paragraph 2 and the previous paragraph, the requirements for completing the Program for individuals who correspond to Sections 2-8, Paragraph 2, Article 9 of the Rules and who enroll into the Doctoral Program is to be enrolled in the program for at least 3 years; to obtain at least 14 credits; to receive the required research guidance; and to pass the review and final examination of the doctoral thesis. However, students with superior grades may complete the program after being enrolled for no less than 1 year.
5. If a student is deemed to have acquired credits (limited to those earned after the student has been qualified for admission as stipulated in Article 9, Paragraph 1 of the Graduate School Regulations) prior to enrollment in the Master's Course pursuant to the preceding article, and is deemed to have completed part of the course, he/she may be deemed to have been enrolled in the course for up to one year based on the number of credits, the period of time required to acquire those credits, and other factors.  
However, even in this case, the student must actually be enrolled in the relevant course for at least 1 year.

#### Article 16 (Thesis Submittal Qualifications, Submittal Periods, Etc.)

The submittal qualifications, submittal periods, review periods, etc., for thesis and Research Results (hereinafter collectively referred to as "Thesis, Etc.") shall be stipulated elsewhere.

#### Article 17 (Review and Final Examination of Thesis)

1. In accordance with the provisions set forth in the Chiba University Regulations for Degrees, the review and final examination of each Thesis, etc. shall be conducted by at least 3 review committee members appointed by the faculty council from among full-time professors at the Graduate School. If necessary, however, faculty other than full-time professors may be selected as committee members.
2. In conferring the master's and doctoral degrees mentioned in the previous paragraph, the words "Agriculture", "Landscape Architecture" or "Philosophy" shall be appended to the name of the degree to indicate the academic field in which the degree is specialized.  
(Please consult Students Affairs Unit.)

#### Article 18 (Conferment of Degrees)

1. In accordance with the provisions set forth in the Chiba University Regulations for Degrees, a master's degree or a doctoral degree shall be conferred upon students who complete the Graduate School's Master's Program or Doctoral Program respectively.
2. In conferring the master's and doctoral degrees mentioned in the previous paragraph, the words "Agriculture" or "Philosophy" shall be appended to the name of the degree to indicate the academic field in which the degree is specialized.

#### Article 19 (Time of Enrollment for Specially Registered Non-Degree Students, Research Students, In-Service Research Students, Special Auditing Students and Special Research Students)

The specially registered non-degree students, research students, in-service research students, special auditing students, and special research students mentioned in Articles 45 through 49 of the Rules shall enroll at the

beginning of either the academic year or the semester. However, enrollment in mid-semester may be allowed for special research students when there are special circumstances and if approved by the faculty council.

#### Article 20 (Faculty Organization)

1. Provisions for the Graduate School's faculty organization shall be stipulated elsewhere based on deliberations conducted by the faculty council.
2. The Graduate School's faculty shall cooperate in conducting education and research in the Faculty of Horticulture.

#### Article 21 (Miscellaneous Provisions)

Besides the regulations set forth herein, other provisions necessary for the Graduate School shall be established elsewhere.

#### Supplementary Provisions

1. These regulations shall go into effect on April 1, 2007.
2. Notwithstanding the provisions of Article 4, the total enrollment capacities for the Master's Course in AY2007, and for the Doctoral Course in AY2007 and AY2008, shall be as follows.

Division	Course of study	Master's Program	Doctoral Program	
		2007/2008	2007/2008	2008/2009
Environmental Horticulture	Bioresource Science	1 0 5	1 8	3 6
	Environmental Science and Landscape Architecture			
	Food and Resource Economics			

#### Supplementary Provision

These regulations shall go into effect on April 1, 2008.

#### Supplementary Provision

These regulations shall go into effect on April 1, 2015.

#### Supplementary Provision

These regulations shall go into effect on April 1, 2018.

#### Supplementary Provision

1. These regulations shall go into effect on April 1, 2020.
2. These new regulations shall not go into effect to Students enrolled on March 31, 2020.
3. Notwithstanding the provisions of Article 4, the total enrollment capacities for the Master's Course in AY2020, and for the Doctoral Course in AY2020 and AY2021, shall be as follows.

Division	Course of study	Master's Program	Doctoral Program	
		2020/2021	2020/2021	2021/2022
Environment and Horticulture	Horticultural Science	1 0 5	1 8	3 6
	Landscape			

Supplementary Provision

1. These regulations shall go into effect on April 1, 2021.
2. The provisions of Article 11, paragraph 2, Article 14, paragraph 2, and Article 15, paragraph 5 after the revision shall apply to students admitted in AY2021, and the provisions then in force shall remain applicable to students admitted in AY 2020 or earlier.

# 2021

## Chiba University Libraries

### Matsudo Library

Because of the COVID-19, there is a possibility that library may be closed or change service hour. For the latest information, please refer to Chiba University Libraries website.

#### User guide

- Matsudo Library consists of 2nd the 3rd floor of Building F.
- As of January 2021, 2nd floor of the library has been closed. Please move from 1st to 3rd floor by using the elevator.
- When you use the library, please bring your student ID.

#### ► Opening Hours

	Terms 1,2,4 & 5	Terms 3 & 6
Monday - Friday	9:00-21:00	9:00-16:50
Sat, Sun & Holidays	10:30-18:00	休館

- ・ Opening hours may change in short notice
- ・ Information will appear on our website or SNS

#### ► Borrowing

	Up to	Period
Undergraduate (Year 1 - 3) , Part time students	5 books	2 weeks
Undergraduate (Year 4) , Graduate & Research students	10 books	3 weeks

- ・ You can renew your due dates of items you are currently borrowing through MyLibrary. (see the next page).
- ・ When you have an overdue item, you will get overdue penalty for the same period of overdue after returning.
- ・ When Matsudo Library is closed, please return books to the Book Drop in front of the Building E.

#### ► Chiba University Libraries website

<https://www.LL.chiba-u.jp/english/index.html>



### Looking for library materials

Using OPAC, you can search through the books and journals that Chiba University Libraries hold. In addition to booklet data, you can also search e-books.

[https://opac.LL.chiba-u.jp/opac/opac\\_search/?lang=1](https://opac.LL.chiba-u.jp/opac/opac_search/?lang=1)



Many electronic journals are available at Chiba University. To search for electronic journals, please select the tab “e- Journal AtoZ” on the page of OPAC,

### MyLibrary

MyLibrary is your personal portal for library services. On the main page of OPAC, there is a link to the MyLibrary log-on page.

Available services.

- Application for book reservation
- Checking status of loan/reservation
- Extension of loan period
- Application for book delivery requests, or copies

[https://opac.LL.chiba-u.jp/opac/opac\\_search/?loginMode=disp&lang=1](https://opac.LL.chiba-u.jp/opac/opac_search/?loginMode=disp&lang=1)



## ■ Academic Link Matsudo

Based on the concept of “Academic Link”, learning environment integrated with “Place”, “Human support” and “Content” are provided. Please make use of them according to your learning style.

### ①Place

#### 2nd Floor: Active Learning Space

- Discussion area without wall.
- Whiteboard wall, movable tables and chairs, and Wireless LAN are available.

#### 2nd Floor: Group Study Room (advance booking is essential)

- Transparent rooms for group working.
- Whiteboard wall, movable tables and chairs, and Wireless LAN are available.

\*As of January 2021, 2nd Floor of the library has been closed.

#### 3rd Floor: Quiet Study Space

- All desks are facing the window.
- Individual study desk, desk lights, power supply and Wireless LAN are available.

## ②Human Support

### Learning Support Desk

Graduate students provide advice for any problem on research and learning.

\*As of January 2021, this has been moved online. Please refer to the following link

### Seminar Sessions for Academic Skills

Lunch time short session “1210 Akarin Hour” and seminar sessions will enhance your research and learning skills.

These programs are held at Active Learning Space on the 2nd floor.

<https://alc.chiba-u.jp/eyr/2020/06/22/01alsals>  
(Japanese Only)



## ③Contents

### Pathfinder shelves for research

Subject resources, including review articles and general books, are collected for each courses. These materials recommended by several faculty staff are expected as a pathfinder for research programs of Faculty of Horticulture.

### Printed Materials

At the 3rd floor, you can find mostly printed collection of our library.

About 80,000 books and periodicals are on the movable shelves.

Copy machine are at the 3rd floor. (Application required)

### Online Resources

Over 17,000 titles of online journals and 29,000 e-books, including course materials, are available via campus network.

Some titles are approved to access from outside of campus under the certain condition. For more details, contact your librarians.

## Contact Us

○Matsudo Library  
Phone: 047-308-8717 (Mon.-Fri. 9:00-17:00)  
E-mail: fbh8716@office.chiba-u.jp

○Academic Link Center  
E-mail: alc-info@chiba-u.jp

# Campus Map

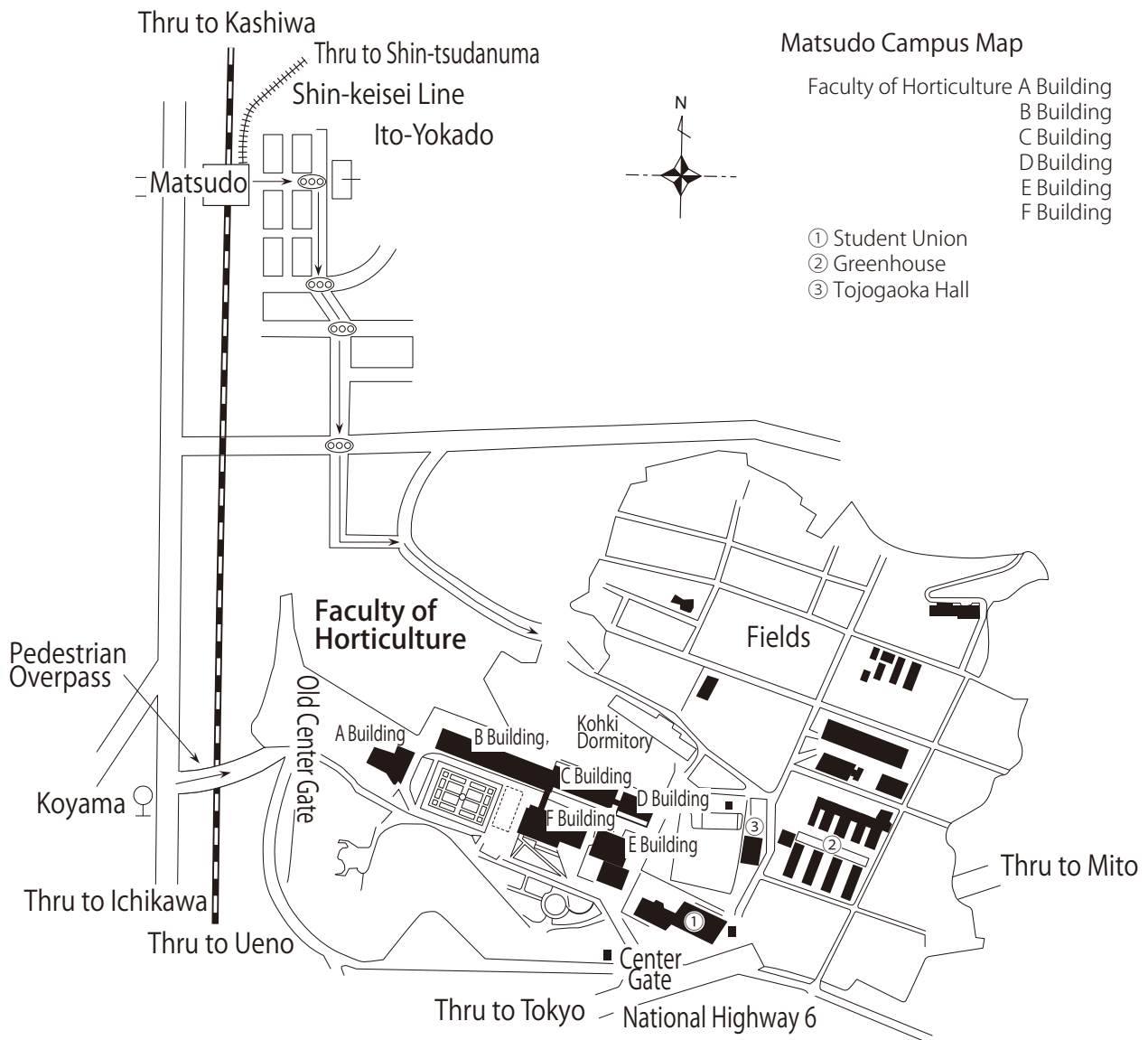

- 15 min. walk from the East Exit of Matsudo Station (JR Joban Line or Shin-keisei Line).
  - ◆ 20 min. ride from JR Ueno Station (JR Joban Line) to Matsudo Station.
  - ◆ 50 min. ride from Keisei-tsudanuma Station (Shin-keisei Line) to Matsudo Station.
- 5 min. walk from Koyama bus stop.
  - ◆ 35 min. ride by bus from JR Ichikawa Station (JR Sobu Line) to Matsudo Station or Matsudo Shako, get off at Koyama bus stop.

園芸学部 A 棟

3 F

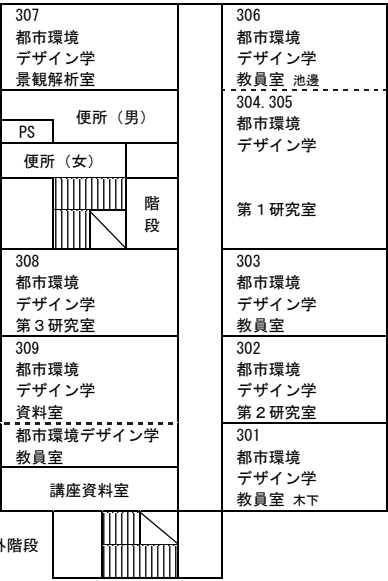
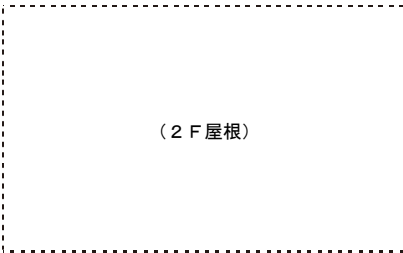

2 F

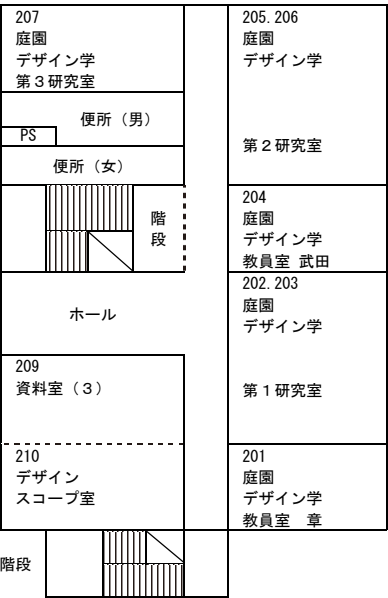

1 F

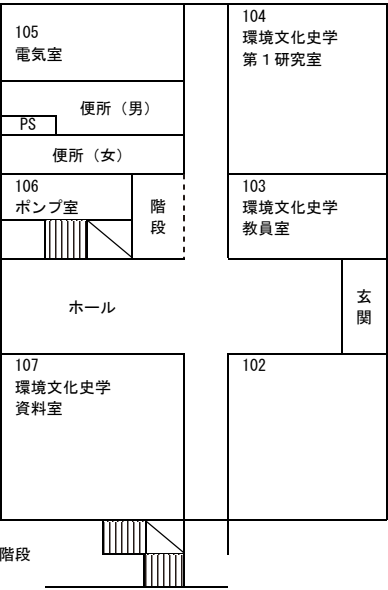

園芸学部B棟

LM

[illegible]

301	風景計画学 第1研究室	302	風景計画 教員室	303	風景計画学 第2研究室	304	地域計画 教員室	305	地域計画 第1研究室	306	地域計画 教員室	307	地域計画 第2研究室	308	リフレック シユナー ナー	309	緑地環境工学 研究室	310	緑地環境工学 教授室	311	経済学科 教員室	312	経済学科 研究室	313	経済学科 教員室	314	経済学科 研究室	315	経済学科 教員室	316. - 317	食料資源経済学科共通 研究室	318	経済学科 教員室	319	経済学科 研究室
-----	----------------	-----	-------------	-----	----------------	-----	-------------	-----	---------------	-----	-------------	-----	---------------	-----	---------------------	-----	---------------	-----	---------------	-----	-------------	-----	-------------	-----	-------------	-----	-------------	-----	-------------	------------	-------------------	-----	-------------	-----	-------------

27

220	遺伝管理 第3 研究室	221	共通 遺伝子 解析室	222	遺伝・育種学 第2研究室	223	植物細胞工学 第1研究室	224	植物細胞工学 植物 培養室	225	成動昆虫 飼育室	226	成動昆虫 養料室	227	応用動物昆虫学 第2研究室	228	植物病学 微生物 培養室	229	植物生理学 第2研究室	230	微生物工学 第1研究室	231	微生物工学 教員室 未知	232	微生物工学 第2研究室	233	環境園師工学 第2研究室	234	経済基礎 花卉細胞学 第4研究室 園分
-----	-------------------	-----	------------------	-----	-----------------	-----	-----------------	-----	---------------------	-----	-------------	-----	-------------	-----	------------------	-----	--------------------	-----	----------------	-----	----------------	-----	--------------------	-----	----------------	-----	-----------------	-----	------------------------------

201	遺伝育種 教員室	菊池
202	遺伝・育種学 第1研究室	佐々
203	遺伝育種 教員室	佐々
204	植物細胞工学 第2研究室	
205	植物細胞学 教員室	中村郁
206	植物細胞学 第3研究室	井川
207	応用動物昆虫学 第1研究室	
208	応動昆 教員室	長
209	応動昆 教員室	野村
210	植物病理学 教員室	穴戸
211	植物病理学 教員室	宇佐見
212	植物病理学 第3研究室	宇佐見
213	植物病理学 第1研究室	
214		
215	微生物工学 第3研究室	
216	環境調節工学 第1研究室	後藤
217	環境調節工学 教員室	彦坂
218	環境調節工学 第3研究室	吉田(英)
219	環境調節工学 教員室	

LE

[illegible]

101	植物生理学 教員室	坂本	102	植物栄養学 第1研究室	103	植物栄養学 第2研究室	104	植物生理学 教員室	105	植物生理学 教員室	106	細胞動物学 教員室	107	土壌学 教員室	108	土質学 教員室	109	土壌学 第1研究室	110	リフレック シュコー ナ一	111	生物資源 利用学 第3研究室	112	生物資源 利用学 第4研究室	113	生物資源 利用学	114	生物資源 教員室	115	生物資源利用学 第1研究室	116	生物資源利用学 第2研究室	117	生物物理学 教員室	118	分子生体 教員室	119	分子生体 機能学 第3研究室
-----	--------------	----	-----	----------------	-----	----------------	-----	--------------	-----	--------------	-----	--------------	-----	------------	-----	------------	-----	--------------	-----	---------------------	-----	----------------------	-----	----------------------	-----	-------------	-----	-------------	-----	------------------	-----	------------------	-----	--------------	-----	-------------	-----	----------------------

## 園芸学部 C棟

4 F

--	--	--	--	--	--	--	--	--	--	--	--	--	--	--	--	--	--	--	--	--	--	--	--	--	--	--	--	--	--	--	--	--	--	--	--	--	--	--	--	--	--	--	--	--	--	--	--	--	--	--	--	--	--	--	--	--	--	--	--	--	--	--	--	--	--	--	--	--	--	--	--	--	--	--	--	--	--	--	--	--	--	--	--	--	--	--	--	--	--	--	--	--	--	--	--	--	--	--	--	--	--	--	--	--	--	--	--	--	--	--	--	--	--	--	--	--	--	--	--	--	--	--	--	--	--	--	--	--	--	--	--	--	--	--	--	--	--	--	--	--	--	--	--	--	--	--	--	--	--	--	--	--	--	--	--	--	--	--	--	--	--	--	--	--	--	--	--	--	--	--	--	--	--	--	--	--	--	--	--	--	--	--	--	--	--	--	--	--	--	--	--	--	--	--	--	--	--	--	--	--	--	--	--	--	--	--	--	--	--	--	--	--	--	--	--	--	--	--	--	--	--	--	--	--	--	--	--	--	--	--	--	--	--	--	--	--	--	--	--	--	--	--	--	--	--	--	--	--	--	--	--	--	--	--	--	--	--	--	--	--	--	--	--	--	--	--	--	--	--	--	--	--	--	--	--	--	--	--	--	--	--	--	--	--	--	--	--	--	--	--	--	--	--	--	--	--	--	--	--	--	--	--	--	--	--	--	--	--	--	--	--	--	--	--	--	--	--	--	--	--	--	--	--	--	--	--	--	--	--	--	--	--	--	--	--	--	--	--	--	--	--	--	--	--	--	--	--	--	--	--	--	--	--	--	--	--	--	--	--	--	--	--	--	--	--	--	--	--	--	--	--	--	--	--	--	--	--	--	--	--	--	--	--	--	--	--	--	--	--	--	--	--	--	--	--	--	--	--	--	--	--	--	--	--	--	--	--	--	--	--	--	--	--	--	--	--	--	--	--	--	--	--	--	--	--	--	--	--	--	--	--	--	--	--	--	--	--	--	--	--	--	--	--	--	--	--	--	--	--	--	--	--	--	--	--	--	--	--	--	--	--	--	--	--	--	--	--	--	--	--	--	--	--	--	--	--	--	--	--	--	--	--	--	--	--	--	--	--	--	--	--	--	--	--	--	--	--	--	--	--	--	--	--	--	--	--	--	--	--	--	--	--	--	--	--	--	--	--	--	--	--	--	--	--	--	--	--	--	--	--	--	--	--	--	--	--	--	--	--	--	--	--	--	--	--	--	--	--	--	--	--	--	--	--	--	--	--	--	--	--	--	--	--	--	--	--	--	--	--	--	--	--	--	--	--	--	--	--	--	--	--	--	--	--	--	--	--	--	--	--	--	--	--	--	--	--	--	--	--	--	--	--	--	--	--	--	--	--	--	--	--	--	--	--	--	--	--	--	--	--	--	--	--	--	--	--	--	--	--	--	--	--	--	--	--	--	--	--	--	--	--	--	--	--	--	--	--	--	--	--	--	--	--	--	--	--	--	--	--	--	--	--	--	--	--	--	--	--	--	--	--	--	--	--	--	--	--	--	--	--	--	--	--	--	--	--	--	--	--	--	--	--	--	--	--	--	--	--	--	--	--	--	--	--	--	--	--	--	--	--	--	--	--	--	--	--	--	--	--	--	--	--	--	--	--	--	--	--	--	--	--	--	--	--	--	--	--	--	--	--	--	--	--	--	--	--	--	--	--	--	--	--	--	--	--	--	--	--	--	--	--	--	--	--	--	--	--	--	--	--	--	--	--	--	--	--	--	--	--	--	--	--	--	--	--	--	--	--	--	--	--	--	--	--	--	--	--	--	--	--	--	--	--	--	--	--	--	--	--	--	--	--	--	--	--	--	--	--	--	--	--	--	--	--	--	--	--	--	--	--	--	--	--	--	--	--	--	--	--	--	--	--	--	--	--	--	--	--	--	--	--	--	--	--	--	--	--	--	--	--	--	--	--	--	--	--	--	--	--	--	--	--	--	--	--	--	--	--	--	--	--	--	--	--	--	--	--	--	--	--	--	--	--	--	--	--	--	--	--	--	--	--	--	--	--	--	--	--	--	--	--	--	--	--	--	--	--	--	--	--	--	--	--	--	--	--	--	--	--	--	--	--	--	--	--	--	--	--	--	--	--	--	--	--	--	--	--	--	--	--	--	--	--	--	--	--	--	--	--	--	--	--	--	--	--	--	--	--	--	--	--	--	--	--	--	--	--	--	--	--	--	--	--	--	--	--	--	--	--	--	--	--	--	--	--	--	--	--	--	--	--	--	--	--	--	--	--	--	--	--	--	--	--	--	--	--	--	--	--	--	--	--	--	--	--	--	--	--	--	--	--	--	--	--	--	--	--	--	--	--	--	--	--	--	--	--	--	--	--	--	--	--	--	--	--	--	--	--	--	--	--	--	--	--	--	--	--	--	--	--	--	--	--	--	--	--	--	--	--	--	--	--	--	--	--	--	--	--	--	--	--	--	--	--	--	--	--	--	--	--	--	--	--	--	--	--	--	--	--	--	--	--	--	--	--	--	--	--	--	--	--	--	--	--	--	--	--	--	--	--	--	--	--	--	--	--	--	--	--	--	--	--	--	--	--	--	--	--	--	--	--	--	--	--	--	--	--	--	--	--	--	--	--	--	--	--	--	--	--	--	--	--	--	--	--	--	--	--	--	--	--	--	--	--	--	--	--	--	--	--	--	--	--	--	--	--	--	--	--	--	--	--	--	--	--	--	--	--	--	--	--	--	--	--	--	--	--	--	--	--	--	--	--	--	--	--	--	--	--	--	--	--	--	--	--	--	--	--	--	--	--	--	--	--	--	--	--	--	--	--	--	--	--	--	--	--	--	--	--	--	--	--	--	--	--	--	--	--	--	--	--	--	--	--	--	--	--	--	--	--	--	--	--	--	--	--	--	--	--	--	--	--	--	--	--	--	--	--	--	--	--	--	--	--	--	--	--	--	--	--	--	--	--	--	--	--	--	--	--	--	--	--	--	--	--	--	--	--	--	--	--	--	--	--	--	--	--	--	--	--	--	--	--	--	--	--	--	--	--	--	--	--	--	--	--	--	--	--	--	--	--	--	--	--	--	--

3 F

[illegible]

2 F

[illegible]

1 F

エレベーター	<div>男子便所</div> <div>女子便所</div> <div>107 食品栄養学 第3研究室</div> <div>108 食品栄養学 第2研究室</div> <div>109 食品栄養学 教員室 平井</div> <div>110 共同研究・実験室 化学系実験室（2）</div>						
	<div>101 分子生体機能学 第1研究室 相馬</div>		<div>102 食品栄養学 第1研究室</div>	<div>103 食品栄養学 教員室 江頭</div>	<div>104 テニユアトラック研究室</div>	<div>105 化学生態学 第1研究室</div>	<div>106 化学生態学 教員室</div>

# 園芸学部D棟

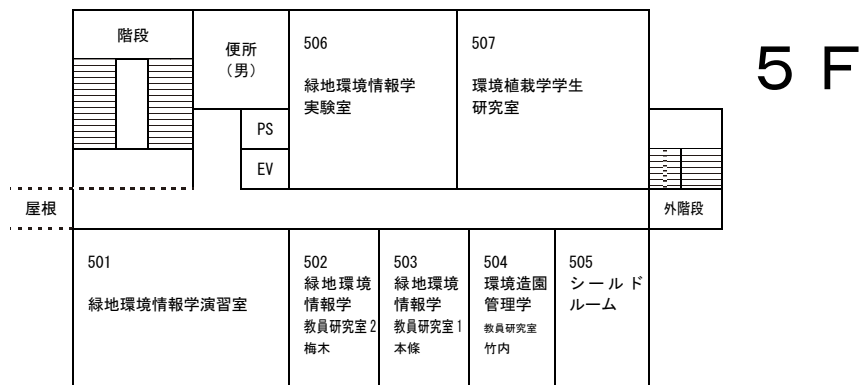

## 4 F

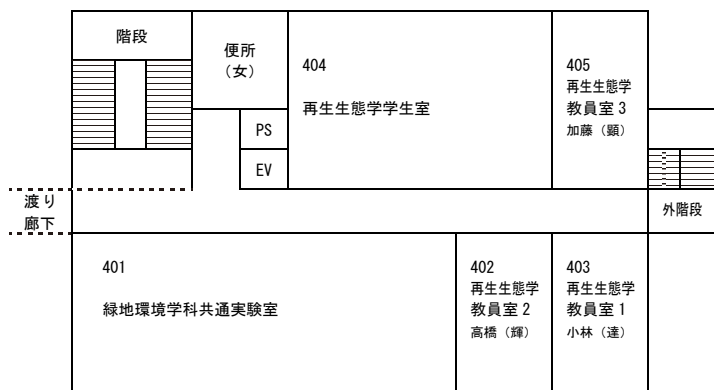

## 3 F

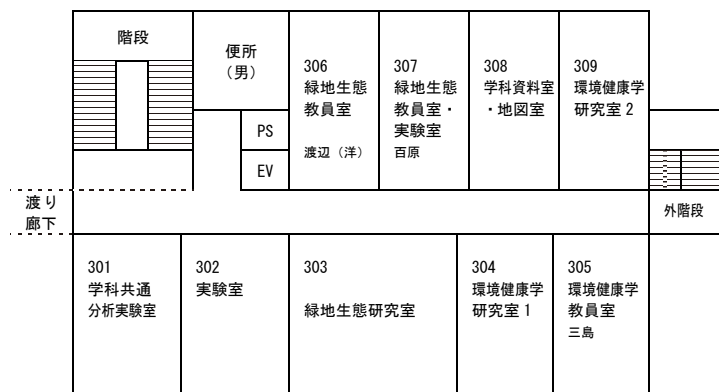

## 2 F

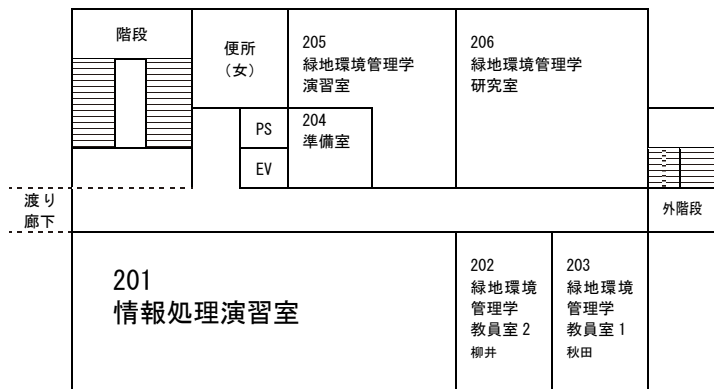

## 1 F

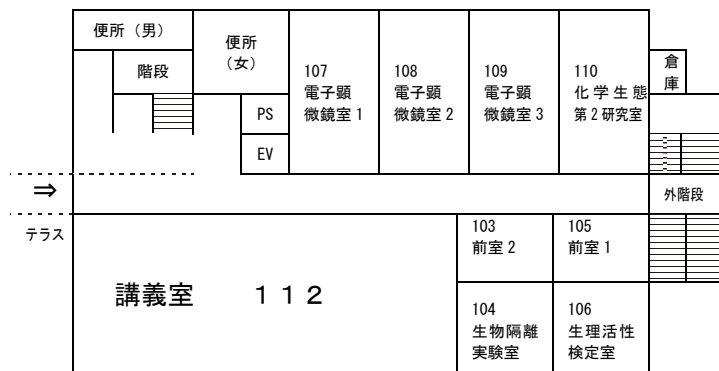

# 園芸学部E棟

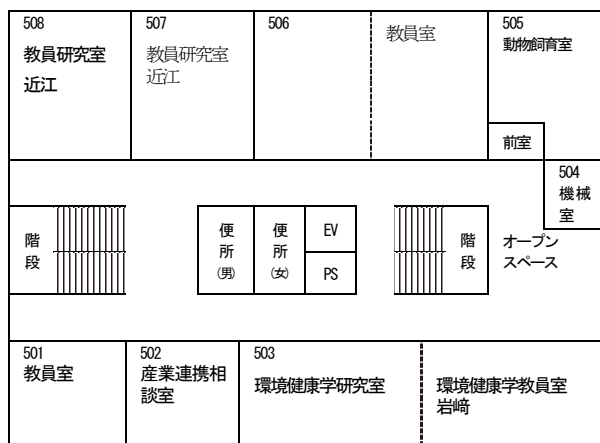

5 F

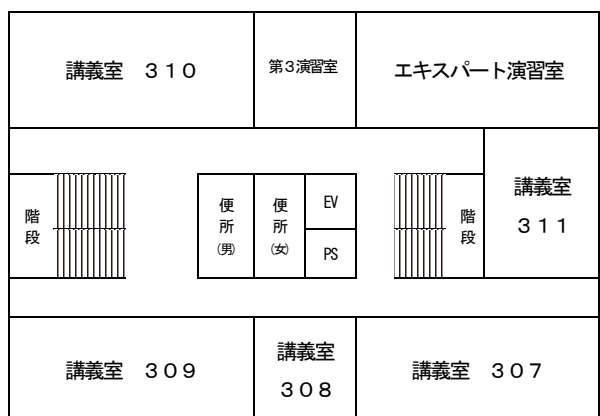

3 F

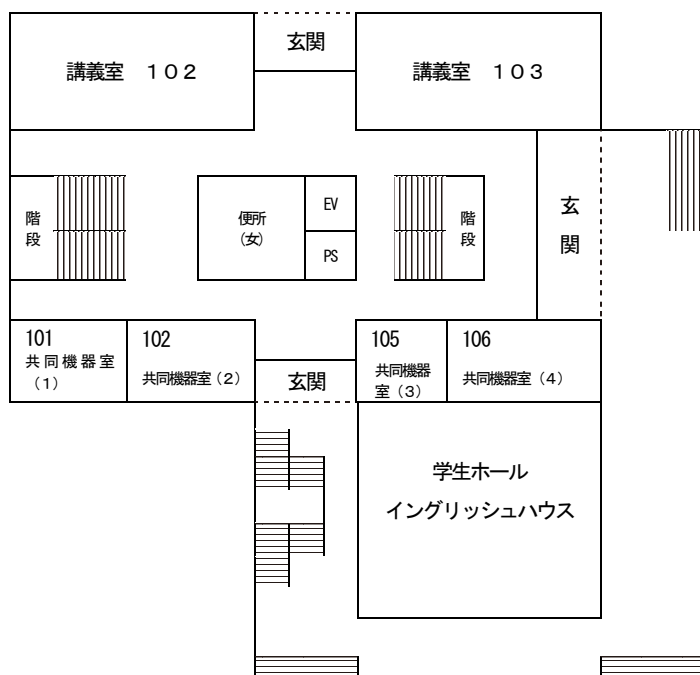
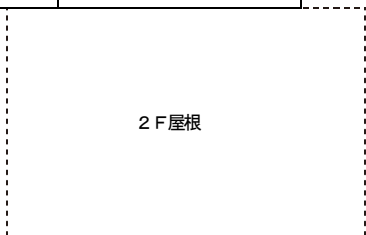

1 F

4 F

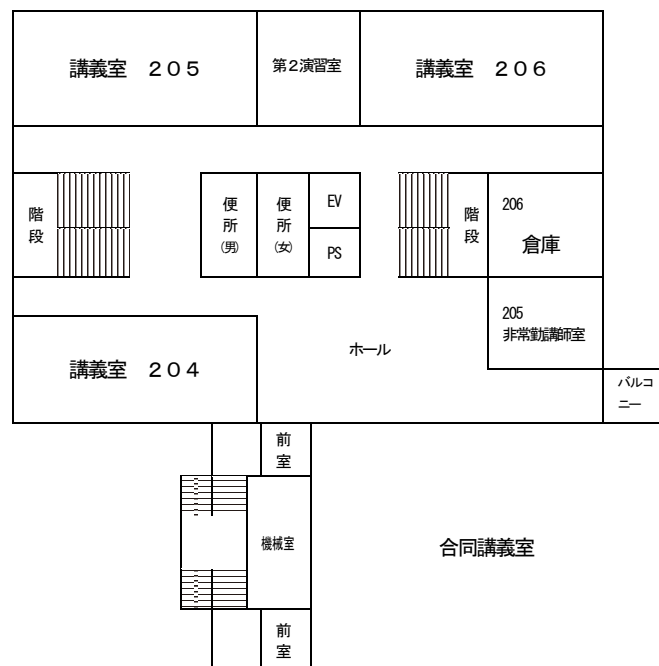
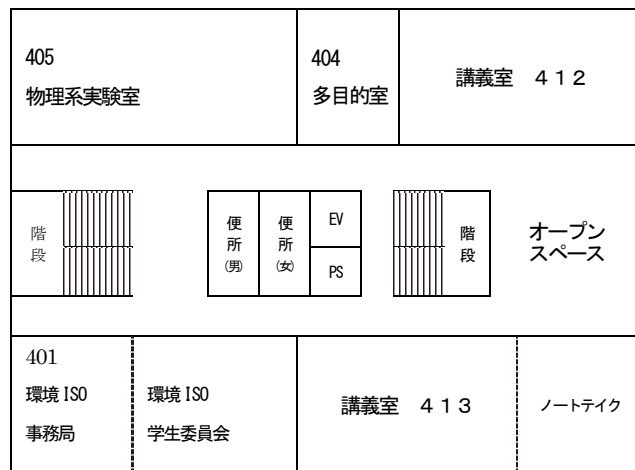

2 F

# 環境健康フイールド科学センター (都市環境園芸農場) 周辺図

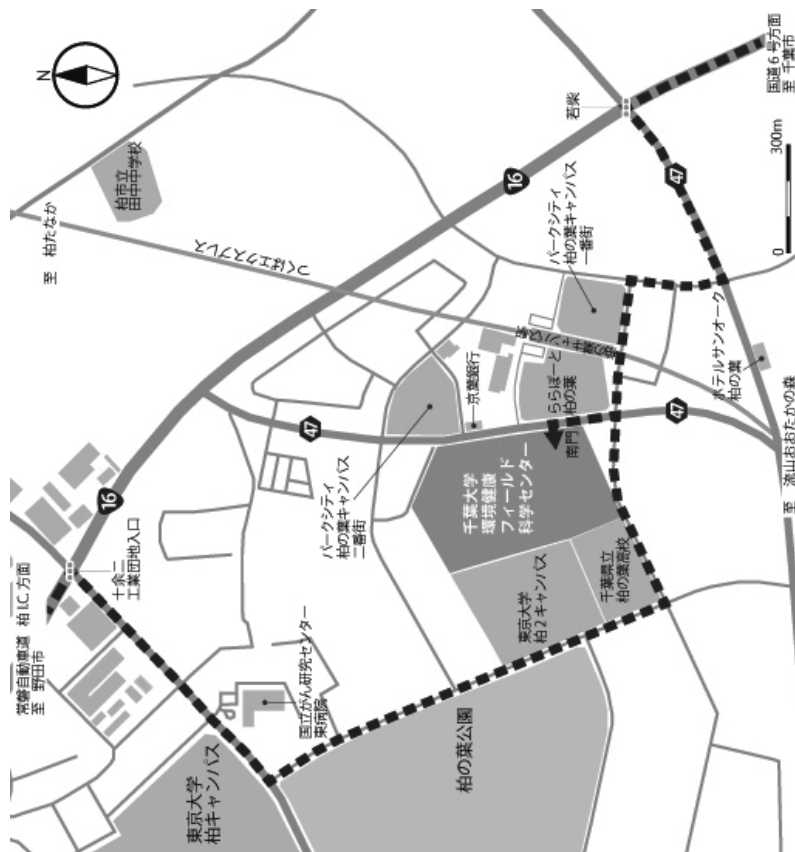

# 環境健康フイールド科学センター (都市環境園芸農場) 配置図

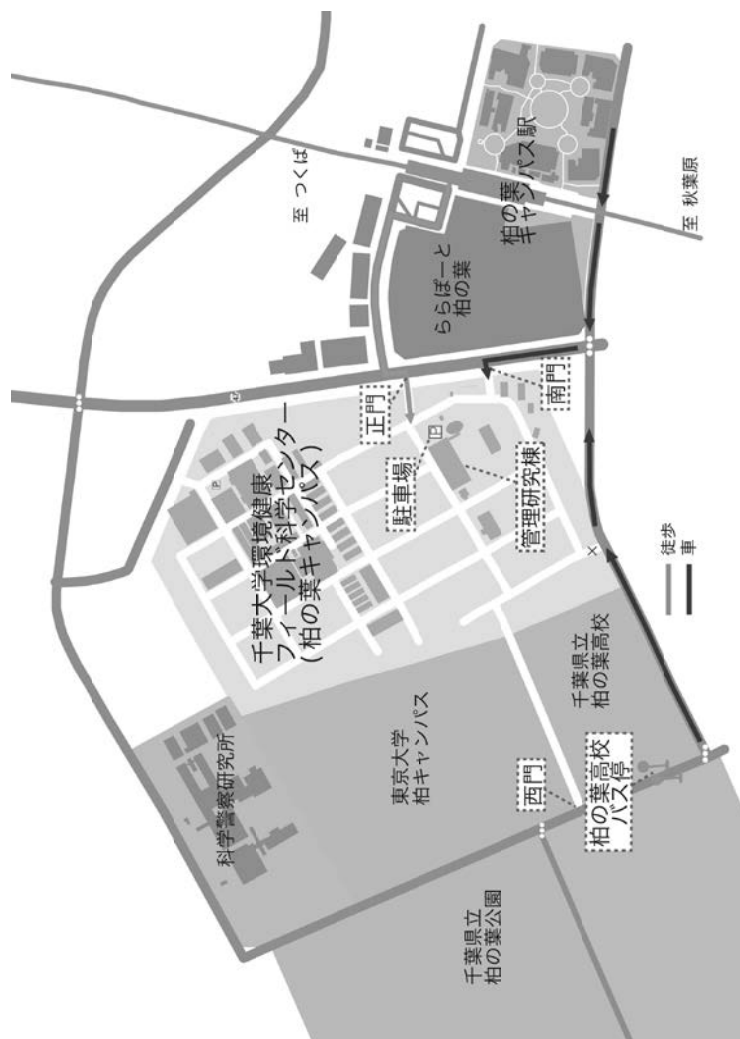

## 交通

つくばエクスプレス「柏の葉キャンパス」駅下車、徒歩5分

東武バスイースト柏駅西口2番乗り場より「国立がんセンター行き」(柏44系, 西柏01系)を利用,

柏の葉高校前(乗車約20分)で下車、徒歩8分

車、バイクの場合は、指定された場所に駐車すること

非常時の連絡先 フイールドセンター総務係 04-7137-8000 (原則として雨天決行)  
更衣室はコインロッカー式. 使用には100円が必要(解錠時に返却されます).

# Center for Environment, Health and Field Sciences Area around the Urban Horticultural Experimental Station

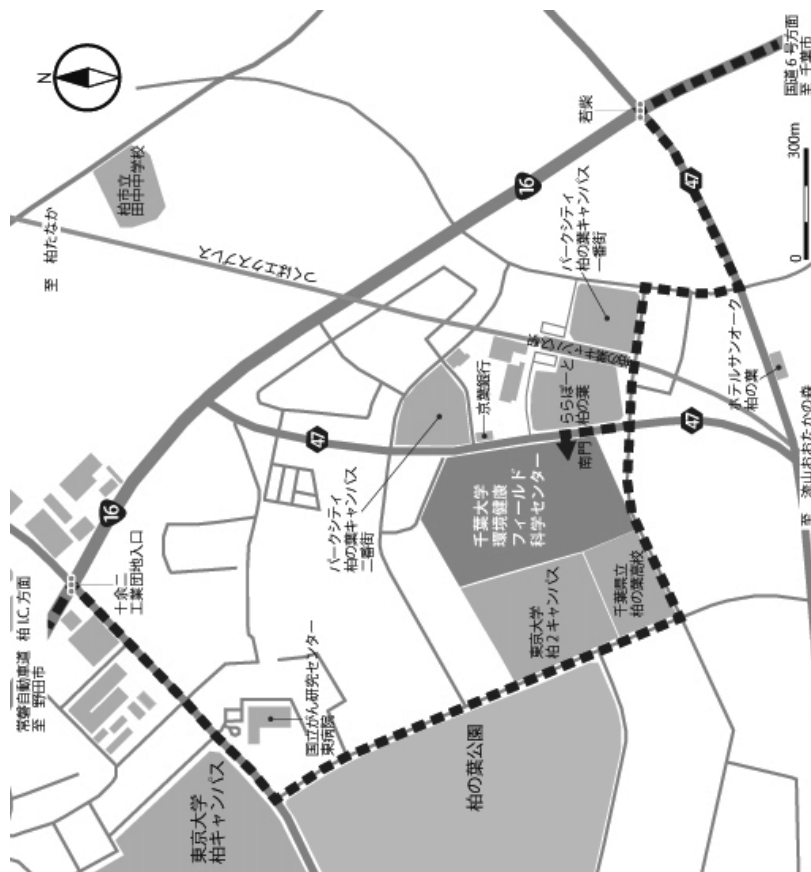

# Center for Environment, Health and Field Sciences Layout of the Urban Horticultural Experimental Station

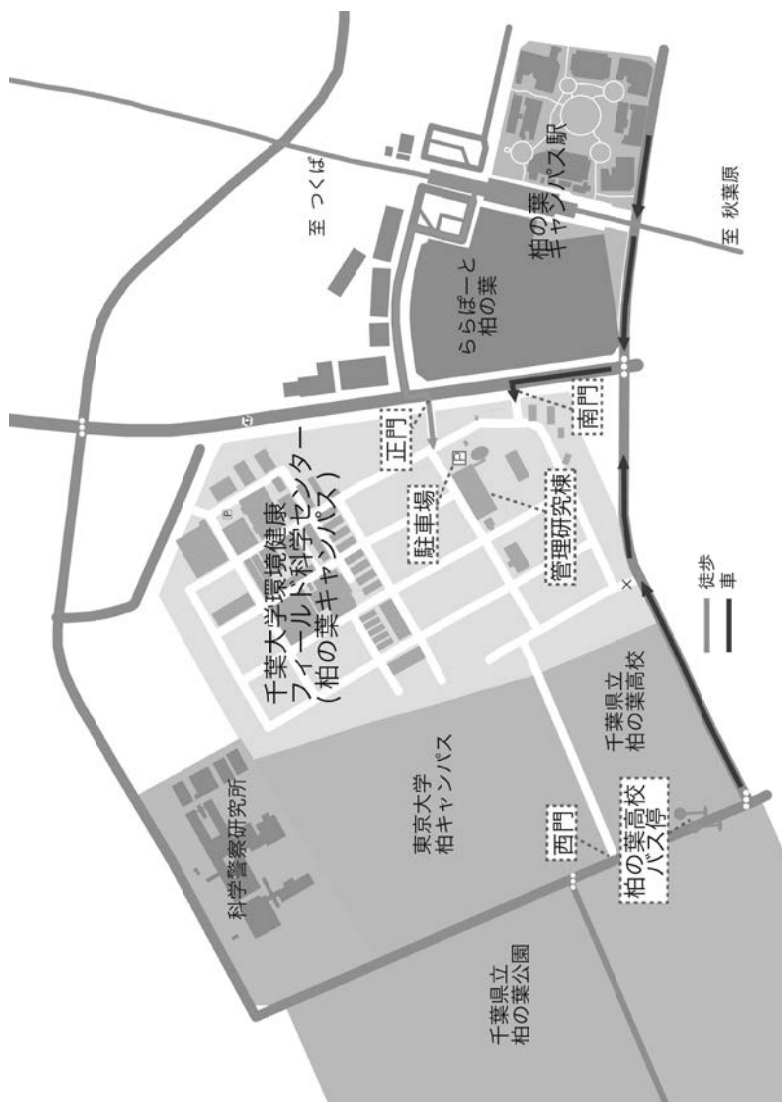

## Access

Take any of the following buses from Bus Stop 2 outside the West Exit of Kashiwa Station: buses going to Kashiwanoha Park; Tobu buses to the National Cancer Center via Kashiwanoha Park; buses to the National Cancer Center via the Customs Training Institute; or buses to the East Exit of Edogawadai Station (every 5~10 minutes all day).

Get off at Kashiwa Nishi Koukou-mae bus stop (~20 min./¥260). People coming by car or motorbike must park in designated areas.

Note: Construction work is currently being undertaken at the Center, so entrances may vary.

In emergencies, please contact the Center's Administrative Section on 04-7137-8000 (In principle, activities are held irrespective of rain.)

Changing rooms have coin lockers. Usage requires ¥100 (returned upon unlocking)

環境健康フィールド科学センター  
(森林環境園芸農場) 周辺図

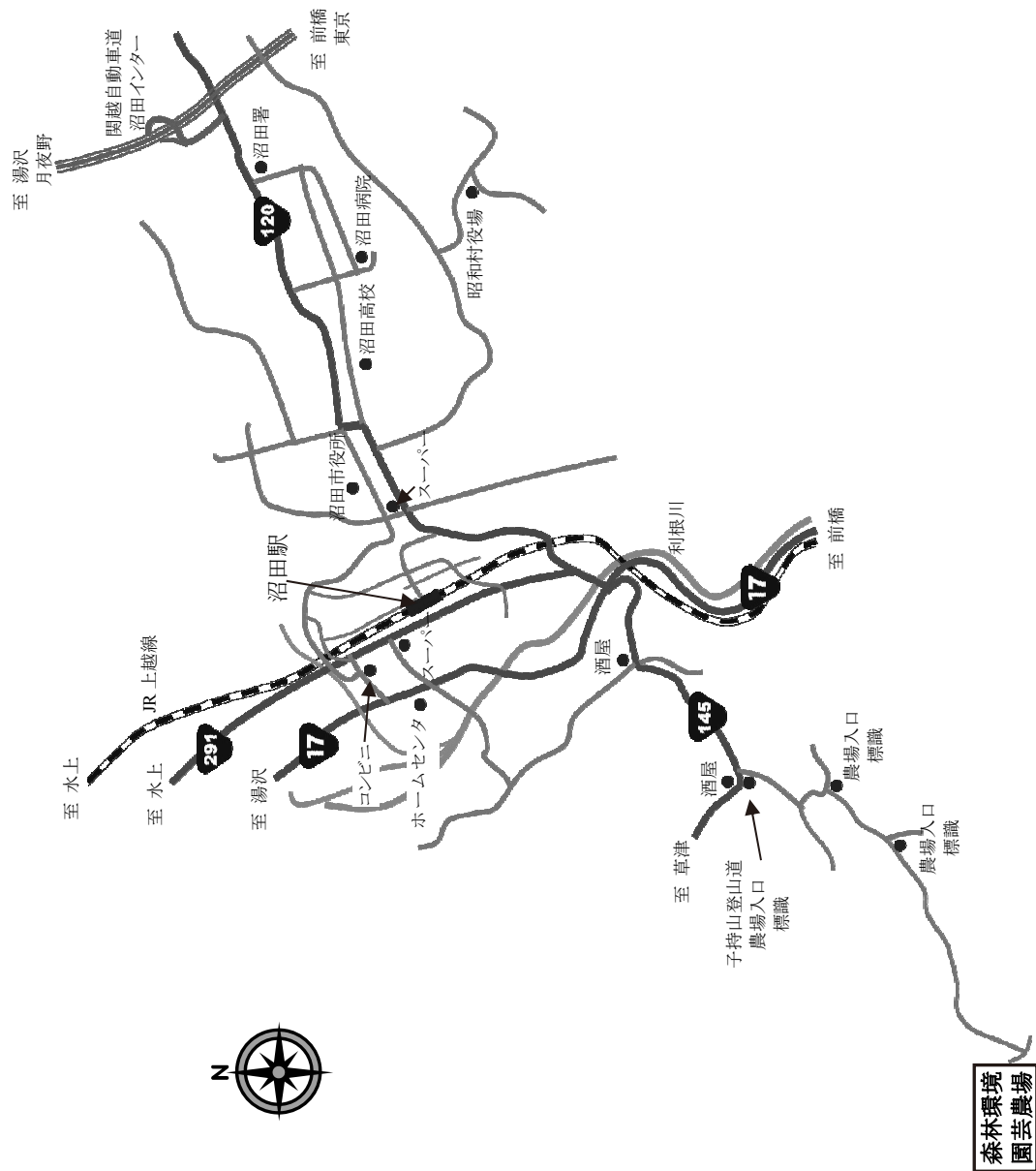

環境健康フィールド科学センター  
(森林環境園芸農場) 配置図

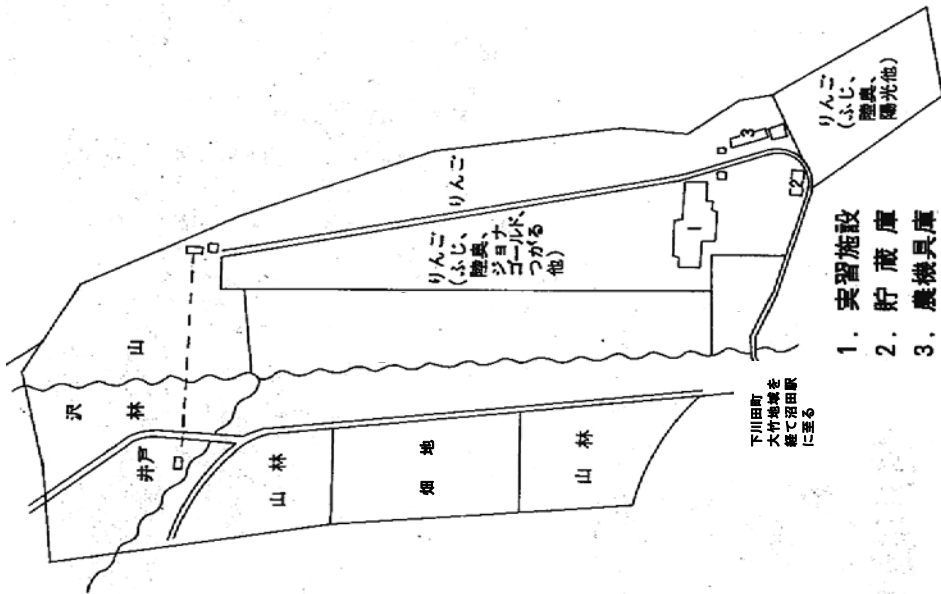

# Center for Environment, Health and Field Sciences Area around the Forestry Horticultural Experimental Station

# Center for Environment, Health and Field Sciences Layout of the Forestry Horticultural Experimental Station

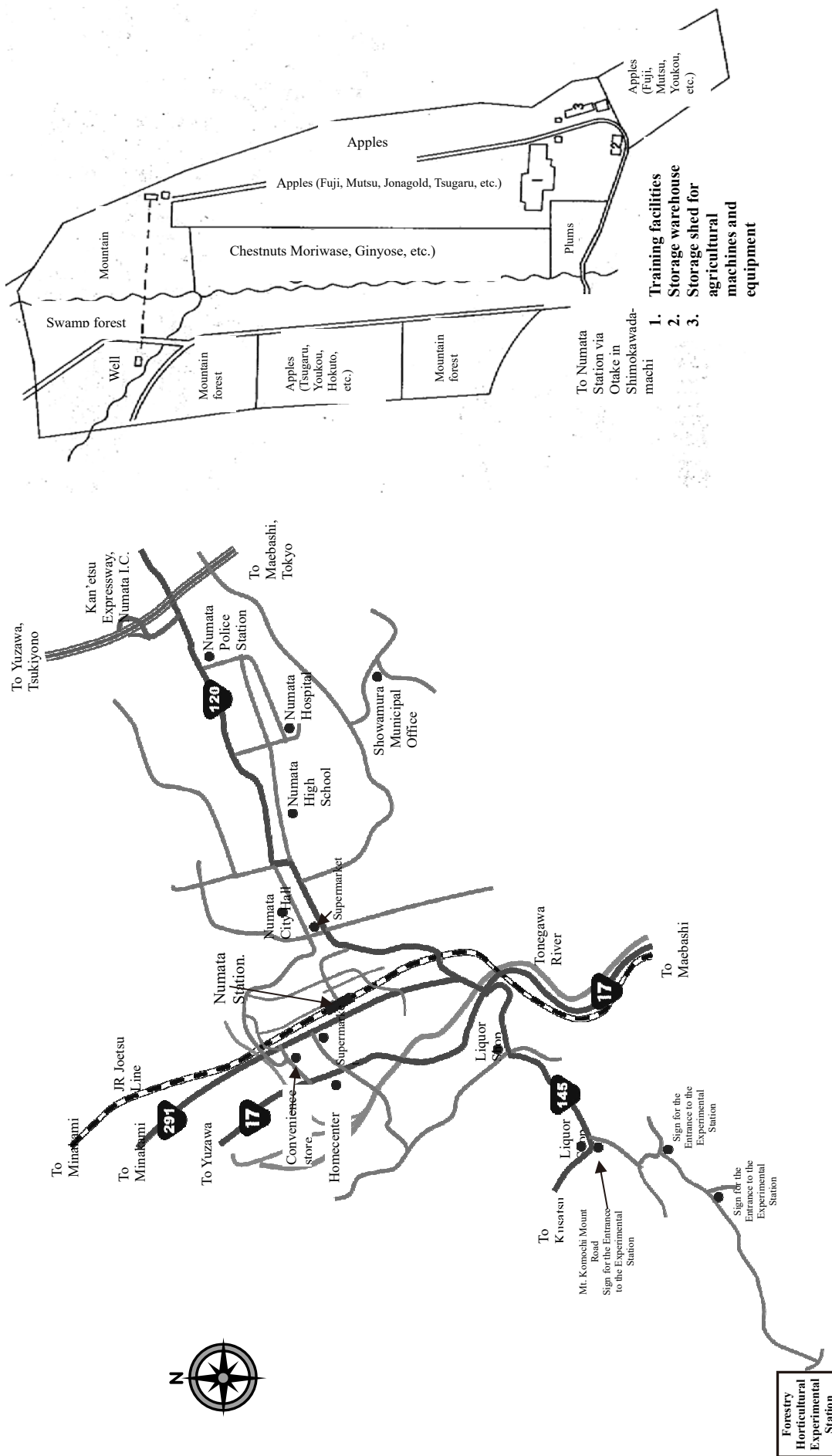

千葉大学大学院園芸学研究科  
Graduate School of Horticulture  
Chiba University

〒271-8510 千葉県松戸市松戸 648  
648 Matsudo, Matsudo-shi, Chiba, 271-8510

園芸学研究科ホームページ Graduate School of Horticulture website  
<http://www.h.chiba-u.jp/>

千葉大学園芸学部学務係 Student Affairs Unit  
電話 Phone : 047-308-8714  
メール E-mail : [engei-daigakuin@office.chiba-u.jp](mailto:engei-daigakuin@office.chiba-u.jp)